

1. Original and/or subsequent record used to evaluate the corner position.
2. Description of evidence found, note discrepancies in the record, state method of establishing lost or obliterated corners.
3. Description of monument and accessories set to perpetuate the corner position.
4. Sketch of corner, show all pertinent data which can best be shown in a sketch example, corner marking, topography ties, position of accessories,
5. Certification must be signed and sealed by Land Surveyor registered in the State of Montana.

CERTIFIED CORNER RECORDATIONCorner: Sec. Cor.; Secs. 27, 28, 33, 34 T. 26N. R. 29W. P.M.M. Lincoln County

GLO 1903 Record: Set limestone. Established 4 bearing trees

BLM Found orig. stone and remains of 2 bearing trees.
1964 Record: Set an iron post, 30" long, 2 1/2" dia., 27" in the ground w/ brass cap, from which:
A 6" pine, bears N30°E, 13 lks (8.6 ft.), marked T26N R29W S27 BT
A 6" pine, bears S52°E, 27 lks (17.8 ft.), marked T26N R29W S34 BT
A 9" pine, bears S69°W, 26 lks (17.2 ft.), marked T26N R29W S33 BT
A 9" pine bears, N12-3/4°W, 18 lks (11.9 ft.), marked T26N R29W S28 BT

2006 Record: Found 3 1/4" BLM brass cap on 2 1/2" iron pipe, 6" above the ground, in a rock mound. From (Staples) which:
A 12" lodgepole pine, bears S52°E, 18.0 ft., scribed T26NR29WS34BT, w/ BT tag "N43°W 17.3 ft. By 4975 12/12/02"
An 11" lodgepole pine, bears N69°E, 28.3 ft., scribed S27BT, w/ BT tag "S61°W 27.3 ft. By 4975"
An 11" Doug. fir, bears, N15°W, 20.5 ft., scribed S28BT, w/ BT tag "S19°E 21.1 ft. By 4975"
16" Doug. fir, bears S53-1/2°W, 55.6 ft., scribed S33BT, w/ BT tag "N57°E 57.8 ft. By 4975 12/12/02"

2009 Found: We find a standard BLM monument with a 3 1/4" brass cap, firmly set, in good condition, rising 14" above the ground, marked as shown below, from which:
An 11" Lodgepole pine, bears N69°E, 28.3ft., with scribing visible.
A 12" Lodgepole pine, bears S53°E, 18.0 ft., with scribing visible.
A 16" Douglas fir, bears S53-1/2°W, 55.6 ft., with scribing visible.
An 11" Douglas fir, bears, N15°W, 20.5 ft., with scribing visible.

Galvanized steel post, bears south and west, 2.0 ft.

2009 Perpetuation: We establish no new reference monuments.
We attach new P54-1 & P71-10 signs on steel post.
We paint red bands on the existing bearing trees, and attached USFS signs 54-3 & 54-9.

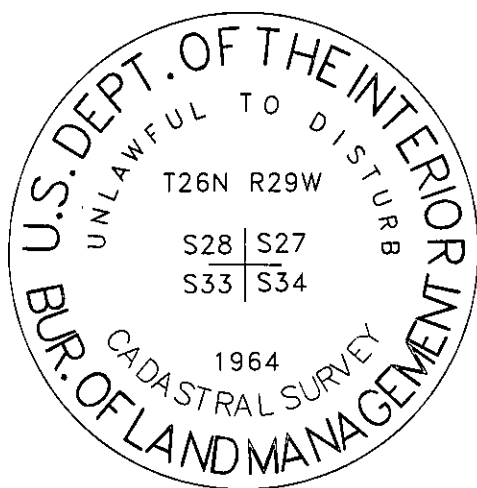
SEE COS NO. 3992**SKETCH OF CORNER****CERTIFICATION**

I, Chad R. Breuer
certify the information shown herein is true and correct.

Signature Ground Party Chief

I, Ken E Jenkins
certify that this Corner Record correctly represents work performed by me or under my direction in compliance with the "Order Recordation Act" (70:22-101 et seq., M.C.A.)

Signature of Surveyor & Seal

Date: 8/2009 Reg. No. 9330 LSEmployer: Montana Northwest Company

PO Box 8777, Missoula, MT 59807

406-721-4033 Project No. 1617-09

Sec. 34

Office of Clerk and Recorder, County of _____ This "corner

record" was filed for record on _____

was noted on the cross-index

book No. _____

224850 BOOK: CCR CC&R'S PAGE: 11476 Pages: 1
STATE OF MONTANA LINCOLN COUNTY
RECORDED: 03/05/2010 9:18 KOI: CC&R'S
TAMMY D. LAUER CLERK AND RECORDER
FEE: \$0.00 BY: [Signature]
TO: MONTANA NORTHWEST COMPANY P.O. BOX 8777, MISSOULA, MONTANA
Cross Index No. V-13 T. 26N R. 29W PMM

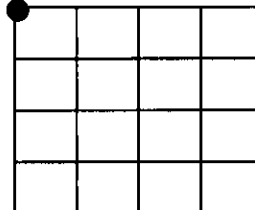

● Corner this sheet