

1. Original and/or subsequent record used to evaluate the corner position.
2. Description of evidence found, note discrepancies in the record, state method of establishing lost or obliterated corners.
3. Description of monument and accessories set to perpetuate the corner position.
4. Sketch of corner, show all pertinent data which can best be shown in a sketch example, corner marking, topography ties, position of accessories,
5. Certification must be signed and sealed by Land Surveyor registered in the State of Montana.

CERTIFIED CORNER RECORDATIONCorner: Section Corner; Secs. 13, 14, 23 & 24 T. 26N. R. 29W. P.M.M. Lincoln County

1903 GLO Record: Set limestone. Established 4 bearing trees.

1964 BLM Record: Found remains of 3 bearing trees.

Set iron post, 30 ins. long, 2 1/2 ins. dia., 27 ins. in the ground, with brass cap, from which:

Original bearing tree:

A 28" stump, bears S85 3/4°E, 45 lks (29.7 ft.), with a burned blaze

A 26" dead, larch, bears S76 1/4°W, 132 lks (87.1 ft.), with burned blaze

A stumphole, bears N57 1/2°W, 84 lks (55.4 ft.)

New bearing trees:

A 5" larch, bears N78°E, 31 lks (20.5 ft.), marked T26N R29W S13 BT

A 5" pine, bears S51°E, 29 lks (19.1 ft.), marked T26N R29W S24 BT

A 9" fir, bears S05°W, 3 lks (2.0 ft.), marked T26N R29W S23 BT

A 9" larch, bears N28°W, 7 lks (4.6 ft.), marked T26N R29W S14 BT

1985 Record:
(Hill)

Found BLM monument protruding 4" above the ground, with brass cap.

A 7" larch, bears N78°E, 30.4 lks (20.1 ft.), with healed face

A 13" fir, bears S05°W, 3 lks (2.0 ft.), with scribing partially visible

A 12" larch, bears N27°W, 7.1 lks (4.7 ft.), with scribing partially visible

New references:

A 14" larch, bears S50°E, 100.7 lks (66.5 ft.), scribed T26N R29W S24 BT

Steel guard post, 3.0 ft., north of corner

2009 Found:

We find a standard BLM monument with a 3 1/4" BLM brass cap, firmly set in good condition, 4" above the ground, marked as shown below, from which:

An 8" larch, bears N78°E, 20.1 ft., with overgrown blaze

A 17" larch, bears S50°E, 66.5 ft., with overgrown blaze

A 16" fir, bears S05°W, 2.0 ft., with overgrown blaze & location tag

A 26" dead, downed larch, bears S78°W, 88.0 ft., scribing not visible

A 14" larch, bears N27°W, 4.7 ft., with overgrown blaze

A 5" pine, bears S51°E, 19.1 ft., with overgrown blaze

Steel post, 0.8 ft., northwest of corner

2009 Perpetuation:

We set a galvanized steel post with USFS decals P54-1 & P71-10, 0.6 ft., west of the monument. We paint red bands on the bearing trees, and attached USFS signs 54-3 & 54-9.

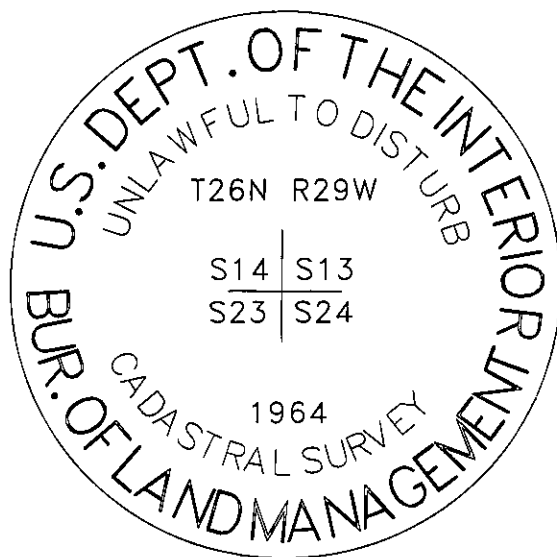
SEE COS NO. 3990**SKETCH OF CORNER****CERTIFICATION**I, Chad R. Breuer

certify the information shown herein is true and correct.

Signature Ground Party Chief

I, Ken E Jenkins

certify that this Corner Record correctly represents work performed by me or under my direction in compliance with the "Corner Recordation Act" (70-22-101 et seq., M.C.A.)

Signature of Surveyor

Date: 9/2009 Reg. No. 9330 LSEmployer: Montana Northwest Company

PO Box 8777, Missoula, MT 59807

406-721-4033 Project No. 1617-09

Sec. 14

Office of Clerk and Recorder, County of _____, This "corner

record" was filed for record on _____

was noted on the cross-index plat

book No. _____

224849 BOOK: CCR CC&R'S PAGE: 11475 Pages: 1
STATE OF MONTANA LINCOLN COUNTY
RECORDED: 03/05/2010 9:17 KOI: CC&R'S
TAMMY D. LAUER CLERK AND RECORDER
FEE: \$0.00 BY: Heather Lauer
TO: MONTANA NORTHWEST COMPANY P.O. BOX 8777, MISSOULA, MONTANA

Cross Index No. N-21 T. 26N R 29W PMM

● Corner this sheet

