

1. Original and/or subsequent record used to evaluate the corner position.
2. Description of evidence found, note discrepancies in the record, state method of establishing lost or obliterated corners.
3. Description of monument and accessories set to perpetuate the corner position.
4. Sketch of corner, show all pertinent data which can best be shown in a sketch example, corner marking, topography ties, position of accessories,
5. Certification must be signed and sealed by Land Surveyor registered in the State of Montana.

**CERTIFIED CORNER RECORDATION**Corner: Section Corner; Secs. 14, 15, 22 & 23 T. 26N. R. 29W. P.M.M. Lincoln County

1903 GLO Record: Set limestone. Established 4 bearing trees.

1964 BLM Record: Found remains of 2 bearing trees.  
Set iron post, 30 ins. long, 2 1/2 ins. dia., 27 ins. in the ground, with brass cap, from which:  
Original bearing trees:  
A decayed stump, bears N12°E, 39 lks (25.7 ft.), GLO Record  
A 40" stump, bears S46-3/4°E, 92 lks (60.7 ft.), with visible marks, GLO Record.  
New bearing trees:  
A 7" larch, bears N7 1/2°E, 44 lks (29.0 ft.), marked T26N R29W S14 BT  
An 8" larch, bears S29°E, 51 lks (33.7 ft.), marked T26N R29W S23 BT  
A 7" larch, bears N45 1/2°W, 58 lks (38.3 ft.), marked T26N R29W S15 BT  
Corner is situated at the intersection of fences extending S & W.

2009 Found: We find a standard BLM monument with a 3 1/4" BLM brass cap, firmly set in good condition, 4" above the ground, marked as shown below, from which:  
An 11" larch, bears N45 1/2°W, 38.3 ft., with an overgrown blaze  
An 11" larch, bears N7 1/2°E, 29.0 ft., with an overgrown blaze  
8" live, larch, bears S29°E, 33.7 ft., with an overgrown blaze

2009 Perpetuation: We set a galvanized steel posts with USFS decals P54+1 & P71-10, 0.5 ft., north and 0.9 ft., east of the monument.  
We paint red bands on the new bearing trees, and attached USFS signs 54-3 & 54-9.

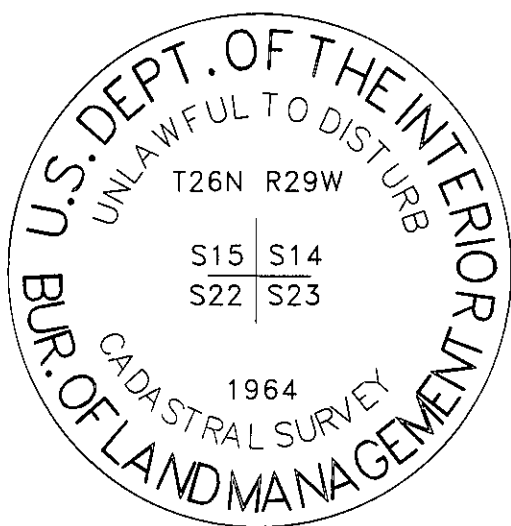
SEE COS NO. 3990**SKETCH OF CORNER****CERTIFICATION**

I, Chad R. Breuer  
certify the information shown herein is true and correct.

Signature Ground Party Chief

I, Ken E Jenkins  
certify that this Corner Record correctly represents work performed by me and in the direction in compliance with the Montana Recordation Act" (70-22-101 et seq., MCA)

Signature of Surveyor &amp; Seal

Date: 9/2009 Reg. No. 9330 LSEmployer: Montana Northwest Company

PO Box 8777, Missoula, MT 59807

406-721-4033 Project No. 1617-09

Office of Clerk and Recorder, County of \_\_\_\_\_ This "corner

record" was filed for record on \_\_\_\_\_

was noted on the cross-index pl \_\_\_\_\_

book No. \_\_\_\_\_

224847 BOOK: CCR CC&amp;R'S PAGE: 11473 Pages: 1

STATE OF MONTANA LINCOLN COUNTY

RECORDED: 03/05/2010 9:15 KOI: CC&amp;R'S

TAMMY D. LAUER CLERK AND RECORDER

FEE: \$0.00

TO: MONTANA NORTHWEST COMPANY P.O. BOX 8777, MISSOULA, MONTANA

Cross Index No. N-17 T. 26N R 29W PMM

Sec. 14

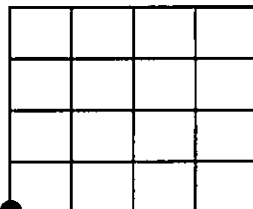

● Corner this sheet