

1. Original and/or subsequent record used to evaluate the corner position.
2. Description of evidence found, note discrepancies in the record, state method of establishing lost or obliterated corners.
3. Description of monument and accessories set to perpetuate the corner position.
4. Sketch of corner, show all pertinent data which can best be shown in a sketch example, corner marking, topography ties, position of accessories,
5. Certification must be signed and sealed by Land Surveyor registered in the State of Montana.

**CERTIFIED CORNER RECORDATION**Corner: 1/4 Corner; Secs. 11 & 14T. 26N.R. 29W. P.M.M. Lincoln County

1903 GLO Record: Set sandstone &amp; established 2 bearing trees

1964 BLM Record: Found orig. stone and remains of 1 bearing tree  
Set iron post, 30 ins. long, 2 1/2" dia., 27 ins. in the ground with brass cap, from which:  
Original bearing trees:  
A dead fir, 16 ins. diam., bears N17 3/4°W, 31 lks (20.5 ft.), marked 1/4S11BT  
New bearing trees:  
A fir, 6 ins. diam., bears N24°E, 35 lks (23.1 ft.), marked 1/4 S11 BT  
A fir, 8 ins. diam., bears S13°W, 31 lks (20.5 ft.), marked 1/4 S14 BT  
Buried orig. stone alongside of the iron post.

2005 Record: Found 3 1/4" BLM brass cap, firmly set, 6" above the ground, from which:  
(Hughes) A fir snag, bears N24°E, 23.1 ft., no visible scribing  
A 12" fir, bears S13°W, 20.5 ft., with visible scribing  
A 16" fir snag, downed, bears N18°W, 20.5 ft., with visible scribing  
New bearing tree:  
A 9" larch, bears N21°W, 36.0 ft., marked 1/4 S11 BT  
Set steel post, 2.0 ft. east of monument

2009 Found: We find a standard BLM monument with a 3 1/4" brass cap, firmly set and in good condition,  
rising 8" above the ground, marked as shown below, from which:  
A 14" fir, bears S13°W, 20.5 ft., with partially visible scribing & BT tag "KSI 02-05"  
A 10" larch, bears N26°W, 36.0 ft., with visible scribing & BT tag "S21°E KSI 02-05"  
A 16" fir stump, bears N20°W, 22.1 ft., with no visible scribing

2009 Perpetuation: We set a galvanized steel fence post 0.7 ft. east of the monument  
We attach new P54-1 & P71-10 signs on steel post.  
We paint red bands on the existing bearing trees, and attached USFS signs 54-3 & 54-9.  
We create a larger mound of stone around the monument.

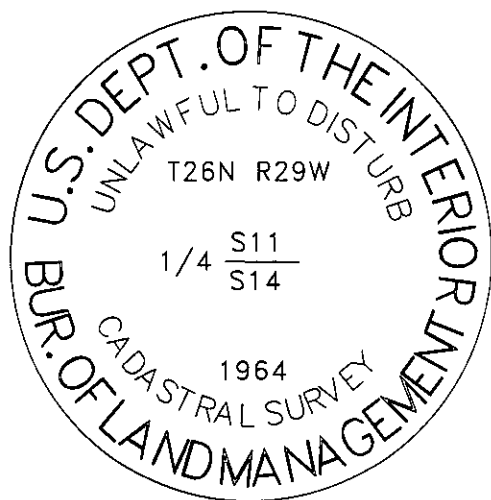
SEE COS NO. 3990**SKETCH OF CORNER****CERTIFICATION**

I, Chad R. Breuer  
certify the information shown herein is true and correct.

Chad R. Breuer  
Signature Ground Party Chief

I, Ken E Jenkins  
certify that this Corner Record correctly  
represents work performed by me or under my  
direction in compliance with the "Corner  
Recordation Act" (70-22-101, et seq., M.C.A.)

Ken E Jenkins  
Signature of Surveyor & Seal of State

Date: 9/2009 Reg. No. 93304LS

Employer: Montana Northwest Company

PO Box 8777, Missoula, MT 59807

406-721-4033 Project No. 1617-09

Office of Clerk and Recorder, County of \_\_\_\_\_ This "corner

record" was filed for rec 224838 BOOK: CCR CC&amp;R'S PAGE: 11464 Pages: 1

was noted on the cross-i STATE OF MONTANA LINCOLN COUNTY

book No. \_\_\_\_\_ TAMMY D. LAUER CLERK AND RECORDER

FEE: \$0.00

BY: Deanna K. Smith

TO: MONTANA NORTHWEST COMPANY P.O. BOX 8777, MISSOULA, MONTANA

Cross Index No.

J-19 T. 26N R. 29W PMM

Sec. 14

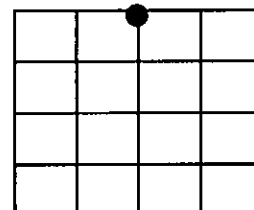

● Corner this sheet