

1. Original and/or subsequent record used to evaluate the corner position.
2. Description of evidence found, note discrepancies in the record, state method of establishing lost or obliterated corners.
3. Description of monument and accessories set to perpetuate the corner position.
4. Sketch of corner, show all pertinent data which can best be shown in a sketch example, corner marking, topography ties, position of accessories,
5. Certification must be signed and sealed by Land Surveyor registered in the State of Montana.

CERTIFIED CORNER RECORDATION

Corner: Section Corner: Secs. 10, 11, 14 & 15 T. 26N. R. 29W. P.M.M. Lincoln County
1903 GLO Record: Set sandstone. Established 4 bearing trees.

1964 BLM Record: Found stone & remains of 2 bearing trees.
Set iron post, 30" long, 2 1/2" dia., 27" in the ground, with brass cap; from which:
Original bearing trees:
A dead larch, 8 ins. diam., bears S08°W, 26 lks (17.2 ft.), marked T26N R29W S15 BT
A dead, larch, 10 ins. diam., bears N30°W, 39 lks (25.7 ft.), marked T26N R29W S10 BT

New bearing trees:
A larch, 6 ins. diam., bears N75°E, 33 lks (21.8 ft.), marked T26N R29W S11 BT
A larch, 7 ins. diam., bears S42°E, 41 lks (27.1 ft.), marked T26N R29W S14 BT
A larch, 6 ins. diam., bears S30°W, 30 lks (19.8 ft.), marked T26N R29W S15 BT
A pine 6 ins. diam, bears N24 1/2°W, 20 lks (13.2 ft.), marked T26N R29W S10 BT

2005 Record: Found 3-1/4" BLM brass cap, firmly set, 6" above the ground with rock collar.
(Hughes)

A larch, 9 ins. diam., bears N75°E, 17.2 ft., with visible scribes
A larch, 13 ins. diam., bears S42°E, 27.1 ft., with visible face
A larch, 9 ins. diam., bears S30°W, 19.8 ft., with visible face
A pine, 9 ins. diam., bears N24°W, 13.2 ft., with visible scribes
Set steel post 3.0 ft., east of corner

2009 Found: We find a standard BLM monument with a 3 1/4" BLM brass cap, firmly set in good condition, 6" above the ground, marked as shown below, from which:

A 10" larch, bears N75°E, 21.7 ft., with overgrown blaze & BT tag "KSI '05"
A 14" larch, bears S42°E, 27.1 ft., with overgrown blaze & BT tag "N42°W 19.8' KSI '05"
A 10" larch, bears S30°W, 19.8 ft., with overgrown blaze & BT tag "N30°E 19.8' KSI '05"
A 10" Lodgepole pine, bears N24°W, 13.2 ft., with visible scribing & BT tag "S24°30'E 13.2 KSI '05"

2"X 18" PVC pipe on ground near monument containing "Notice of mining location" Bk 207 Pg 377"

2009 Perpetuation: We set a galvanized steel posts with USFS decals P54-1 & P71-10, 0.5 ft., east and 0.7 ft., south of the monument.
We paint red bands on the new bearing trees, and attached USFS signs 54-3 & 54-9.
SEE COS NO. 3990

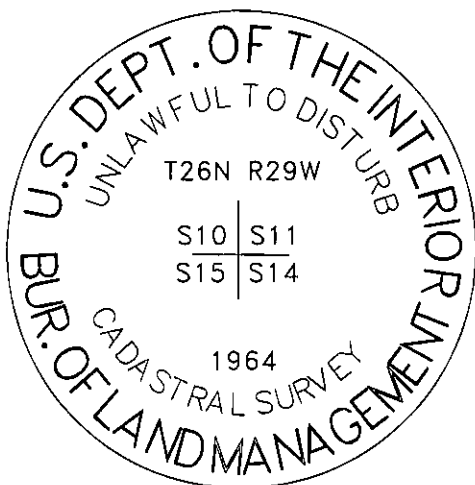

SKETCH OF CORNER

CERTIFICATION

I, Chad R. Breuer
certify the information shown herein is true and correct.

Chad R. Breuer
Signature Ground Party Chief

I, Ken E Jenkins
certify that this Corner Record, correctly represents work performed by me or under my direction in compliance with the "Corner Recordation Act" (70-22-101, et seq., M.C.A.)

Ken E Jenkins
Signature of Surveyor & Sealer

Date: 9/2009 Reg. No. 9330 LS

Employer: Montana Northwest Company
PO Box 8777, Missoula, MT 59807
406-721-4033 Project No. 1617-09

Office of Clerk and Recorder, County of _____ This "corner

record" was filed for record r 224837 BOOK: CCR CC&R'S PAGE: 11463 Pages: 1

was noted on the cross-index STATE OF MONTANA LINCOLN COUNTY
RECORDED: 03/05/2010 9:06 KOI: CC&R'S

book No. TAMMY D. LAUER CLERK AND RECORDER

FEE: \$0.00

BY:

TO: MONTANA NORTHWEST COMPANY P.O. BOX 8777, MISSOULA, MONTANA

Cross Index No. J-17 T. 26N R 29W PMM

Sec. 14

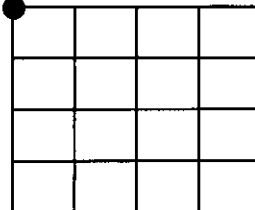

● Corner this sheet