

INSTRUCTIONS

1. Original and/or subsequent record used to evaluate the corner position.
2. Description of evidence found, note discrepancies in the record, state method of establishing lost or obliterated corners.
3. Description of monument and accessories set to perpetuate the corner position.
4. Sketch of corner, show all pertinent data which can best be shown in a sketch example, corner marking, topography ties, position of accessories, etc.
5. Certification must be signed and sealed by Land Surveyor registered in the State of Montana.
6. Fill in Cross Index & Section Diagram at bottom of sheet.

CERTIFIED CORNER RECORDATION

Corner NE Cor. Sec. 33 T. 26 North R. 29 West P.M.M. Lincoln County

Original G.L.O. Record:

Set a limestone, 12x10x5 inches, 8 inches in the ground, for corners of Sections 27, 28, 33, and 34, marked with 1 notch on South and 3 notches on East edge; from which:
 A 6" fir, bears N47°50'E, 14 links (9.24 feet) distant, marked "T26N R29W S27 BT".
 An 8" tamarack, bears S70°45'E, 9 links (5.94 feet) distant, marked "T26N R29W S34 BT".
 An 8" pine, bears S23°50'W, 29 links (19.14 feet) distant, marked "T26N R29W S33 BT".
 An 8" pine, bears N26°W, 96 links (63.36 feet) distant, marked "T26N R29W S28 BT".

Re-monument:

The corner of Sections 27, 28, 33, and 34, monumented with a limestone, 12x10x5 inches, firmly set and marked with 3 grooves on the East and 1 groove on the South faces, and witnessed by the remains of two of the original bearing trees.

At the corner point:

Set an iron post, 30 ins. long, 2 1/2 ins. diam., 27 ins. in the ground, with brass cap marked as shown below.
 from which:

The remains of the original bearing trees:

- A stumphole, bears N48° E., 14 links distant (Record: N47°50'E, 14 links)
- A stumphole, bears S70 3/4° E, 9 links distant (Record)

The new bearing trees:

- A 6" pine, bears N30°E, 13 links (8.58 feet) distant, marked "T26N R29W S27 BT".
- A 6" pine, bears S52°E., 27 links (17.82 feet) distant, marked "T26N R29W S34 BT".
- A 9" pine, bears S69°W, 26 links (17.16 feet) distant, marked "T26N R29W S33 BT".
- A 9" pine, bears N12 3/4° W, 18 links (11.88 feet) distant, marked "T26N R29W S28 BT".

Found:

Found 3 1/4" brass cap on 2 1/2" diam. pipe, 6" above ground in a rock mound. From which:

- A 12" lodgepole pine, bears S52°E, 18.0 ft. distant, scribed "T26N R29W S34 BT" with a BT tag: "N43W 17.30 ft. BY: 4975 12/12/02"
- An 11" lodgepole pine, bears N69°E, 28.3 ft. distant, scribed "S27 BT" with a BT tag: "S61°W, 27.30ft BY: 4975
- An 11" Doug. fir, bears N15°W, 20.5 ft. distant, scribed "S28 BT" with a BT tag: "S19°E, 21.10 ft. BY: 4975
- A 16" Doug. fir, bears S53 1/2°W, 55.6 ft. distant, scribed "S33 BT" with a BT tag: "N57°E, 57.80ft BY:4975 12/02/02

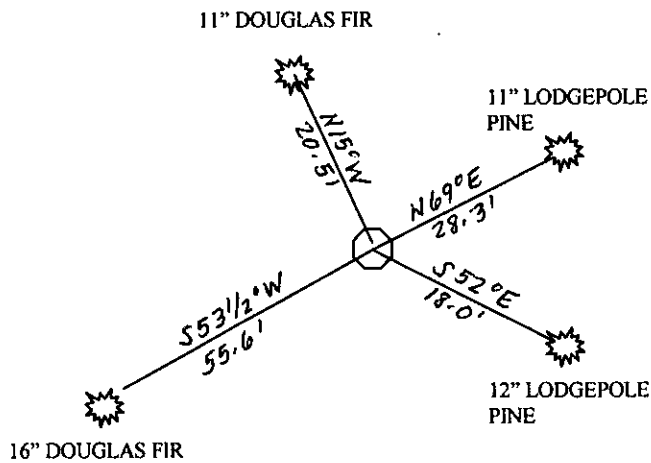
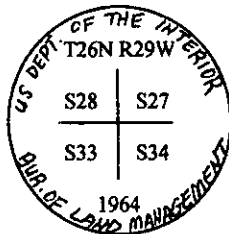

SKETCH OF CORNER

CERTIFICATION

I, James R. Staples
 Certify the information shown herein is true and correct.

James R. Staples
 Signature Ground Party Chief

I, James R. Staples
 certify that this Corner Record correctly represents work performed by me or under my direction in compliance with the "Corner Recordation Act" (70-22-101, et seq., M.C.A.)

James R. Staples
 Signature of Surveyor & Seal

Date: 12/1/06 Reg. No. 9958 LS

Employer: J.R.S. Surveying, Inc.

Office of Clerk and Recorder, County of _____ This "corner
 record" was filed for record on _____ 199349 BOOK: CCR CC&R'S PAGE: 10957 Pages: 1
 was noted on the cross-index plat an _____ STATE OF MONTANA LINCOLN COUNTY
 book no. _____ CORAL M. CUMMINGS CLERK AND RECORDER
 FEE: \$0.00 BY: *Jennifer Stewart*
 TO: FILED _____ Deputy
 _____ County Official

		33	

Cross Index No. V13 T. 26N R. 29W PMM