

INSTRUCTIONS

1. Original and/or subsequent record used to evaluate the corner position.
2. Description of evidence found, note discrepancies in the record, state method of establishing lost or obliterated corners.
3. Description of monument and accessories set to perpetuate the corner position.
4. Sketch of corner, show all pertinent data which can best be shown in a sketch example, corner marking, topography ties, position of accessories, etc.
5. Certification must be signed and sealed by Land Surveyor registered in the State of Montana.
6. Fill in Cross Index & Section Diagram at bottom of sheet.

CERTIFIED CORNER RECORDATION

Corner NW Cor. Sec. 33 T. 26 North R. 29 West P.M.M. Lincoln County

1903 Original Record – Charles H. Albee & William K. Trippett

Set a sandstone 14x12x4 inches, 10" in the ground for corner of Sections 28, 29, 32, and 33 marked with 1 notch on south and 4 notches on east edges; from which:

- A 30" Pine, bears N59°E, 40 links (26.4 feet) distant, marked T26N R29W S28 BT.
An 18" Tamarack, bears S51°E, 78 links (51.88 feet) distant, marked T26N R29W S33 BT.
A 20" Pine, bears S17°15'W, 68 links (44.88 feet) distant, marked T26N R29W S32 BT.
A 24" Pine, bears N68°30'W, 80 links (52.8 feet) distant, marked T26N R29W S29 BT.

Re-monument - 1978

The corner of Sections 28, 29, 32, and 33 as determined by the remains of the original bearing trees.
At the corner point, set an iron post, 30" long, 2.5" diameter, 24" in the ground with brass cap, marked as shown below; from which:

- A 30" Pine, bears N59°E, 40 links (26.4 feet) distant, marked T26N R29W S28 BT.
A 25" Larch, bears S51°E, 78 links (51.48 feet) distant, marked with overgrown blaze.
A 31" Pine, bears S17¼°W, 68 links (44.88 feet) distant, marked T26N R29W S32 BT.
A dead 26" Pine, bears N68½°W, 80 links (52.8 feet) distant, marked T26N R29W S29 BT.
An 8" Fir, bears N6°W, 31 links (20.46 feet) distant, marked T26N R29W S29 BT.

Found:

Found 3¼" BLM brass cap on 2¼" galvanized pipe marked as shown below, 0.2 feet above ground, from which:

- A 36" Ponderosa Pine with visible scribing with attached BT tag S15¾°W, 42.58 feet distant.
A 30" Tamarack, with healed blaze and attached BT tag S52°E, 49.5 feet distant.
A 35" Ponderosa Pine with visible scribe and attached BT tag N58½°E, 24.86 feet distant.
A 13" Douglas Fir with healed blaze and attached BT tag N9¼°W, 20.22 feet distant.

Attached new bearing tree tags and paint blaze red.

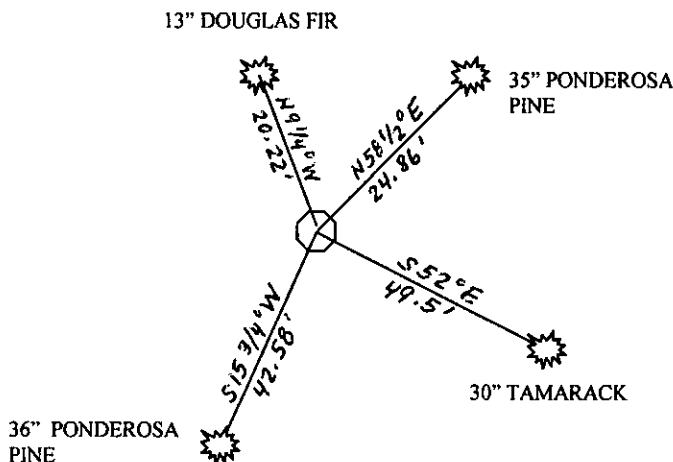
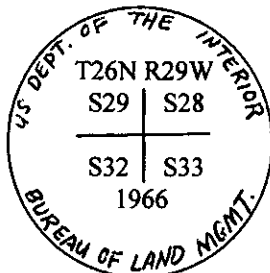

SKETCH OF CORNER

CERTIFICATION

I, James R. Staples
Certify the information shown herein is true and correct.

Signature Ground Party Chief

I, James R. Staples
certify that this Corner Record correctly represents work performed by me or under my direction in compliance with the the "Corner Recordation Act" (70-22-101, et seq., M.C.A.)

Signature of Surveyor & Seal

Date: _____ Reg. No. 9958 LS

Employer: J.R.S. Surveying, Inc.

Office of Clerk and Recorder 199345 BOOK: CCR CC&R'S PAGE: 10953 Pages: 1
record" was filed for record STATE OF MONTANA LINCOLN COUNTY
was noted on the cross-index RECORDED: 12/05/2006 9:50 KOI: CC&R'S
book no. CORAL M. CUMMINGS CLERK AND RECORDER
FEE: \$0.00 BY: Glennie Davis
TO: FILED Deputy

County Official

Cross Index No. V9 T. 26N R. 29W PMM

