

**-CERTIFIED CORNER RECORDATION**

Corner    Sec. Cor.    Secs.    13,18,19,24    T.    26N    R.    29W    P.M., MT    Lincoln    County

- I.    1898 G.L.O. Record by Charles H. Albee et. al.: Set a limestone, 16x12x10 ins., 14 ins. in the ground, for cor. of secs. 13,18,19 and 24, mkd. with 3 notches, each on S. and N edges.

Established four bearing trees:

A tamarack, 12 ins. diam., bears N09°45'E, 32 lks. dist., mkd. "T26N R28W S18 BT".  
A tamarack, 12 ins. diam., bears S30°30'E, 42 lks. dist., mkd. "T26N R28W S19 BT".  
A fir, 10 ins. diam., bears S73°15'W, 84 lks. dist., mkd. "T26N R29W S24 BT".  
A fir, 14 ins. diam., bears N76°15'W, 76 lks. dist., mkd. T26N R29W S13 BT".

1985 Certified Corner Recordation by Thomas C. Hill, 5612S: Found stone, 14x11x10 ins., 5 ins. above the ground, firmly set and mkd. with 3 notches on S. face and witnessed by the original bearing trees. At the position of the stone, set an aluminum post, 30 ins. long 2 1/2 in. diam., 30 ins. in the ground with an aluminum cap mkd. as shown.

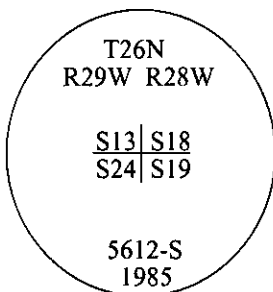

Established four new bearing trees and buried the original stone alongside the aluminum post. Set a steel guard post, South, 2.0 ft. dist. of the corner, with a Land Survey Marker decal attached.

- II.    Found a 2 1/2 in. diam. aluminum pipe, firmly set, protruding 1 in. above the ground, with a 3 1/4 in. diam. aluminum cap, mkd. as shown.

- III.    Established one new bearing tree:

A white pine, 9 ins. diam., bears N17°W, 23.4 ft. dist., mkd. "T26N R29W S13 BT".

Painted bearing trees and attached Land Survey Monument and Bearing Tree signs.

Magnetic Declination: 20° East

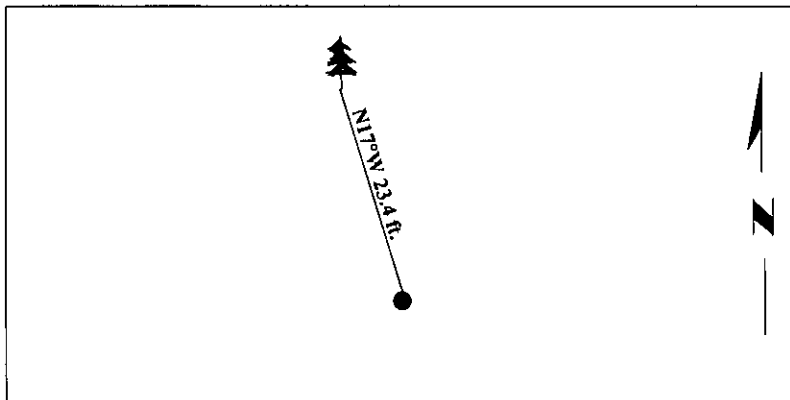

**SKETCH OF CORNER**

CERTIFICATION	
I. <u>Thomas M. Hommel</u>	certify the information shown herein is true and correct.
I. <u>Steven A. Boyer</u>	certify that this Corner Record correctly represents work performed by me or under my direction in compliance with the "Corner Recordation Act" (70-22-101, et seq., M.C.A.)
Date: <u>4/22/98</u>	Signature of Surveyor & Seal <u>9750LS</u>
Reg. No.: <u>9750LS</u>	
Employer: <u>U.S. FOREST SERVICE</u>	

Office of Clerk and Recorder, County of Lincoln. This "corner record" was filed for record on 8-19-98 and was noted on the cross-index map and is assigned page No. 10187 in book No.                     .  
Coral M. Cummings R AB  
County Official

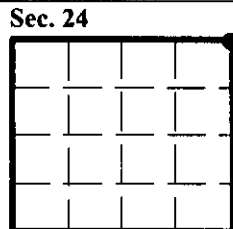

● - corner this sheet

No.

Cross Index

N-25

T.

26N

R.

29W

P.M., MT