

CERTIFIED CORNER RECORDATION

Corner W 1/16 S8 ^{S5} T. 26 N., R. 29 W., P.M.M. Lincoln County

Record :

None

Found Evidence :

None

Perpetuation :

At the computed location from a section breakdown by Davis Surveying, Inc., on record at the Lincoln County Courthouse, set a 5/8 inch dia., 24 inch long steel rebar, 22 ins. in the ground, with a 1 1/4 inch dia. Yellow P.V.C. cap stamped as shown below, from which:

A Douglas Fir, 4 1/2 ins. dia., bears N. 46° E., 12.60 ft. dist., scribed "X" BT.

A Grand Fir, 4 1/2 ins. dia., bears S. 29° E., 13.50 ft. dist., scribed (W 1/16 S8 BT).

Painted scribed faces red with 6 inch wide red bands around both Bearing Trees.

Attached Bearing Tree signs to both trees.

Set a 4 ft. long angle iron 1 ft. in the ground alongside the monument.



Magnetic Declination: 18° East

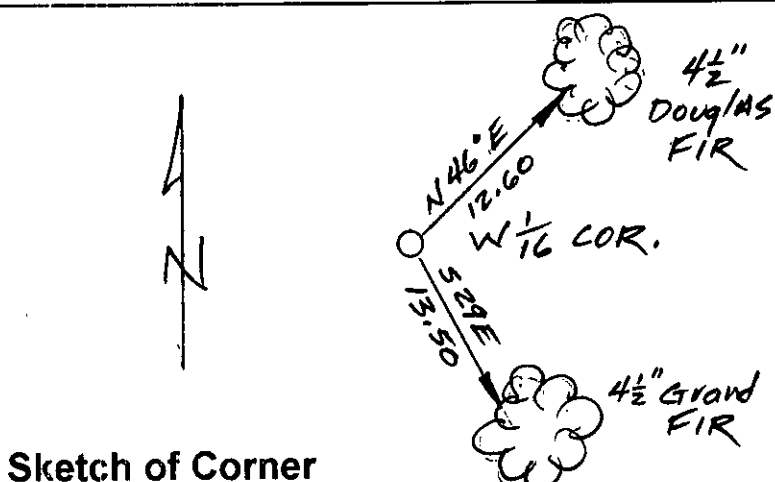

Sketch of Corner

CERTIFICATION
 I, John Damon
 certify the information shown herein is true and correct
John Damon
 Signature of Ground Party Chief
 I, Kenneth E. Davis
 certify that this Corner Record correctly represents work performed by me or under my direction in compliance with the "Corner Recordation Act" (70-22-101, et seq., M.C.A.)
Kenneth E. Davis
 Signature of Surveyor & Seal
 Date: 1-19-98 Reg. No. 4975
 Employer: Davis Surveying, Inc.

Office of Clerk and Recorder, County of Lincoln
 This "corner record" was filed for record on 1-21-98
 was noted on the cross-index plat and is assigned page No. 10075
 in book No. _____
Coral M. Amourap
 County Official

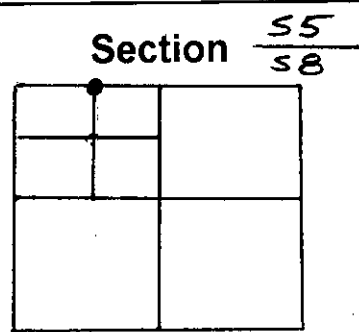

Cross Index No. S5 W 1/16 S8 T. 26 N., R. 29 W., PMM ● THIS CORNER