

1. Original and/or subsequent record used to evaluate the corner position.
2. Description of evidence found, note discrepancies in the record, state method of establishing lost or obliterated corners.
3. Description of monument and accessories set to perpetuate the corner position.
4. Sketch of corner, show all pertinent data which can best be shown in a sketch example, corner marking, topography ties, position of accessories,
5. Certification must be signed and sealed by Land Surveyor registered in the State of Montana.

CERTIFIED CORNER RECORDATIONCorner: E-W-W 1/256th; Secs. 28 & 33T. 26N.R. 28W. P.M.M. Lincoln County1992 Record:
(Hughes)

Set a 3/4 ins. diam. aluminum rod, 30 ins long, 26 ins. in the ground with a 3 1/4 ins. diam., U.S.F.S., aluminum cap; form which:

A larch, 21 ins. diam., bears N23E°E, 19.2 ft., scribed EWW 1/256 S28 BT
A spruce, 4 ins. diam., bears N67°E, 20.5 ft., scribed X BT

6 ft. galvanized steel post, bears East 4.0 ft., with Land Survey Marker & Property Boundary Decals.

2009 Found:

We find a 3/4" aluminum rod with a 3 1/4" USFS alum. cap, firmly set in good condition, flush with ground in an E-W fence line, marked as shown below, from which:

An 11" spruce stump, bears N23°E, 19.2 ft., with scribing partially visible.
A 30" larch, bears N67°E, 20.5 ft., with an overgrown blaze.

Monument is found approximately 1.2' East of a calculated position as determined by survey ties to the section corner common to Sections 28, 29, 32 & 33 and the 1/4 corner common to Sections 28 & 33 and is accepted as a faithful establishment of the corner.

2009 Perpetuation:

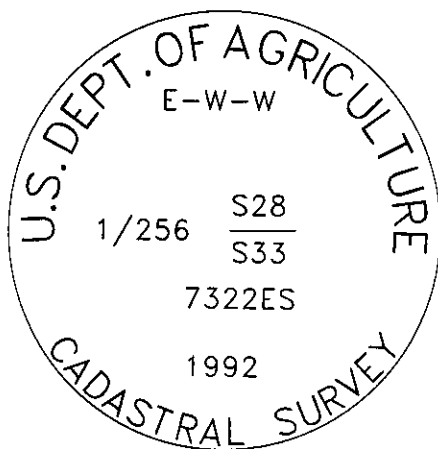
We paint red bands on the existing bearing tree, and attached USFS signs 54-3 & 54-9.
We create a larger mound of stone around the monument.SEE COS NO. 3991**SKETCH OF CORNER****CERTIFICATION**I, Chad R. Breuer
certify the information shown herein is true and correct.Chad R. Breuer
Signature Ground Party ChiefI, Ken E Jenkins
certify that this Corner Record correctly represents work performed by me or under my direction in compliance with the "Corner Recordation Act" (70-22-10), et seq., M.C.A.Ken E Jenkins
Signature of Surveyor & SealDate: 8/2009 Reg. No. 9330 LSEmployer: Montana Northwest CompanyPO Box 8777, Missoula, MT 59807406-721-4033 Project No. 1617-09

Office of Clerk and Recorder, County of _____ This "corner

record" was filed for record on

224834 BOOK: CCR CC&R'S PAGE: 11460 Pages: 1

was noted on the cross-index

STATE OF MONTANA LINCOLN COUNTY
RECORDED: 03/05/2010 9:03 KOI: CC&R'S

book No. _____ TAMMY D. LAUER CLERK AND RECORDER

FEE: \$0.00

BY: Tammy D. Lauer
TO: MONTANA NORTHWEST COMPANY P.O. BOX 8777, MISSOULA, MONTANA

Sec. 28

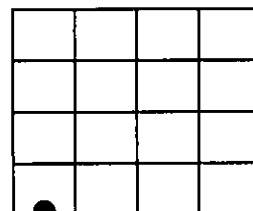
Cross Index No. V-9.75 T. 26N R. 29W PMM

● Corner this sheet