

1. Original and/or subsequent record used to evaluate the corner position.
2. Description of evidence found, note discrepancies in the record, state method of establishing lost or obliterated corners.
3. Description of monument and accessories set to perpetuate the corner position.
4. Sketch of corner, show all pertinent data which can best be shown in a sketch example, corner marking, topography ties, position of accessories,
5. Certification must be signed and sealed by Land Surveyor registered in the State of Montana.

CERTIFIED CORNER RECORDATION

Corner: Section Corner; Secs. 28,29,32&33 T. 26N. R. 28W. P.M.M. Lincoln County

1903 GLO Record: Set 3 ft. fir post. Established 4 bearing trees

1964 BLM Record: Set an iron post, 30 ins. long, 2 1/2" diam., 28 ins. in the ground, with brass cap, from which:

Original bearing trees:

An aspen, 16 ins. diam., bears S04 1/2°E, 247 lks (163.0 ft.), with illegible scribing

An aspen, 16 ins. diam., bears S16 1/4°W, 143 lks (94.4 ft.), with illegible scribing

Corner is 27 lks (17.8 ft.), N. of fence intersection extending E, SE & W.

1985 Record: Found a BLM monument, flush with ground, with a brass cap marked as described in the (Hill) BLM record, from which the following references:

An aspen snag, bears S18°W, 143.6 lks (94.8 ft.), scribing visible

An aspen blow down, bears S02°W, 242.4 lks (160.0 ft.), scribing visible

A fence corner post, bears East, 1.0 ft.

A fence corner post, bears S02°W, 17.9 ft.

New bearing tree

An aspen, 13 ins. diam., bears S48°W, 108.2 lks (71.4 ft.) marked T26N R28W S32 BT

Set guard post 2.0 ft. south from corner

2009 Found: We find a standard BLM monument with a 3 1/4" BLM brass cap, firmly set, in good condition, set flush with the ground, in E-W fence line, marked as shown below, from which:

An 18" aspen, bears S48°W, 71.4 ft., with scribing visible, and a 1985 BT tag marked "N48°W 71.4"

An 8" fence post, bears East 1.2 ft.

Decayed tree remains, bears S18°W, 94.8 ft.

Decayed tree remains, bears S5°E, 16.3 ft., w/ blank BT tag

2009 Perpetuation: From the found monument we establish the following reference monuments:

An 8" wood fence post, bears East, 1.2 ft.

A 14" aspen, bears S04°E, 152.0 ft., scribed T26N R28W S33 BT

We posted USFS decals P54-1 & P71-10 on steel post, 1.8 ft. south of monument.

We paint red bands on the existing & new bearing tree, and attached USFS signs 54-3 & 54-9.

SEE COS NO. 3991

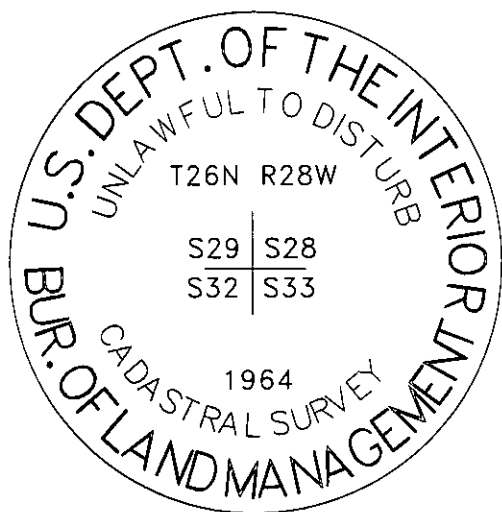
**SKETCH OF CORNER**

CERTIFICATION

I, Chad R. Breuer
certify the information shown herein is true and correct.

Chad R. Breuer
Signature Ground Party Chief

I, Ken E Jenkins
certify that this Corner Record correctly represents work performed by me or under my direction in compliance with the "Corner Recordation Act" (70-22-101) et seq. M.C.A.

Ken E Jenkins
Signature of Surveyor & Seal

Date: 8/2009 Reg. No. 9330 LS

Employer: Montana Northwest Company
PO Box 8777, Missoula, MT 59807
406-721-4033 Project No. 1617-09

Office of Clerk and Recorder, County of _____ This "corner record" was filed for record 224833 BOOK: CCR CC&R'S PAGE: 11459 Pages: 1 was noted on the cross-index STATE OF MONTANA LINCOLN COUNTY book No. _____ RECORDED: 03/05/2010 9:02 KOI: CC&R'S TAMMY D. LAUER CLERK AND RECORDER FEE: \$0.00 BY: Seamus J. Lauer TO: MONTANA NORTHWEST COMPANY P.O. BOX 8777, MISSOULA, MONTANA

Cross Index No.

V-9 T. 26N R. 28W PMM

● Corner this sheet

Sec. 28

