

CERTIFIED LAND CORNER RECORDATION
(REFERENCE FSM 7153.53)

DESCRIPTION OF CORNER EVIDENCE FOUND, AND ORIGINAL RECORD (IF KNOWN)

Record- Set iron post 30"x2½" with brass cap 27" in ground.
Found- Record iron post w/ brass cap set firmly in ground.
Record- Larch 14 in. dia. bears S26½°E 48lks. mkd. w/ overgrown blaze.
Found- Larch record dist. and bearing w/ overgrown blaze.
Record- Fir 12 in. dia. bears N27°W 30 lks. mkd. w/ overgrown blaze.
Found- Fir record dist. and bearing w/ overgrown blaze.

DESCRIPTION OF MONUMENT AND ACCESSORIES ESTABLISHED
TO PERPETUATE THE ORIGINAL LOCATION OF THIS CORNER:

Date of work: 11/80

As corner and accessories were in good condition, left corner as described in record. Repainted bearing trees.

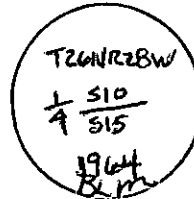

SKETCH OF
BRASS CAP

SKETCH, WITH COURSE AND DISTANCE TO ADJACENT CORNERS IF DETERMINED IN THIS SURVEY.
(MAY SKETCH OR PASTE REPRODUCTION ON REVERSE SIDE.)

SEE C.O.S. NO. 899

Surveyor's Seal

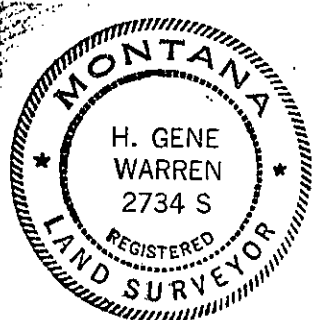

I, H. Gene Warren
certify that the information shown herein is true and correct.

Signature of Ground Party Chief

I,
certify that I have carefully performed or reviewed the work done on the diagrammed corner as reported on this recordation form and approve the same.

H. Gene Warren
Signature of Surveyor

DIAGRAM OF CORNER:

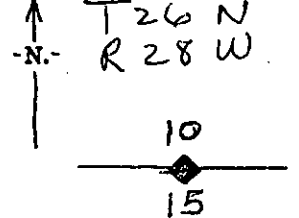

= Corner recorded on the sheet

2734-3
Registration Number

Office of Clerk and Recorder, County of Lincoln
This "corner record" was filed for record on the 7th day of July, 1981, was noted on the cross-index plat and is assigned page No. 1079, in book No. 1
Eleanor L. Vaughan, by Betty Sue, County Official
Cross Index No. J-15 T. 26 N. R. 28 W. Mer.

1. *Chlorophyll a* and *Chlorophyll b* were determined by the method of Lichtenthaler and Whistler (1973). The total chlorophyll content was determined by the method of Arar and Cook (1980). The carotenoid content was determined by the method of Lichtenthaler and Whistler (1973). The total carotenoid content was determined by the method of Arar and Cook (1980). The total protein content was determined by the method of Lowry et al. (1951). The total lipid content was determined by the method of Bligh and Dyer (1959). The total carbohydrate content was determined by the method of Dubois and Gilles (1950). The total nucleic acid content was determined by the method of Burton (1956). The total ash content was determined by the method of AOAC (1990). The total moisture content was determined by the method of AOAC (1990). The total dry matter content was determined by the method of AOAC (1990). The total organic acid content was determined by the method of AOAC (1990). The total alkaloid content was determined by the method of AOAC (1990). The total saponin content was determined by the method of AOAC (1990). The total tannin content was determined by the method of AOAC (1990). The total flavonoid content was determined by the method of AOAC (1990). The total phenolic content was determined by the method of AOAC (1990). The total terpenoid content was determined by the method of AOAC (1990). The total steroid content was determined by the method of AOAC (1990). The total glycoside content was determined by the method of AOAC (1990). The total alkaloid content was determined by the method of AOAC (1990). The total saponin content was determined by the method of AOAC (1990). The total tannin content was determined by the method of AOAC (1990). The total flavonoid content was determined by the method of AOAC (1990). The total phenolic content was determined by the method of AOAC (1990). The total terpenoid content was determined by the method of AOAC (1990). The total steroid content was determined by the method of AOAC (1990). The total glycoside content was determined by the method of AOAC (1990).

Year	1950	1951	1952	1953	1954	1955	1956	1957	1958	1959	1960	1961	1962	1963	1964	1965	1966	1967	1968	1969	1970	1971	1972	1973	1974	1975	1976	1977	1978	1979	1980	1981	1982	1983	1984	1985	1986	1987	1988	1989	1990	1991	1992	1993	1994	1995	1996	1997	1998	1999	2000	2001	2002	2003	2004	2005	2006	2007	2008	2009	2010	2011	2012	2013	2014	2015	2016	2017	2018	2019	2020	2021	2022	2023	2024	2025	2026	2027	2028	2029	2030	2031	2032	2033	2034	2035	2036	2037	2038	2039	2040	2041	2042	2043	2044	2045	2046	2047	2048	2049	2050	2051	2052	2053	2054	2055	2056	2057	2058	2059	2060	2061	2062	2063	2064	2065	2066	2067	2068	2069	2070	2071	2072	2073	2074	2075	2076	2077	2078	2079	2080	2081	2082	2083	2084	2085	2086	2087	2088	2089	2090	2091	2092	2093	2094	2095	2096	2097	2098	2099	2100																														
Population	1000000	1050000	1100000	1150000	1200000	1250000	1300000	1350000	1400000	1450000	1500000	1550000	1600000	1650000	1700000	1750000	1800000	1850000	1900000	1950000	2000000	2050000	2100000	2150000	2200000	2250000	2300000	2350000	2400000	2450000	2500000	2550000	2600000	2650000	2700000	2750000	2800000	2850000	2900000	2950000	3000000	3050000	3100000	3150000	3200000	3250000	3300000	3350000	3400000	3450000	3500000	3550000	3600000	3650000	3700000	3750000	3800000	3850000	3900000	3950000	4000000	4050000	4100000	4150000	4200000	4250000	4300000	4350000	4400000	4450000	4500000	4550000	4600000	4650000	4700000	4750000	4800000	4850000	4900000	4950000	5000000	5050000	5100000	5150000	5200000	5250000	5300000	5350000	5400000	5450000	5500000	5550000	5600000	5650000	5700000	5750000	5800000	5850000	5900000	5950000	6000000	6050000	6100000	6150000	6200000	6250000	6300000	6350000	6400000	6450000	6500000	6550000	6600000	6650000	6700000	6750000	6800000	6850000	6900000	6950000	7000000	7050000	7100000	7150000	7200000	7250000	7300000	7350000	7400000	7450000	7500000	7550000	7600000	7650000	7700000	7750000	7800000	7850000	7900000	7950000	8000000	8050000	8100000	8150000	8200000	8250000	8300000	8350000	8400000	8450000	8500000	8550000	8600000	8650000	8700000	8750000	8800000	8850000	8900000	8950000	9000000	9050000	9100000	9150000	9200000	9250000	9300000	9350000	9400000	9450000	9500000	9550000	9600000	9650000	9700000	9750000	9800000	9850000	9900000	9950000	10000000

1 1 1

[illegible]

• • •

11

— — — — —

1970-1971

2. 7. 1972

1945