

CERTIFIED LAND CORNER RECORDATION

(REFERENCE FSM 7153.53)

DESCRIPTION OF CORNER EVIDENCE FOUND, AND ORIGINAL RECORD (IF KNOWN)

Record- Set iron post 30"x2½" w/ brass cap 27" in ground. Buried orig. stone alongside.
 Found- Record iron post w/ brass cap set in ground.
 Record- Pine 10 In. dia. bears N61°E 53lks. mkd. T26NR28W S12 BT.
 Found- Pine record dist and bearing with scribing evident.
 Record- Fir 7 in. dia. bears S36°E 100 lks. mkd. T26NR28W S13 BT.
 Found- Fir record dist and bearing w/ scribing evident.
 Record- Fir 8 in. dia. bears S20°W 58 lks. mkd. T26NR28W S14 BT.
 Found- Fir record dist. and bearing with scribing evident.
 Record- Fir 6 in. dia. bears N79°W 37lks. mkd. T26N R28W S11 BT.
 Found- Fir record dist. and bearing w/ scribing evident.

DESCRIPTION OF MONUMENT AND ACCESSORIES ESTABLISHED TO PERPETUATE THE ORIGINAL LOCATION OF THIS CORNER:

Date of work: 11/80

As corner and accessories were in good condition, left corner as described in record. Repainted bearing trees.



Sketch of brass cap

SKETCH, WITH COURSE AND DISTANCE TO ADJACENT CORNERS IF DETERMINED IN THIS SURVEY. (MAY SKETCH OR PASTE REPRODUCTION ON REVERSE SIDE.)

SEE C.O.S. NO. 899

Surveyor's Seal

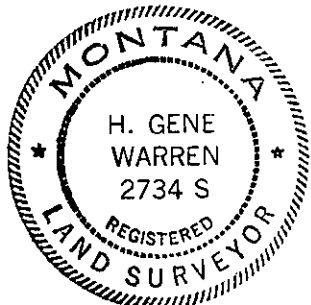

I, H. Gene Warren, certify that the information shown herein is true and correct.

Signature of Ground Party Chief

I, certify that I have carefully performed or reviewed the work done on the diagrammed corner as reported on this recordation form and approve the same.

H. Gene Warren
 Signature of Surveyor

DIAGRAM OF CORNER:

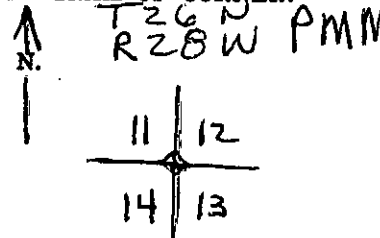

= Corner recorded on the sheet

2734-5
 Registration Number

Office of Clerk and Recorder, County of Lincoln
 This "corner record" was filed for record on the 7th day of July, 1981, was noted on the cross-index plat and is assigned page No. 1064, in book No. 1
 County Official: Eleanor L. Vaughn, by Betty Bell, Deputy
 Cross Index No. J-21 T. 26N R. 28W Mer. PMM