

**CERTIFIED LAND CORNER RECORDATION**  
(REFERENCE FSH 5681.65)

DESCRIPTION OF CORNER EVIDENCE FOUND, AND ORIGINAL RECORD (IF KNOWN)

At the corner common to secs. 4, 3, 9, and 10, T. 26 N., R. 28 W., I found the original corner stone, 18 x 14 x 10 inches, firmly set 14 inches into ground with 5 notches on south face and 3 notches on east face, from which:

A 9-inch white fir bears  $45^\circ$  E., 37 links, scribing "R. 28 W., sec. 3" visible.  
(Record: 6-inch fir bears N.  $44^\circ$  E., 37 links.)

A 20-inch Douglas-fir bears S.  $31^\circ$  E., 37 links, scribing "R. 28 W., sec. 10" visible.  
(Record: 14-inch fir bears S.  $22^\circ$  E., 37 links.) Actual in the field.

A 17-inch Douglas-fir bears S.  $81^\circ 15'$  W., 19 links, scribing "T. 26 N., R. 28 W., section 9" visible.  
(Record: 14-inch fir bears S.  $81^\circ 15'$  W., 19 links.)

DESCRIPTION OF MONUMENT AND ACCESSORIES ESTABLISHED TO PERPETUATE THE ORIGINAL LOCATION OF THIS CORNER:

A 20-inch Douglas-fir bears N.  $28^\circ$  W., 57 links, scribing "R. 28 W., sec. 4" visible.  
(Record: 12-inch fir bears N.  $30^\circ 5'$  W., 57 links.)

Date of work: May 21, 1964

At the center point of the original corner stone, I set a 2-inch galvanized iron pipe 26 inches into the ground with brass cap of pipe marked:

T. 26 N., R. 28 W.,

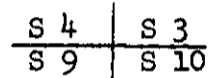

1964

I buried the original stone alongside the iron pipe, from which:

9-inch spruce bears S.  $23^\circ$  E., 30 links, scribed "S 10 RM."  
9-inch spruce bears N.  $17^\circ \frac{1}{2}$  W., 21 links, scribed "S 4 RM."

858ES --IMT --ART

SKETCH, WITH COURSE AND DISTANCE TO ADJACENT CORNERS IF DETERMINED IN THIS SURVEY.  
(MAY SKETCH OR PASTE REPRODUCTION ON REVERSE SIDE.)

(Record from original GLO notes.)

Surveyor's Seal

I, A. R. Trenkle  
certify that the information shown herein is true and correct.

A. R. Trenkle  
Signature of Ground Party Chief

I, Ira M. Tillotson  
certify that I have carefully performed or reviewed the work done on the diagrammed corner as reported on this recordation form and approve the same.

Ira M. Tillotson  
Signature of Surveyor

DIAGRAM OF CORNER:

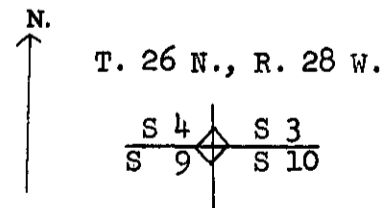

◆ = Corner recorded on the sheet

858ES  
Registration Number

Office of Clerk and Recorder, County of Lincoln

This "corner record" was filed for record on the 4th. day of SEPTEMBER 1964, was noted on the cross-index plat and is assigned page No. 10, in book No. 1

M.M. MANSFIELD, By: Mae Watson  
County Official Deputy P.M.M.

Cross Index No. E 13 T. 26 N., R. 28 W., Mer.