

**INSTRUCTIONS**

1. Original and/or subsequent record used to evaluate the corner position.
2. Description of evidence found, note discrepancies in the record, state method of establishing lost or obliterated corners.
3. Description of monument and accessories set to perpetuate the corner position.
4. Sketch of corner, show all pertinent data which can best be shown in a sketch example, corner marking, topography ties, position of accessories, etc.
5. Certification must be signed and sealed by Land Surveyor registered in the State of Montana.
6. Fill in Cross Index & Section Diagram at bottom of sheet.

**CERTIFIED CORNER RECORDATION**

Corner  $\frac{1}{4}$   $\frac{S 12}{S 13}$  T. 26 N. R. 27 W. P.M.M. SANDERS LINCOLN County

ORIGINAL AND/OR  
SUBSEQUENT RECORD

ORIGINAL RECORD: Set a Lime Stone 22"x 10"x 10", 16" in the ground, for  $\frac{1}{4}$  on N face;  
From Which:  
A Pine, 22" in diam. bears  $S 8^{\circ} 30' W$ , 41 lks. dist. marked  $\frac{1}{4}$  S 13 B.T.  
A Pine, 30" in diam. bears  $N 15^{\circ} 45' W$ , 22 lks. dist. marked  $\frac{1}{4}$  S 12 B.T.

EVIDENCE FOUND

Found Set stone with  $\frac{1}{4}$  on South Face. From which a 24" P. Pine with scribing and ACM tag bears  $N 14^{\circ} W$ , 14.6'; a 18" P. Pine bears  $S 10^{\circ} W$  26.5' with grown over blaze.

PERPETUATION

Left stone in place. Established RM tree a 10" D. Fir bears  $S 85^{\circ} W$  22.7' Blazed with R/M scribed near base. Placed a MARLS Land Monument Sign on RM and original BT.

Note: Declination used -  $20^{\circ} E$   
Measurements taken to the center of tree.

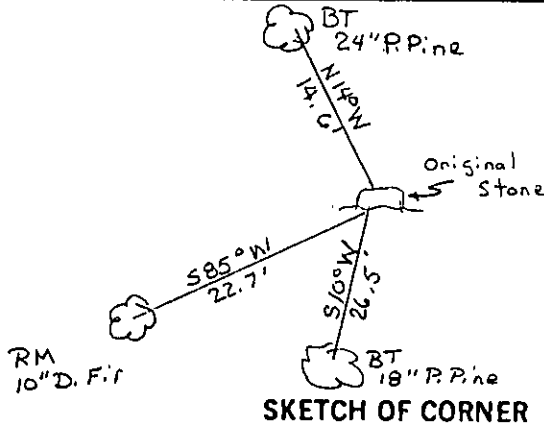

CERTIFICATION

1. Rod Cone  
certify the information shown herein is true and correct.  
Rod Cone  
Signature Ground Party Chief  
**TERRY L. DRUYVESTEIN**  
certify that this Corner Record correctly represents work performed by me or under my direction in accordance with the "Corner Recordation Act" (70-22-101, et seq., M.C.A.)  
TERRY L. DRUYVESTEIN  
Signature of Surveyor & Seal 2927ES  
Date: 07/90 Reg. No. 2927 ES  
Employer: STENSATTER DRUYVESTEIN & ASSOCIATES

Office of Clerk and Recorder, County of Lincoln. This "corner record" was filed for record on 1-4-91 was noted on the cross-index plat and is assigned page No. 4410, in book No. \_\_\_\_\_

Janet BF Sigel by Bill Buschhoff  
County Official

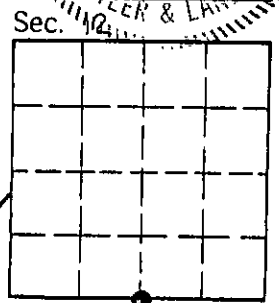

Cross Index No. J-23 T. 26 N. R. 27 W. P.M.M.