

INSTRUCTIONS

1. Original and/or subsequent record used to evaluate the corner position.
2. Description of evidence found, note discrepancies in the record, state method of establishing lost or obliterated corners.
3. Description of monument and accessories set to perpetuate the corner position.
4. Sketch of corner, show all pertinent data which can best be shown in a sketch example, corner marking, topography ties, position of accessories, etc.
5. Certification must be signed and sealed by Land Surveyor registered in the State of Montana.
6. Fill in Cross Index & Section Diagram at bottom of sheet.

CERTIFIED CORNER RECORDATION

Corner $\frac{1}{4}$ S 3 | S 2 T. 26 N R. 27 W P.M.M. LINCOLN County

ORIGINAL AND/OR
SUBSEQUENT RECORD

ORIGINAL RECORD: Set a Lime Stone, 15" x 12" x 10", 10" in the ground marked $\frac{1}{4}$ on W Face;
From Which:
A Fir 18" in diam. bears S21°30'E, 22 lks., marked $\frac{1}{4}$ S 2 B.T.
A Fir 8" in diam. bears N17°30'W, 32 lks., marked $\frac{1}{4}$ S 3 B.T.

EVIDENCE FOUND None

PERPETUATION Set $\frac{3}{4}$ " Alum. Cap. on $\frac{3}{4}$ " x 24" Rebar. Established two RM's a 4" Larch bears S54°W, 7.7' and a 7" LP Pine bears S21°E, 8.1'. Both RM trees Blazed and Tagged with MARLS Land Monument Sign.

Note: Declination used - 20°E
Measurements taken to the center of tree

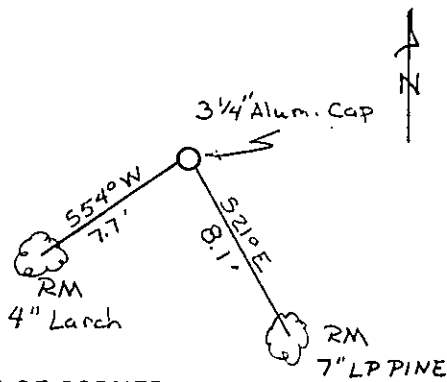
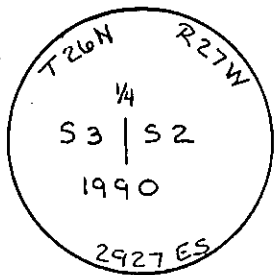

SKETCH OF CORNER

CERTIFICATION

I, Paul Cone
certify the information shown herein to be true and correct.

Paul Cone
Signature Ground Party Chief

TERRY L. DRUYVESTEIN
I, TERRY L. DRUYVESTEIN
certify that this Corner Record correctly represents work performed by me or under my direction in compliance with the "Corner Recordation Act" (70-22-101, et seq., M.C.A.)

Terry L. Druyvestein
Signature of Surveyor & Seal 2927ES

Date: 07/90 Reg. No. 2927ES

Employer: STENSATTER DRUYVESTEIN & ASSOCIATES

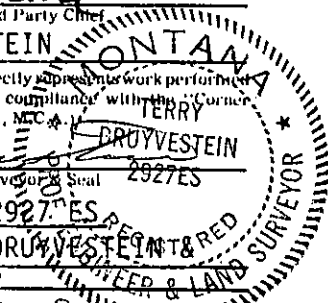

Office of Clerk and Recorder, County of Lincoln. This "corner record" was filed for record on 1-4-91 was noted on the cross-index plat and is assigned page No. 4399, in book No.

Janet St. Sigel by Bill Beckoff
County Official

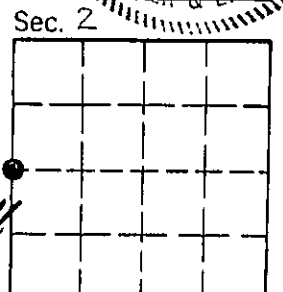

Cross Index No. C-17 T. 26N R. 27W P.M.M.

• - corner this sheet