

CERTIFIED CORNER RECORDATION

Corner W 1/4 Cor S 8 T 26 N. R. 27 W. P.M.M. LINCOLN County

I. Record: 1902 GLO survey by Burton Adams :Set a pine post 3 ft. long, 5 ins. square, 24 ins. in the ground, marked 1/4 S.8 on E., and 1/4 S.7 on W. faces from which:

- A pine, 10 ins. diam., bears N.32°30'E., 35 lks. dist. (23.10 ft.) mkd. 1/4 S. 8 BT.
- A pine, 15 ins. diam., bears S.77°W., 14 lks. dist. (9.24 ft.) mkd. 1/4 S. 7 BT.

II. Found:

- A Lodgepole pine snag, 14 ins. diam. bears N.32°E., 23.10 ft. dist. with visible scribing.
- A Lodgepole pine snag, 15 ins. diam. bears S.77°W., 9.24 ft. dist. with visible scribing.

III. Perpetuation: At a position determined by a distance distance intersection from original found bearing trees, we set a 2 1/2 in. diam. Alum. pipe 30 ins. long 24 ins. in the ground, with a 3 1/4 in. diam. Alum. cap mkd. as shown below from which:

- A spruce, 14 ins. diam., bears S.52°E., 31.35 ft. dist. scribed 1/4 S. 8 BT.
- A spruce, 8 ins. diam., bears S.37°W., 31.45 ft. dist. scribed 1/4 S. 7 BT.

Painted faces and 6 in. wide red bands to all bearing trees and attached Land Survey Monument and Bearing Tree signs.

Magnetic declination: 18° East assumed

Equipment used: Hand compass and loggers tape

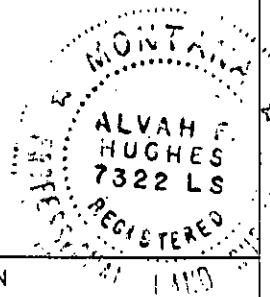
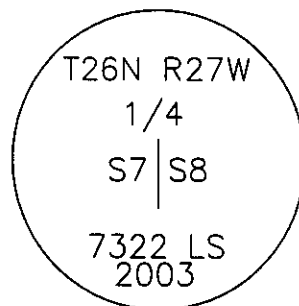

Kootenai Surveyors Inc., 314 California Av., Libby, MT. 59923 (406) 293-4354

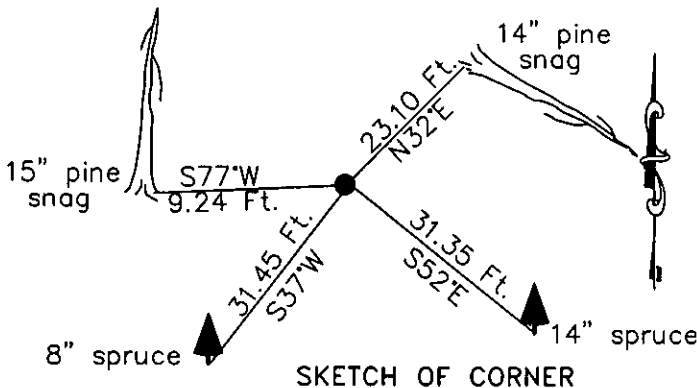

SKETCH OF CORNER

CERTIFICATION

I, John Damon certify the information shown herein is true and correct.

John Damon
Signature Ground Party Chief

I, Alvah F. Hughes certify that this Corner Record correctly represents work performed by me or under my direction in compliance with the "Corner Recordation Act" (70-22-101, et seq., M.C.A.)

Alvah F. Hughes 7322 LS
Signature of Surveyor & Seal

Date: 12/08/04 Reg. No. 7322-LS

Employer: Kootenai Surveyors Inc.

Office of Clerk and Recorder, County of Lincoln This "corner

record" was filed for record or 181361 BOOK: CCR CC&R'S PAGE: 10756 Pages: 1
was noted on the cross-index STATE OF MONTANA LINCOLN COUNTY
book No. RECORDED: 12/17/2004 10:11 KOI: CC&R'S
CORAL M. CUMMINGS CLERK AND RECORDER

FEE: \$0.00
TO: FILED

BY: Jeanne Dean
Deputy

Cross Index No. G 05 T. 26N. R. 27W. P.M., MT

Adopted July 1, 1981, Montana Board of Professional Engineers & Land Surveyors

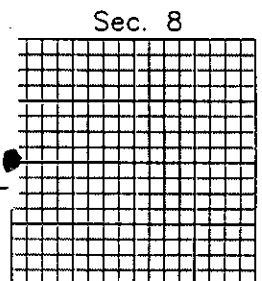

• corner this sheet