

## INSTRUCTIONS

1. Original and/or subsequent record used to evaluate the corner position.
2. Description of evidence found, note discrepancies in the record, state method of establishing lost or obliterated corners.
3. Description of monument and accessories set to perpetuate the corner position.
4. Sketch of corner, show all pertinent data which can best be shown in a sketch example, corner marking, topography ties, position of accessories, etc.
5. Certification must be signed and sealed by Land Surveyor registered in the State of Montana.
6. Fill in Cross Index & Section Diagram at bottom of sheet.

## CERTIFIED CORNER RECORDATION

Corner NE SEC COR of S34 T. 25 N. R. 30 W. P.M.M. Sanders County

- I. 1916 G.L.O. original record by S. Walters et al: Set a slatestone, 16x10x8 ins., 10 ins. in the ground, for cor. of secs. 26, 27, 34 and 35, mkd. with 1 notch on the S and 2 notches on the E edges from which

A pine, 8 ins. diam., bears N47 1/2° E, 11 lks. (7.26 ft.) dist., mkd. T25N R30W S26 BT.  
 A pine, 8 ins. diam., bears S71 1/4° E, 137 lks. (90.42 ft.) dist., mkd. T25N R30W S35 BT.  
 A pine, 6 ins. diam., bears S30 1/2° W, 65 lks. (42.9 ft.) dist., mkd. T25N R30W S34 BT.  
 A pine, 6 ins. diam., bears S21 1/4° W, 80 lks. (52.8 ft.) dist., mkd. T25N R30W S27 BT.

- II. Found a 6x10 ins. stone, firmly set, protruding 1 in. out of the ground, with 2 grooves on the W side and 1 groove on the N sides (not of record), from which

A ponderosa pine, 33 ins. diam., bears S72° E, 91 ft. dist., mkd. T25N R30W S35.

- III. Set a 2 1/2 ins. diam. by 30 ins. long aluminum pipe, 25 ins. in the ground, with a 3 1/4 ins. diam. aluminum cap mkd. as shown

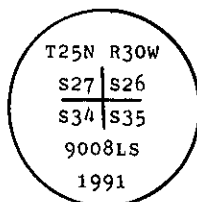

Bury original stone alongside monument.

Established three new bearing trees:

A ponderosa pine, 21 ins. diam., bears N64° E, 45.0 ft. dist., mkd. T25N R30W S26 BT.  
 A douglas fir, 9 ins. diam., bears S65° W, 19.4 ft. dist., mkd. T25N R30W S34 BT.  
 A douglas fir, 25 ins. diam., bears N67° W, 11.3 ft. dist., mkd. T25N R30W S27 BT.

Painted red bands around the bearing trees and attached Land Survey Monument and Bearing Tree signs.  
 Set a 6 ft. galvanized steel guard post with Land Survey Marker and Property Boundary decals West, 3 ft.

Magnetic Declination: 20° East

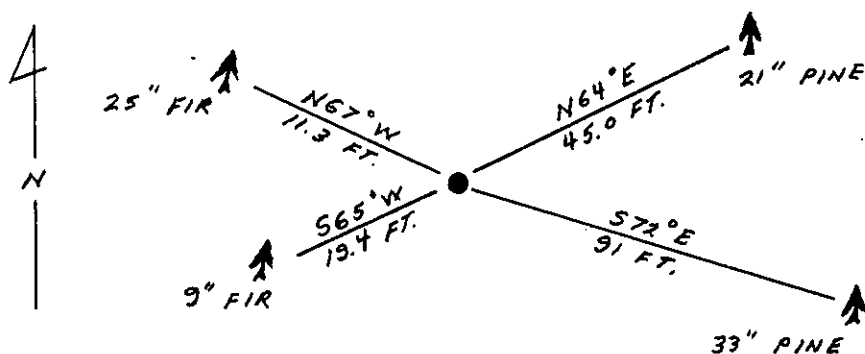

SKETCH OF CORNER

## CERTIFICATION

I, Gary C. Crismon  
 certify the information shown herein is true and correct.

Gary C. Crismon  
 Signature Ground Party Chief

I, Ronald A. Pearson  
 certify that this Corner Record correctly represents work performed by me or under my direction in compliance with the "Corner Recordation Act" (70-22-101, et seq., M.C.A.)

Ronald A. Pearson  
 Signature of Surveyor & Seal

Date: 7/10/99 Reg. No. 9008 LS

Employer: U.S. FOREST SERVICE

Office of Clerk and Recorder, County of Lincoln. This "corner record" was filed for record on Aug 13, 1991 was noted on the cross-index plat and is assigned page No. 4557, in book No. Coral Mountain by Bill Buck

County Official

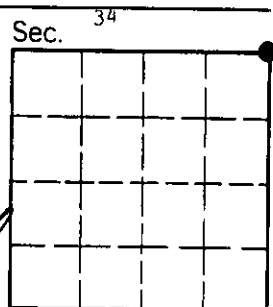

Cross Index No. V-17 T. 25 N. R. 30 W. P.M.M.

• corner this sheet