

INSTRUCTIONS

Q:CO-STD/152
Created 4/8/92

1. Original and/or subsequent record used to evaluate the corner position.
2. Description of evidence found, note discrepancies in the record, state method of establishing lost or obliterated corners.
3. Description of monument and accessories set to perpetuate the corner position.
4. Sketch of corner, show all pertinent data which can best be shown in a sketch example, corner marking, topography ties, position of accessories.
5. Certification must be signed and sealed by Land Surveyor registered in the State of Montana.
6. Fill in Cross Index & Section Diagram at bottom of sheet.

CERTIFIED CORNER RECORDATION

Corner No. 1 Montana MS 6195 & No. 1 Kentucky MS 6196 T. 25 N. R. 30 W. P.M.M. LINCOLN County

RECORD:

MS NO. 6195 Montana, Robert C. Williams, U.S. Deputy Mineral Surveyor, 1901

Corner No. 1

I commenced this survey at Cor. No. 1, identical with N.E. location corner, where I set a post, 4 1/2 ins. square, 5 ft. long, 2 ft. deep, marked 1-6195, for Cor. No. 1, and raised a mound of stone and earth around post.

The U.S.L.M. No. 6185, bears S.22°31'W., 2058.5 ft.

N.E. corner of concentrating mill, 70x140 ft., bears N.83°15'W., 232.8 ft.

Cor. No. 1 of Sur. No. 6189, bears S. 74°51'W., 1711.5 ft.

S.E. cor. Saw mill on Sur. No. 6196, 30x60ft., bears N.74°50'W., 307 ft.

MS NO. 6196 Kentucky, Robert C. Williams, U.S. Deputy Mineral Surveyor, 1901

Corner No. 1

I commenced this survey at Cor. No. 1, identical with S.E. location corner Cor. No. 1 of Sur. 6195, where is set a post, 4 1/2 ins. square, 5 ft. long, 2 ft. deep, marked 1-6195, I marked 1-6196, for Cor. No. 1 of this survey, there is a mound of stone and earth around post.

The U.S.L.M. No. 6185, bears S.22°31'W., 2058.5 ft.

Cor. No. 1 of Sur. No. 6194, bears S. 74°51'W., 1711.5 ft.

FOUND:

Found no remaining evidence of the original post or the mound of stone. There are partial remains of the buildings, however no sufficient evidence remains. It appears the 1910 fires destroyed the Millsite.

TO PERPETUATE:

At record position, set a 5/8" x 24" rebar, with a USFS 3-1/4" aluminum cap, 11" in the ground, marked as shown below and raise a mound of stones 30" x 12" to cap.

From which new trees:

A lodgepole pine, 10" in diam., bears S.52°W., 7.5', blazed and scribed "1 MS 6195 BT".

A lodgepole pine, 7" in diam., bears N.26°W., 27.0', blazed and scribed "1 MS 6196 BT".

Place a "Land Survey Monument" (54-9), and a "Bearing Tree" (54-3) sign on the bearing trees. Painted all blazes red, and a 6" red band above the "Bearing Tree" signs. Placed 6' steel posts on property line, 5' +/- from the corner, with "Land Survey Marker" (54-9), and "Property Boundary" (54-2) decals.

See Certificate of Survey, recorded in Lincoln County

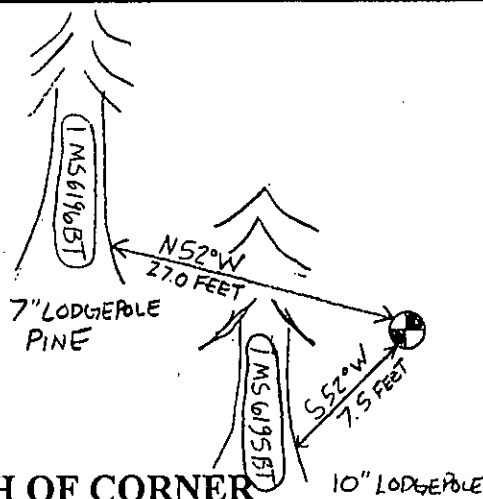
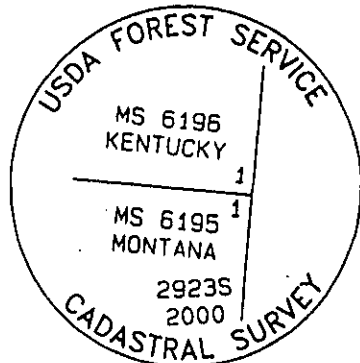

SKETCH OF CORNER

CERTIFICATION

I, Matt Jacobson
certify the information shown herein is true and correct.

Matt Jacobson
Signature Ground Party Chief

I, R.A. Ainsworth
certify that this Corner Record correctly represents work performed by me or under my direction in compliance with the "Corner Recordation Act" (70-22-101, et seq., M.C.A.)

RICHARD AINSWORTH
Signature of Surveyor & Seal

Date: 11/00 Reg. No. 2923S

Employer: Professional Consultants, Inc.

Sec. 8

Office of Clerk and Recorder, County of Lincoln. This "corner record" was filed for record on Jan 19, 2001 was noted on the cross-index plat and is assigned page No. 10473, in book No. Coral M. Cummings By RB

County Official

