

## INSTRUCTIONS

Q:CO-STD/152  
Created 4/8/92

1. Original and/or subsequent record used to evaluate the corner position.
2. Description of evidence found, note discrepancies in the record, state method of establishing lost or obliterated corners.
3. Description of monument and accessories set to perpetuate the corner position.
4. Sketch of corner, show all pertinent data which can best be shown in a sketch example, corner marking, topography ties, position of accessories.
5. Certification must be signed and sealed by Land Surveyor registered in the State of Montana.
6. Fill in Cross Index & Section Diagram at bottom of sheet.

## CERTIFIED CORNER RECORDATION

Corner No. 2 Montana MS 6195 & No. 2 Kentucky MS 6196 T. 25 N. R. 30 W. P.M.M. LINCOLN County

## RECORD:

MS NO. 6195 Montana, Robert C. Williams, U.S. Deputy Mineral Surveyor, 1901

Corner No. 2

660 N.W. location corner. Set a post, 4 1/2 ins. square, 5 ft. long, 2 ft. deep, marked 2-6195, for Cor. No. 2, and raised a mound of stone and earth around post.

N.W. corner of office, 30x30 ft., bears S.69°30'W., 202 ft.

N.W. corner boarding house, 30x70 ft., bears S.30°20'E., 76 ft.

N.W. corner of office, 30x30 ft., bears S.59°E., 328 ft.

MS NO. 6196 Kentucky, Robert C. Williams, U.S. Deputy Mineral Surveyor, 1901

Corner No. 2

660 S.W. location corner, and Cor. No. 2 of Sur. 6195, a post, 4 1/2 ins. square, 5 ft. long, 2 ft. deep, marked 2-6195, I marked 2-6196, for Cor. No. 1 of this survey; there is a mound of stone and earth around post.

## FOUND:

Found no remaining evidence of the original post or the mound of stone. There are partial remains of the buildings, however no sufficient evidence remains. It appears the 1910 fires destroyed the Millsite.

## TO PERPETUATE:

At record position, set a 5/8" x 24" rebar, with a USFS 3-1/4" aluminum cap 23" in the ground, marked as shown below.

From which new trees:

A hemlock, 8" in diam., bears N.67°E., 11.8', blazed and scribed "2 MS 6196 BT".

A grand fir, 9" in diam., bears S.22°E., 34.0', blazed and scribed "2 MS 6195 BT".

Place a "Land Survey Monument" (54-9), and a "Bearing Tree" (54-3) sign on the bearing trees. Painted all blazes red, and a 6" red band above the "Bearing Tree" signs. Placed 6" steel posts on property line, 3' +/- from the corner with "Land Survey Marker" (54-9), and "Property Boundary" (54-2) decals

See Certificate of Survey, recorded in Lincoln County

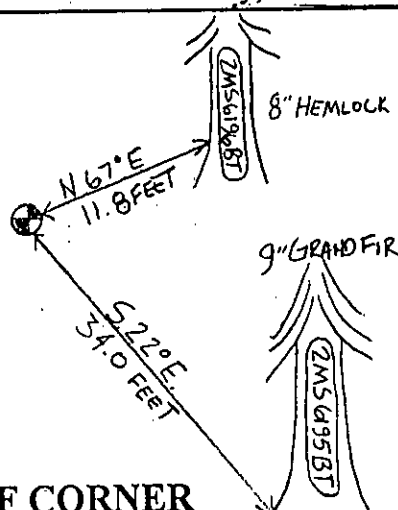
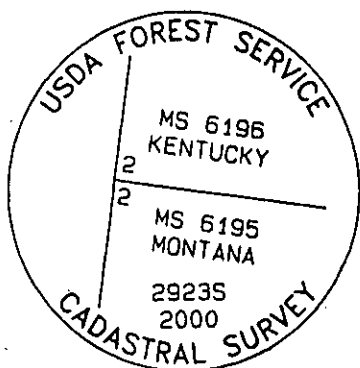

SKETCH OF CORNER

## CERTIFICATION

I, Matt Jacobson  
certify the information shown herein is true and correct.

Matt Jacobson  
Signature Ground Party Chief

I, R.A. Ainsworth  
certify that this Corner Record correctly represents work performed by me or under my direction in compliance with the "Corner Recordation Act" (70-22-101, et seq., M.C.A.)

R.A. Ainsworth  
Signature of Surveyor & Seal

Date: 11/00 (Reg. No. 29235)

Employer: Professional Consultants, Inc.

Sec. 8

Office of Clerk and Recorder, County of Lincoln. This "corner record" was filed for record on Jan 10, 2001 was noted on the cross-index plat and is assigned page No. 10476, in book No. Corral M. Cummins

By DB  
County Official

