

INSTRUCTIONS

1. Original and/or subsequent record used to evaluate the corner position.
2. Description of evidence found, note discrepancies in the record, state method of establishing lost or obliterated corners.
3. Description of monument and accessories set to perpetuate the corner position.
4. Sketch of corner, show all pertinent data which can best be shown in a sketch example, corner marking, topography ties, position of accessories, etc.
5. Certification must be signed and sealed by Land Surveyor registered in the State of Montana.
6. Fill in Cross Index & Section Diagram at bottom of sheet.

CERTIFIED CORNER RECORDATION

Corner 1/4 S4 & S3 T. 25 N. R. 29 W. Lincoln County

I. 1916 G.L.O. record by S. F. Walters, C. Dyson & D. MacRae: Set a slate stone, 18x14x6 ins., 12 ins. in the ground, for 1/4 sec. cor., marked 1/4 on the west face, from which:

- A pine, 6 ins. diam., bears S 19 3/4° E, 65 lks. dist., marked 1/4 S 3 BT.
A tamarack, 24 ins. diam., bears N 70 3/4° W, 110 lks. dist., marked 1/4 S 4 BT.

II. Found a stone, 9x4 ins., 10 ins. above the ground, firmly set, mkd. 1/4 on the W. face, from which:

- A dead pine, 8 ins. diam., bears S 20° E, 42.9 ft., mkd. 1/4 S 3 BT.
A dead larch, 23 ins. diam., bears N 71° W, 72.6 ft. dist., mkd. 1/4 S 4 BT.

III. At the position of the found stone, set a 2 1/2 in. diam. X 30 ins. long aluminum pipe, 20 ins. in the ground, with a 3 1/4 in. diam. aluminum cap mkd. as shown below. Buried the original stone alongside the aluminum pipe.

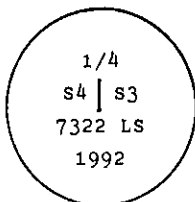

from which the new bearing trees:

- A larch, 12 ins. diam., bears S 26° E, 29.8 ft. dist. mkd. 1/4 S 3 BT.
A fir, 11 ins. diam., bears S 56° W, 26.5 ft. dist., mkd. 1/4 S 4 BT.

Painted red bands around the bearing trees and attached Land Survey Monument and Bearing Tree signs.

Magnetic Declination: 20° East

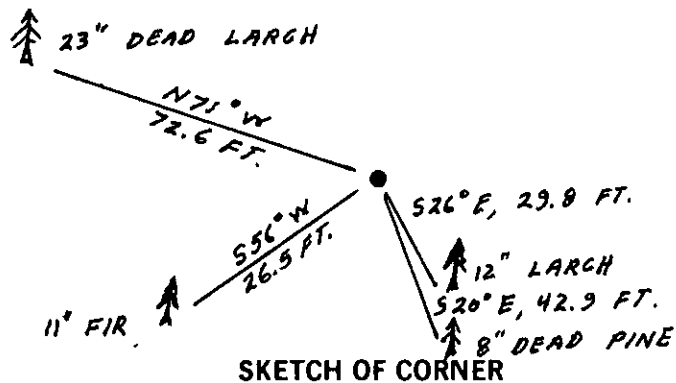

CERTIFICATION

I, Thomas M. Hommel
certify the information shown herein is true and correct.
Thomas M. Hommel
Signature Ground Party Chief

I, Alvah F. Hughes
certify that this Corner Record correctly represents work performed by me or under my direction in compliance with the "Corner Recordation Act" (70-22-101, et seq., M.C.A.).

Alvah F. Hughes
Signature of Surveyor & Seal
Date: 12/10/92 Reg. No. 7322 LS
Employer: U.S. FOREST SERVICE

Office of Clerk and Recorder, County of Lincoln. This "corner record" was filed for record on 12-14-92 was noted on the cross-index plat and is assigned page No. 5133, in book No. Coral M. Cummings by BB
County Official

C-13

25 N 29 W

Cross Index No. T. R. PMM

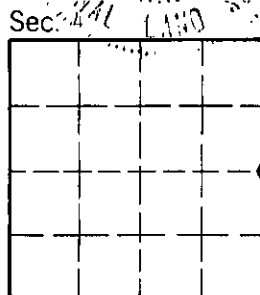

• - corner this sheet