

1. Original and/or subsequent record used to evaluate the corner position.
2. Description of evidence found, note discrepancies in the record, state method of establishing lost or obliterated corners.
3. Description of monument and accessories set to perpetuate the corner position.
4. Sketch of corner, show all pertinent data which can best be shown in a sketch example, corner marking, topography ties, position of accessories,
5. Certification must be signed and sealed by Land Surveyor registered in the State of Montana.

CERTIFIED CORNER RECORDATION

Corner: Section Corner: Sections 3, 4, 33 & 34 T. 25N & 26N. R. 29W. P.M.M. Lincoln County
1903 GLO Record: Set limestone and established 4 bearing trees.

1978 BLM Record: Found original stone; from which:
Original bearing trees
A 28" pine snag, bears N17°E, 33 lks (21.8 ft.), marked T26N R29W S34 BT (GLO Record 20lks)
A 20" larch, bears S53°E, 91 lks (60.1 ft.), marked T25N R29W S3 BT
A 24" pine, bears N81 1/4°W, 17 lks (11.2 ft.), w/ partially visible scribe (GLO Record 31 lks)
Set iron post, 30" long, 2-1/2" dia., 22" in the ground, with brass cap. Buried orig. stone alongside post.
New bearing trees
A 6" pine, bears N81 1/2°E, 37 lks (24.4 ft.), marked T26N R29W S34 BT
A 6" pine, bears S17°E, 86 lks (56.8 ft.), marked T25N R29W S3 BT
Location poster, bears N18°E, 7 lks (4.6 ft.)

2006 Record: Found 3 1/4" brass cap on 2 1/2" pipe.
(Staples) Found 4 healthy bearing trees w/ bearing tags attached per 1978 BLM remonument.

2009 Found: We find a standard BLM monument with a 3 1/4" BLM brass cap, firmly set in good condition, 12" above the ground, marked as shown below, from which:
A 10" pine, bears N80 1/2°E, 24.4 ft., with visible scribing & BT tag "S80 1/2°W 24.4' KSI 8/07"
A 24" larch, bears S53°E, 60.1 ft., with visible scribing & BT tag "N53°W 60.0' KSI 8/07"
A 10" pine, bears S17°W, 56.8 ft., with partially visible scribing & BT tag "N17°E KSI 56.8' 8/07"
A 22" pine, bears N81 1/4°W, 17.8 ft., with overgrown blaze & BT tag "S81°E 17.8' KSI 8/07"
A 28" snag, bears N17°E, 21.8 ft. with visible scribing & BT tag "S17°W 33 lks JF/JS 11/3/60"
Steel posts bear North 2.0 feet and East 2.2 feet.

2009 Perpetuation: We paint red bands on the new bearing trees, and attached USFS signs 54-3 & 54-9.

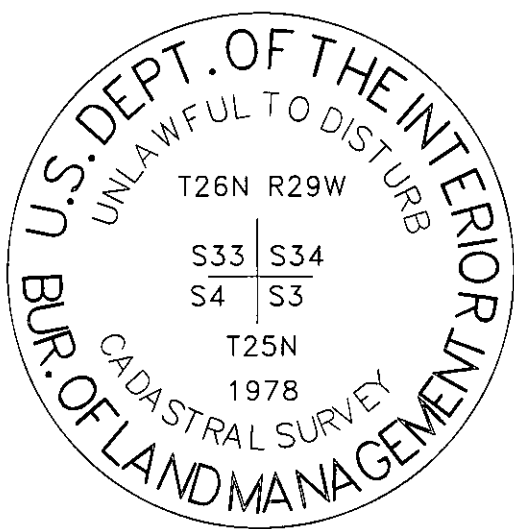

SKETCH OF CORNER

CERTIFICATION
I, Chad R. Breuer
certify the information shown herein is true and correct.

Signature Ground Party Chief

I, Ken E Jenkins
certify that this Corner Record correctly represents work performed by me or under my direction in compliance with the "Corner Recordation Act" (70-22-101, et seq., M.C.A.)

Signature of Surveyor

Date: 9/2009 Reg. No. 9330 LS

Employer: Montana Northwest Company

PO Box 8777, Missoula, MT 59807

406-721-4033 Project No. 1617-09

Office of Clerk and Recorder, County of _____ This "corner

record" was filed for record on 224873 BOOK: CCR CC&R'S PAGE: 11499 Pages: 1
was noted on the cross-index plat STATE OF MONTANA LINCOLN COUNTY
book No. RECORDED: 03/05/2010 9:41 KOI: CC&R'S

TAMMY D. LAUER CLERK AND RECORDER

FEE: \$0.00

TO: MONTANA NORTHWEST COMPANY P.O. BOX 8777, MISSOULA, MONTANA

Cross Index No. A-13 T. 25N R. 29W PMM

Sec. 3

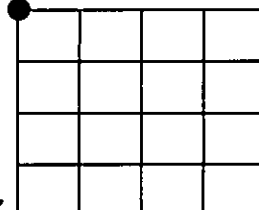

● Corner this sheet