

CERTIFIED CORNER RECORDATION

Corner Sec. Cor. Sec. NW S10 T. 25N R. 29W P.M., MT Lincoln County

- I. 1916 G.L.O. Original Record by Frank Walters et. al.: Set a slatestone, 16x12x6 ins., 10 ins. in the ground, for cor. of secs. 3, 4, 9 and 10, mkd. with 3 notches on the East and 5 notches on the South edges. Established four bearing trees.
- II. No evidence of original stone found. Found three bearing trees,
from which:
A fir, 26 ins. diam., bears N30°E, 211.2 ft. dist., with visible scribe. (GLO-record-N36°E)
No bearing trees found in S10.
Rotten remains, bears S55°W, 83.8 ft. dist., with partial scribe. (GLO-record)
A rotten stump, bears N13°W, 225.7 ft. dist., possible partial face, with no visible scribing. (GLO-record)
- III. Set by distance-distance intersect, from found bearing trees, a 2 1/2 in. diam. x 30 ins. long aluminum pipe, 25 ins. in the ground, with a 3 1/4 in. diam. aluminum cap, mkd. as shown:

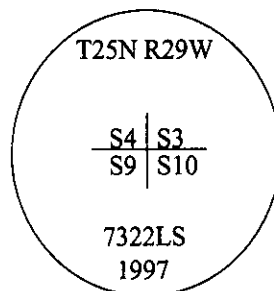

Established three new bearing trees:

- A fir, 12 ins. diam., bears S33°E, 12.1 ft. dist., mkd. "T25N R29W S10 BT".
- A fir, 11 ins. diam., bears S86°W, 13.0 ft. dist., mkd. "T25N R29W S9 BT".
- A fir, 11 ins. diam., bears N28°W, 5.1 ft. dist., mkd. "T25N R29W S4 BT".

Painted bearing trees and attached Land Survey Monument and Bearing Tree signs.

Magnetic Declination: 20° East.

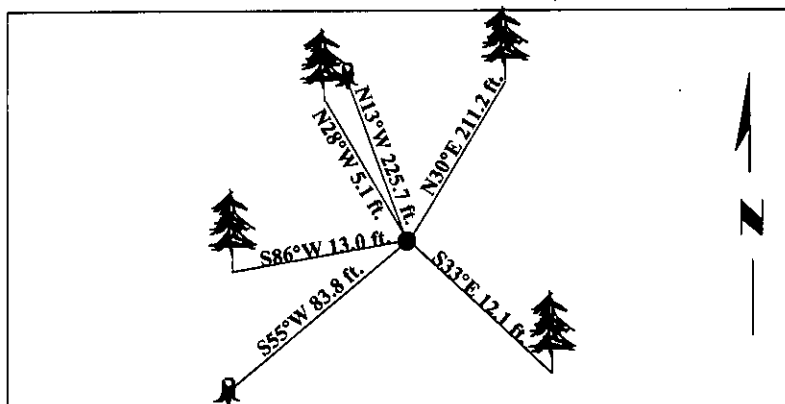

SKETCH OF CORNER

CERTIFICATION	
I, <u>Jeff Hintz</u>	certify the information shown herein is true and correct.
I, <u>Alvah F. Hughes</u>	
certify that this Corner Record correctly represents work performed by me under my direction in compliance with the "Corner Recordation Act", (70-22-101, et seq., M.C.A.)	
Signature of Surveyor	<u>Alvah F. Hughes</u>
Date:	<u>10/20/97</u>
Reg. No.:	<u>7322LS</u>
Employer:	<u>U.S. FOREST SERVICE</u>

Office of Clerk and Recorder, County of Lincoln. This "corner record" was filed for record on 12-26-97 was noted on the cross-index plat and is assigned page No. 10038 in book No. _____
Coral M. Cummins & PLS
County Official

Sec. 10

● - corner this sheet