

INSTRUCTIONS

1. Original and/or subsequent record used to evaluate the corner position.
2. Description of evidence found, note discrepancies in the record, state method of establishing lost or obliterated corners.
3. Description of monument and accessories set to perpetuate the corner position.
4. Sketch of corner, show all pertinent data which can best be shown in a sketch example, corner marking, topography ties, position of accessories, etc.
5. Certification must be signed and sealed by Land Surveyor registered in the State of Montana.
6. Fill in Cross Index & Section Diagram at bottom of sheet.

CERTIFIED CORNER RECORDATION

Corner SE Sec. Cor. of S7 T. 25 N. R. 28 W. P.M.M. Lincoln County

- I. 1903 G.L.O. record by C. Albee et al: Set a sandstone, 12x10x5 ins., 8 ins. in the ground, for cor. of secs. 7, 8, 17, and 18, mkd. with 4 notches on the S and 5 notches on the E edges, from which
- A tamarack, 10 ins. diam., bears N9°10'E, 18 lks. (11.88 ft.) dist., mkd. T25N R28W S8 BT.
 - A tamarack, 26 ins. diam., bears S54°05'E, 23 lks. (15.18 ft.) dist., mkd. T25N R28W S17 BT.
 - A tamarack, 10 ins. diam., bears S40°50'W, 40 lks. (26.40 ft.) dist., mkd. T25N R28W S18 BT.
 - A tamarack, 10 ins. diam., bears N36°10'W, 20 lks. (13.20 ft.) dist., mkd. T25N R28W S7 BT.
- II. Found a 8x6 ins. stone, firmly set, protruding 6 ins. out of the ground, with 4 notches on the S face and 5 notches on E face.
- From which:
- A larch, 15 ins. diam., bears N11°E, 11.7 ft. dist., visible scribing.
 - A larch stump, 28 ins. diam., bears S52°E, 15.5 ft. dist., visible scribing.
 - A fallen larch, 14 ins. diam., bears S46°W, 27.8 ft. dist., visible scribing
 - A larch, 13 ins. diam., bears N37°W, 12.9 ft. dist., visible scribing.
- III. At the corner position, set a 2 1/2 ins. diam. aluminum pipe, 30 ins. long, 22 ins. in the ground with a 3 1/4 ins. aluminum cap mkd. as shown:

T25N R28W
S7 | S8
S18 | S17
7322LS
1990

Bury original stone alongside monument.

Established two new bearing trees:

- A subalpine fir, 9 ins. diam., bears S16°E, 4.7 ft. dist., mkd. T25N R28W S17 BT.
- A larch, 18 ins. diam., bears S80°W, 29.7 ft. dist., mkd. T25N R28W S18 BT.

Painted red bands around the bearing trees and attached Land Survey Monument and Bearing Tree signs.
Set a 6 ft. galvanized steel guard post with Land Survey Marker and Property Boundary decals, South, 3 ft.
Magnetic Declination: 20° East

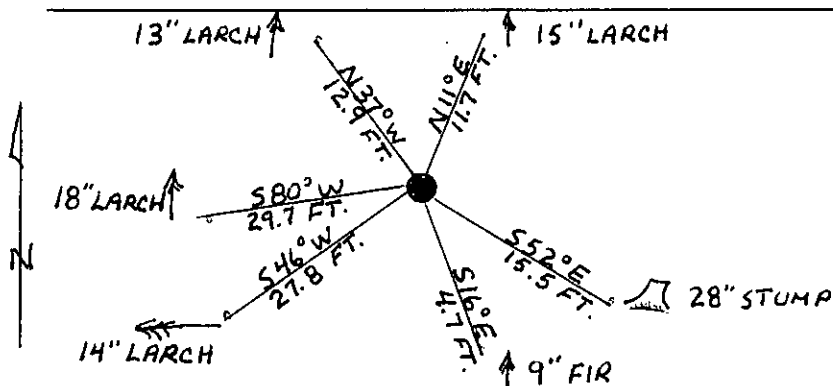

SKETCH OF CORNER

CERTIFICATION

I, Kevin A. Todd
certify the information shown herein is true and correct.
Kevin A Todd
Signature Ground Party Chief

I, Alvah F. Hughes
certify that this Corner Record correctly represents work performed by me or under my direction in compliance with the "Corner Recordation Act" (70-22-101, et seq., M.C.A.)
Alvah F. Hughes
Signature of Registered Professional Land Surveyor

Date: 1/8/91 Reg. No. 7322LS
Employer: U.S. FOREST SERVICE

Office of Clerk and Recorder, County of Lincoln. This "corner record" was filed for record on 1-10-91 was noted on the cross-index plat and is assigned page No. 4493, in book No. Coral M Cummings by Bill Buckhoff

County Official

J-5 25 N 28 W
Cross Index No. T. R. PMM

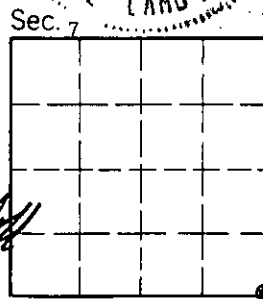

• - corner this sheet