

INSTRUCTIONS

1. Original and/or subsequent record used to evaluate the corner position.
2. Description of evidence found, note discrepancies in the record, state method of establishing lost or obliterated corners.
3. Description of monument and accessories set to perpetuate the corner position.
4. Sketch of corner, show all pertinent data which can best be shown in a sketch example, corner marking, topography ties, position of accessories, etc.
5. Certification must be signed and sealed by Land Surveyor registered in the State of Montana.
6. Fill in Cross Index & Section Diagram at bottom of sheet.

CERTIFIED CORNER RECORDATION

Corner N. 1/4 of S18 T. 25 N. R. 28 W. P.M.M. Lincoln County

I. 1903 G.L.O. record by C. Albee et al: Set a stone and two bearing trees.

1978 BLM remonumentation: The 1/4 sec. cor. of secs. 7 and 18, monumented with a limestone, 12x10x8 ins., firmly set 8 ins. in the ground, mkd. 1/4 on the N face, and witnessed by the remains of the original BTs.

A larch stump, 20 ins. diam., bears N14° E, 60 lks. (39.60 ft.) dist., with the decayed remains of a larch, lying alongside.

A larch stump, 12 ins. diam., bears S20° E, 72 lks. (47.52 ft.) dist., with the decayed remains of a larch, lying alongside.

At the corner point, set an iron post, 30 ins. long, 2 1/2 ins. diam., 22 ins. in the ground, with brass cap mkd.

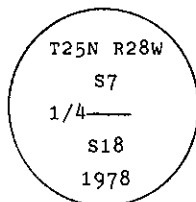

from which new bearing trees:

A larch, 9 ins. diam., bears N43 1/2° E, 26 lks. (17.16 ft.) dist., mkd. 1/4 S7 BT.

A pine, 7 ins. diam., bears S8 1/2° W, 34 lks. (22.44 ft.) dist., mkd. 1/4 S18 BT.

Bury original stone alongside iron post.

II. Found a 2 1/2 ins. diam. pipe, 12 ins. out of the ground, with BLM brass cap mkd. as shown, from which

A larch, 12 ins. diam., bears N44° E, 17.3 ft. overgrown blaze.

A lodgepole pine, 8 ins. diam., bears S8° W, 22.5 ft. dist., visible scribing.

III. Painted red bands around the bearing trees and attached Land Survey Monument and Bearing Tree signs.

Set a 6 ft. galvanized steel guard post with Land Survey Marker and Property Boundary decals, West, 3 ft. Magnetic Declination: 20° East

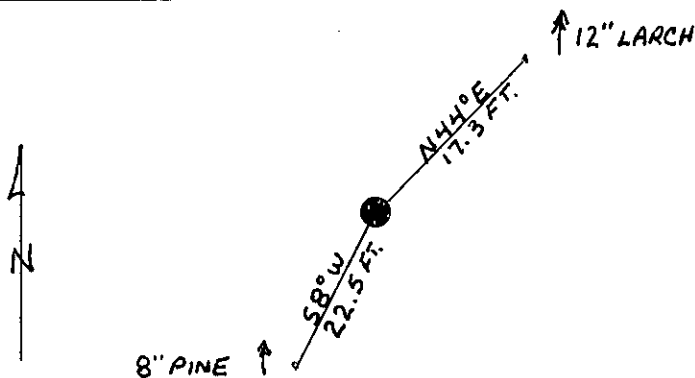

SKETCH OF CORNER

CERTIFICATION

I, Kevin A. Todd
certify the information shown herein is true and correct.

Kevin A. Todd
Signature Ground Party Chief

I, Alvah F. Hughes
certify that this Corner Record correctly represents work performed by me or under my direction in compliance with the "Corner Recordation Act" (70-22-101, et seq., M.C.A.)

Alvah F. Hughes
Signature of Surveyor of State

Date: 1/8/91 Reg. No. 7322

Employer: U.S. FOREST SERVICE

Office of Clerk and Recorder, County of Lincoln. This "corner

record" was filed for record on 1-10-91

was noted on the cross-index plat and is assigned page No. 4486, in

book No. _____

Coral M. Cummings by Bill Bruckhoff
County Official

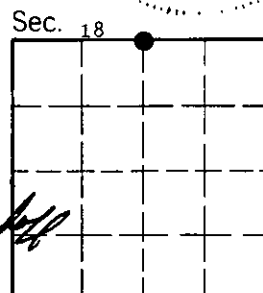

• - corner this sheet

J-3 25 N 28 W
Cross Index No. _____ T. _____ R. _____ PMM