

INSTRUCTIONS

1. Original or duplicate record used to locate the corner position.
2. Description of evidence found, and note discrepancies in the record, state method of establishing lost or obliterated corners.
3. Description of monument and accessories set to perpetuate the corner position.
4. Sketch of corner, show all pertinent data which can best be shown in a sketch example, corner marking, topography lines, position of accessories, etc.
5. Certification must be signed and sealed by Registered Land Surveyor in State of Montana.
6. Fill in Cross Index & Section Diagram at bottom of sheet.

CERTIFIED CORNER RECORDATION

Corner N¹/₄ Corner Sec. 6 T. 25N R. 28W P.M.M. Lincoln County

1. From B.L.M. notes, subject to correction & approval, dated 1978:

Limestone 18 X 10 X 5 inches., firmly set 14 inches in the ground, marked $\frac{1}{4}$ on North face, and witnessed by the remains of the original bearing trees:
 A rotted Fir stump, 18 inches diameter, bears S42 3/4° E 26 links distance marked $\frac{1}{4}$ S31 B.T.
 At the corner point set an iron post, 30 inches long, 2 1/2 inches diameter, 22 inches in the ground, with brass cap marked.

T26N., R. 28W
 S31
 $\frac{1}{4}$ ———
 S6
 T25N
 1978

From which new bearing trees:

A Larch 9 inches diameter, bears S77 1/2° E 32 links distance, marked $\frac{1}{4}$ S6 B.T.
 A Larch 10 inches diameter, bears N32 1/2° W., 43 links distance, marked $\frac{1}{4}$ S31 B.T.

2. Found: BLM., Brass capped, monument (marked as shown below).

From which A 10 inch Larch bears N32°30'W 28.4 feet
 A 10 inch Larch bears S 77°30'E 21.1 feet.

Each tree posted, blazed and scribed as stated above.

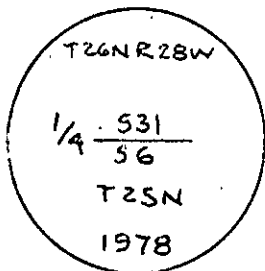

Found BLM, brass capped monument, marked as shown.

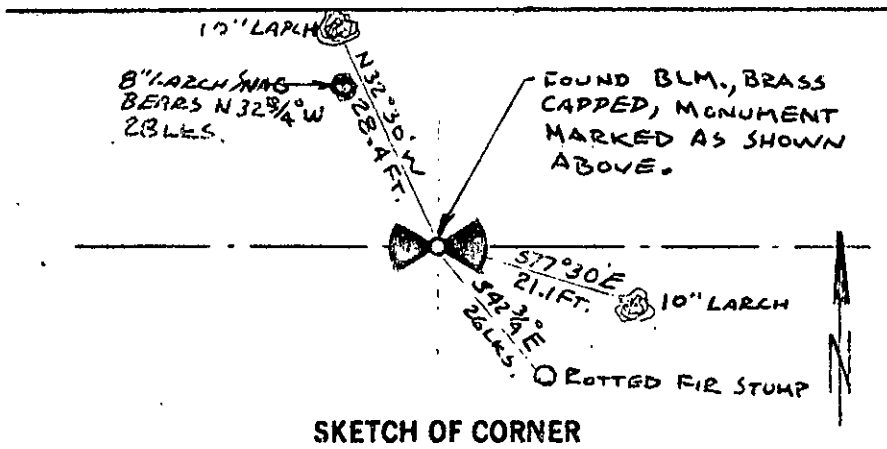

SKETCH OF CORNER

CERTIFICATION
 I, David Stanley
 certify the information shown herein is true and correct.
 Signature General Party
 I, Jack H. Ninneman
 certify that this Corner Record correctly represents work performed by me or under my direction in compliance with the "Corner Recordation Act" (70-22-101, et seq., M.C.A.)
Jack H. Ninneman
 Signature of Surveyor & Seal
 Date: 5/23/82 Reg. No. 4661S
 Employer: Ninneman Engineering

Office of Clerk and Recorder, County of Lincoln This "corner record" was filed for record on the June 17th day of 1982 was noted on the cross-index plat and is assigned page No. 1705, in book No. _____

Everanor L. Vaughan by Betty L. Conces,
 County Official Deputy

Cross Index No. A-3 T. 25N R. 28W P.M.M.

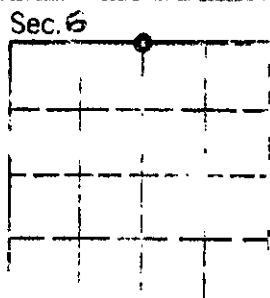

• - corner this sheet