

## INSTRUCTIONS

1. Original and/or subsequent record used to evaluate the corner position.
2. Description of evidence found, note discrepancies in the record, state method of establishing lost or obliterated corners.
3. Description of monument and accessories set to perpetuate the corner position.
4. Sketch of corner, show all pertinent data which can best be shown in a sketch example, corner marking, topography ties, position of accessories, etc.
5. Certification must be signed and sealed by Registered Land Surveyor in State of Montana.
6. Fill in Cross Index & Section Diagram at bottom of sheet.

## CERTIFIED CORNER RECORDATION

Corner West 1/4 Corner Section 6 T. 25N R. 28W P.M.M. Lincoln County

1. From B.L.M. notes, subject to correction and approval, dated 1978:

Sandstone 12 X 12 X 8 inches, firmly set 8 inches in the ground, marked 1/4 on the West face, and witnessed by the remains of the original bearing trees:

A Larch stump, 10 inches diameter, bears S70°E., 82 links distance, with no visible marks.

A Fir 24 inches diameter bears N58 3/4°W., 45 links distance, with B.T. visible on partially overgrown blaze.

Set an iron post 30 inches long 2 1/2 inches diameter, 22 inches in the ground with brass cap marked

T25N  
R29N., R28W  
1/4  
S1 | S6  
1978

From which a new bearing tree:

A Fir 11 inches diameter, bears East 83 links distance, marked 1/4 S6 B.T. bury the original stone alongside and raise a flat mound of stone 3 feet diam. around post.

2. Found: GLO, brass capped, monument (marked as shown below) from which

A Fir 30" diameter bears N 58 3/4°W 29.1 feet.

A Fir 12" diameter bears S 24°30'W 26.4 feet.

A Fir snag 8" diameter bears east 54.8 feet.

Each tree posted, blazed and scribed as stated above.

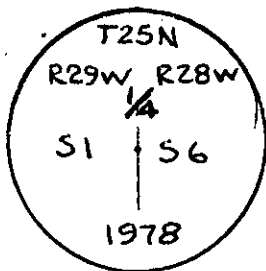

Found GLO, brass capped monument, marked as shown.

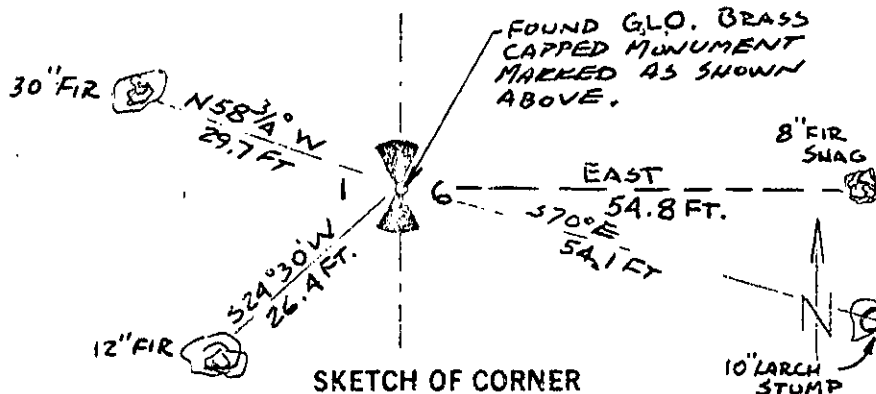

SKETCH OF CORNER

## CERTIFICATION

David Stanley

I certify the information shown herein to be true and correct.

Signature of David Stanley

1. Jack H. Ninneman

I certify that this Corner Record correctly represents work performed by me or under my direction in compliance with the "Corner Recordation Act" (70-22-101, et seq., M.D.A.)

Jack H. Ninneman  
Signature of Surveyor & Seal

Date: 5/24/82 Reg. No. 4661S

Employer: Ninneman Engineering Inc.

Office of Clerk and Recorder, County of Lincoln. This "corner record" was filed for record on the 17th June day of 1982 was noted on the cross-index plat and is assigned page No. 1703, in book No. 1

Eleanor L. Taughen by Betty L. Conces  
County Official Deputy

Sec. 6

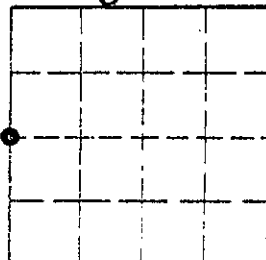

C-1 T. 25N., R. 28W., P.M.M.