

CERTIFIED CORNER RECORDATION

Corner CNNS 1/256 S4 T. 25 N. R. 28 W. P.M.M. Lincoln County

I. Record: None

II. Found: No record monuments found.

III. Perpetuation: At the corner point, determined by survey, set a 5/8 ins. diam. steel rebar 30 ins. long, 29 ins. in the ground, with a 3 1/4 ins. diam. Aluminum cap marked as shown below from which:

A pine, 7 ins. diam., bears N41°E, 26.20 ft. dist., scribed CNNS 1/256 S4 BT.

A fir, 19 ins. diam., bears N72°W, 27.20 ft. dist., scribed CNNS 1/256 S4 BT.

Painted faces and 6 in. wide red bands to all bearing trees and attached Land Survey Monument and Bearing Tree signs.

Set steel posts on line 1.20 ft. North and 2.00 ft. East of set monument with attached Survey Monument and Property Line stickers.

Magnetic declination: 18° East

Equipment used: Hand compass and loggers tape

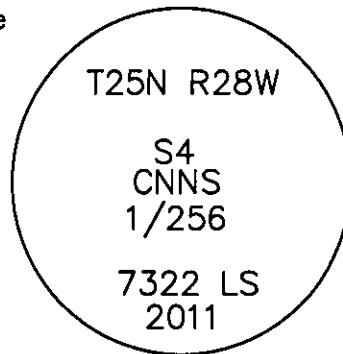

Note: See Certificate of Survey No. 4121 Lincoln County Records for additional survey information.

Kootenai Surveyors Inc., 314 California Av., Libby, MT. 59923 (406) 293-4354

PCTC Upper McGinnis 2011

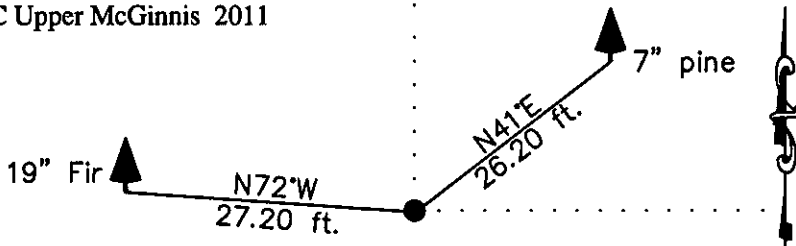

SKETCH OF CORNER

CERTIFICATION

Kelly Rooney

I, Kelly Rooney, certify the information shown herein is true and correct.

Signature Ground Party Chief

Alvah F. Hughes

I, Alvah F. Hughes, certify that this Corner Record correctly represents work performed by me or under my direction in compliance with the "Corner Recordation Act" (70-221-107, et seq., M.C.A.)

Signature of Surveyor & Seal

Date: 11/1/2011 Reg. No. 7322-LS

Employer: Kootenai Surveyors Inc.

Office of Clerk and Recorder, County of Lincoln This "corner

record" was filed for record on

was noted on the cross-index book No. _____

236205 BOOK: CCR CC&R'S PAGE: 11937 Pages: 1
STATE OF MONTANA LINCOLN COUNTY
RECORDED: 12/01/2011 2:40 KOI: CC&R'S
TAMMY D. LAUER CLERK AND RECORDER
FEE: \$0.00 BY: Deanna Lauer Deputy
TO: KOOTENAI SURVEYORS INC. P.O. BOX 393, LIBBY, MT 59923

Sec. 4

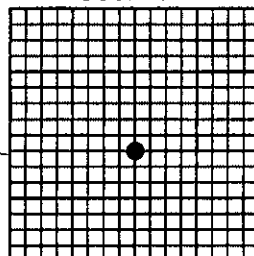

• corner this sheet

Cross Index No. _____ T. 25N R. 28W P.M., MT

Adopted July 1, 1981, Montana Board of Professional Engineers & Land Surveyors