

CERTIFIED CORNER RECORDATION

Corner CSNESE 1/256 S4 T. 25 N. R. 28 W. P.M.M. Lincoln County

I. Record: None

II. Found: No record monuments found.

III. Perpetuation: At the corner point, determined by survey, set a 5/8 ins. diam. steel rebar 30 ins. long, 27 ins. in the ground, with a 3 1/4 ins. diam. Aluminum cap marked as shown below from which:

A Larch, 8 ins. diam., bears S24°E, 16.30 ft. dist., scribed CSNESE 1/256 S4 BT.

A Fir, 10 ins. diam., bears N26°W, 18.30 ft. dist., scribed CSNESE 1/256 S4 BT.

Painted faces and 6 in. wide red bands to all bearing trees and attached Land Survey Monument and Bearing Tree signs.

Set steel posts on line 3.25 ft. South and 2.80 ft. West of set monument with attached Survey Monument and Property Line stickers.

Magnetic declination: 18° East

Equipment used: Hand compass and loggers tape

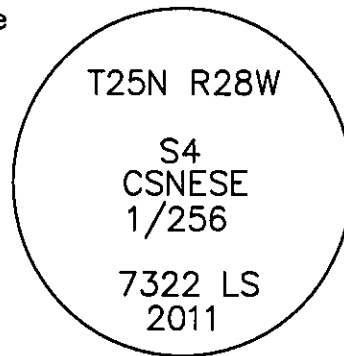

Note: See Certificate of Survey No. 4121 Lincoln County Records for additional survey information.

Kootenai Surveyors Inc., 314 California Av., Libby, MT. 59923 (406) 293-4354

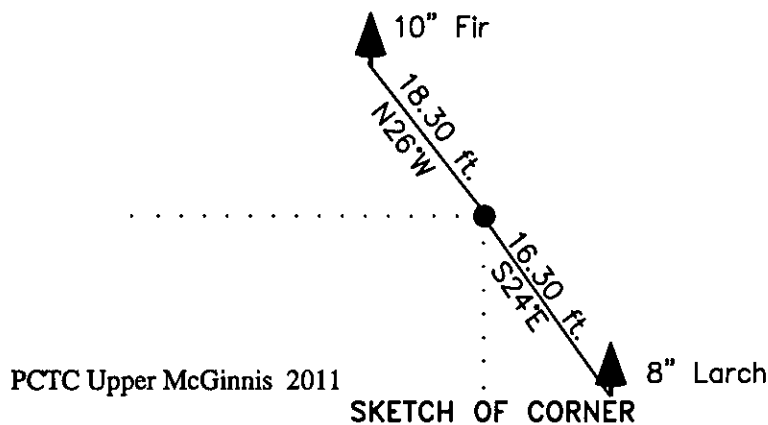

CERTIFICATION

I, Kelly Rooney
certify the information shown herein is true and correct.
Kelly Rooney
Signature Ground Party Chief

I, Alvah F. Hughes
certify that this Corner Record correctly represents work performed by me or under my direction in compliance with the "Corner Recordation Act" (70-22-103 et seq., M.C.A.)
Alvah F. Hughes
Signature of Surveyor & Seal

Date: 10/28/2011 Reg. No. 7322-LS
Employer: Kootenai Surveyors Inc.

Office of Clerk and Recorder, County of Lincoln. This "corner

record" was filed for record on 236199 BOOK: CCR CC&R'S PAGE: 11931 Pages: 1

was noted on the cross STATE OF MONTANA LINCOLN COUNTY
book No. RECORDED: 12/01/2011 2:10 KOI: CC&R'S

TAMMY D. LAUER CLERK AND RECORDER

FEE: \$0.00

TO: KOOTENAI SURVEYORS INC. P.O. BOX 393, LIBBY, MT 59923

Cross Index No. BY: *Tammy D. Lauer* T. 25N R. 28W P.M., MT

Adopted July 1, 1981, Montana Board of Professional Engineers & Land Surveyors

Sec. 4

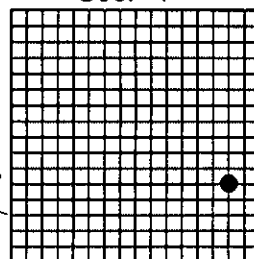

• corner this sheet