

**LEGAL DESCRIPTION: PARCEL C**

A tract of land, southerly from Libby, Montana, Lincoln County, and lying within the SW1/4NE1/4, Section 10, T.28N., R.30W., P.M.MT., and more particularly described as follows: Commencing at the CN1/16 Corner, Section 10, a 3 1/4 inch diameter aluminum cap marked 9958LS and the TRUE POINT OF BEGINNING: Thence S00°13'53"E, 1315.03 feet to the C1/4 Corner said section, a 3 1/4 inch diameter aluminum cap marked 9958LS; Thence N89°39'20"E, 702.83 feet to a 5/8 inch diameter rebar with plastic cap marked SANDERSON 70400LS lying on the westerly right-of-way limit of a 60.00 foot wide National Forest Systems Road #6202; Thence leaving said right-of-way limit N89°39'20"E, 54.55 feet to an unmarked computed point lying on the centerline of said road; Thence along said centerline the following eight courses: Thence through a curve to the right, Delta 39°07'07", Radius 466.54 feet, arc length 318.53 feet to an unmarked computed point; Thence N21°56'28"W, 116.16 feet to an unmarked computed point; Thence N31°25'22"W, 208.71 feet to an unmarked computed point; Thence N32°30'19"W, 99.34 feet to an unmarked computed point; Thence through a curve to the right, Delta 17°47'01", Radius 522.31 feet, arc length 162.12 feet to an unmarked computed point; Thence N18°21'07"W, 159.46 feet to an unmarked computed point; Thence N16°39'23"W, 290.10 feet to an unmarked computed point; Thence through a curve to the right, Delta 21°35'25", Radius 341.00 feet, arc length 128.50 feet to an unmarked computed point; Thence leaving said centerline S89°40'32"W, 30.19 feet to a 5/8 inch diameter rebar with plastic cap marked SANDERSON 70400LS lying on the westerly right-of-way limit of a 60.00 foot wide National Forest Service Road #6202; Thence leaving said right-of-way limit S89°40'32"W, 113.83 feet to a 3 1/4 inch diameter aluminum cap marked 9958LS and the TRUE POINT OF BEGINNING, containing 11.07 acres. Subject to and together with all appurtenant easements of record.

# CERTIFICATE OF SURVEY

## "BOUNDARY LINE ADJUSTMENT"

TRACT 4D, SE1/4 NW1/4, TRACT 4E SW1/4 NE1/4

SECTION 10, T.28N., R.30W., P.M., MT.

FOR: DANIEL & CHRISTINA HALVORSON

DATE: MAY, 2021

MATTHEW & BRIDGET FULK

**PURPOSE OF SURVEY AND OWNER'S EXEMPTION**  
We, Daniel and Christina Halvorson, and Matthew and Bridget Fulk, record owners, hereby certify that the purpose of this survey and division of land is the relocation of common boundaries pursuant to MCA 76-3-207(2)(c) "division made outside of platted subdivisions for the purpose of relocating common boundary lines between adjoining properties". We further certify that Parcels A & B are 20 acres or greater, exclusive of public roadways, and is therefore not subject to sanitation review by the Department of Environmental Quality pursuant to MCA 76-4-102(22).

*[Signature]* Daniel Halvorson 8-27-21  
*[Signature]* Christina Halvorson 8-27-21  
*[Signature]* Matthew Fulk 8-27-21  
*[Signature]* Bridget Fulk 8-27-21

**ACKNOWLEDGMENT**  
The foregoing Exemptions were subscribed and acknowledged before me a Notary Public

for the State of MT County of Lincoln  
 by Daniel and Christina Halvorson  
 on this 27 day of August, 2021  
 In witness whereof, I have hereunto set my hand and affixed my notarial seal.  
*[Signature]*  
 residing in: Libby MT My Commission expires: 1/23/23

**ACKNOWLEDGMENT**  
The foregoing Exemptions were subscribed and acknowledged before me a Notary Public

for the State of MT County of Lincoln  
 by Matthew and Bridget Fulk  
 on this 27 day of August, 2021  
 In witness whereof, I have hereunto set my hand and affixed my notarial seal.  
*[Signature]*  
 residing in: Libby MT My Commission expires: 11/30/23

**HISTORY OF SURVEY**  
 1989 - COS No. 1736, Occasional Sale, Thomas Sands, 7975S  
 1993 - COS No. 2151, Dependent Resurvey and Partial Subdivision  
 James R. Staples, 9958LS

**BASIS OF BEARING**  
 The basis of bearing for this survey is S89°39'57"W, derived from Survey Grade GPS system calibrated to local control between the NW 1/16 corner, Section 10, a found 3 1/4 inch diameter aluminum cap marked 9958LS and the CN 1/16 corner, a found 3 1/4 inch diameter aluminum cap marked 9958LS. Angular variation between this survey and COS No. 2151 is 0°24'56".

**METHOD OF SURVEY**  
 A Trimble R10 GNSS GPS system were used with RTK radial procedures to tie the previously set controlling corners and road alignments by Eric Stafford and Brendan Hunter, April, 2021.

**LAND SURVEYOR'S CERTIFICATION**  
 I hereby certify that I am a Registered Land Surveyor in the State of Montana, that the survey shown on this "Certificate of Survey" has been prepared under my supervision and in accordance with the Montana Code Annotated, Sections 76-3-207(2)(c) 76-3-625, and the Lincoln County Regulations adopted pursuant thereto.  
*[Signature]* Byron Sanderson 70400LS 8-10-21  
 Byron Sanderson, PLS, 70400LS

**EXAMINING LAND SURVEYOR'S CERTIFICATION**  
 Examined this day 21 of September, 2021, A.D.  
*[Signature]* Steven A. Boyer, PLS 9750LS  
 Steven A. Boyer, PLS, Lincoln County, Examining Land Surveyor

**COUNTY TREASURER'S CERTIFICATION**  
 I hereby certify that all real property taxes and special assessments assessed and levied on the parcel shown hereon are paid pursuant to Section 76-3-207(3), M.C.A.

Lincoln County Treasurer \_\_\_\_\_ Date \_\_\_\_\_

**CLERK AND RECORDER'S CERTIFICATION**  
 State of Montana, County of Lincoln, filed this 13<sup>th</sup> day of September, 2021, A.D. at 2:57 o'clock  
*[Signature]* Robin A. Benson by *[Signature]* Michelle Boyd  
 Lincoln County Clerk and Recorder \_\_\_\_\_ Deputy

CERTIFICATE OF SURVEY No. 4803 RB

NATIONAL FOREST SYSTEM LANDS BASIS OF BEARING  
 (N89°54'41"E 1313.32')  
 (S89°39'57"W 1313.66')

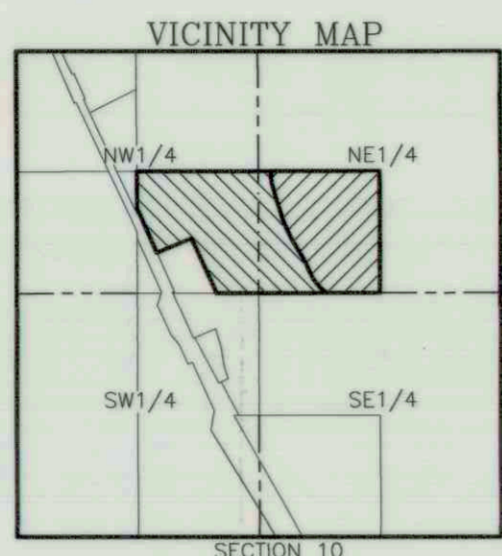

PARCEL A  
 (Includes Parcel C)  
 41.74 Acres

PARCEL C  
 11.07 Acres

PARCEL B  
 28.66 Acres

**LEGEND**

- FOUND 3 1/4 INCH DIAMETER ALUMINUM CAP MARKED 9958LS
- FOUND 1/2 INCH DIAMETER REBAR WITH PLASTIC CAP MARKED SANDS 7975S
- SET 5/8 INCH DIAMETER REBAR WITH PLASTIC CAP MARKED SANDERSON 70400LS
- COMPUTED POINT
- NEW BOUNDARY LINE
- ADJOINING BOUNDARIES
- - - SECTION SUBDIVISION LINE
- - - EASEMENT LIMITS
- - - CENTERLINE ROAD
- - - OLD BOUNDARY LINE
- ( ) COS No. 2151, RECORD
- [ ] COS No. 1736, RECORD

**LEGAL DESCRIPTION: PARCEL A**

A tract of land, southerly from Libby, Montana, Lincoln County, and lying within the SE1/4NW1/4 and the SW1/4NE1/4, Section 10, T.28N., R.30W., P.M.MT., and more particularly described as follows: Commencing at the CN1/16 Corner, Section 10, a 3 1/4 inch diameter aluminum cap marked 9958LS and the TRUE POINT OF BEGINNING: Thence S89°39'57"W, 1313.66 feet to the NW1/16 Corner said section, a 3 1/4 inch diameter aluminum cap marked 9958LS; Thence S00°20'01"E, 447.68 feet to a 5/8 inch diameter rebar with plastic cap marked SANDERSON, 70400LS lying on the easterly right-of-way limit of US Highway No. 2; Thence along said right-of-way limit S24°47'40"E, 487.39 feet to a 1/2 inch diameter rebar with plastic cap marked SANDS, 7975S; Thence leaving said right-of-way limit N65°11'50"E, 393.73 feet to the north east corner Tract 1, COS No. 1736 a 5/8 inch diameter rebar with plastic cap marked SANDS, 7975S lying on the north boundary of Tract 4F, Plat No. 2110; Thence along said boundary N89°45'33"E, 485.04 feet to the C1/4 Corner, Section 10 a 3 1/4 inch diameter aluminum cap marked 9958LS; Thence N89°39'20"E, 702.83 feet to a 5/8 inch diameter rebar with plastic cap marked SANDERSON 70400LS lying on the westerly right-of-way limit of a 60.00 foot wide National Forest Systems Road #6202; Thence leaving said right-of-way limit N89°39'20"E, 54.55 feet to an unmarked computed point lying on the centerline of said road; Thence along said centerline the following eight courses: Thence through a curve to the right, Delta 39°07'07", Radius 466.54 feet, arc length 318.53 feet to an unmarked computed point; Thence N21°56'28"W, 116.16 feet to an unmarked computed point; Thence N31°25'22"W, 208.71 feet to an unmarked computed point; Thence N32°30'19"W, 99.34 feet to an unmarked computed point; Thence through a curve to the right, Delta 17°47'01", Radius 522.31 feet, arc length 162.12 feet to an unmarked computed point; Thence N18°21'07"W, 159.46 feet to an unmarked computed point; Thence N16°39'23"W, 290.10 feet to an unmarked computed point; Thence through a curve to the right, Delta 21°35'25", Radius 341.00 feet, arc length 128.50 feet to an unmarked computed point; Thence leaving said centerline S89°40'32"W, 30.19 feet to a 5/8 inch diameter aluminum cap marked SANDERSON 70400LS lying on the westerly right-of-way limit of a 60.00 foot wide National Forest Service Road #6202; Thence leaving said right-of-way limit S89°40'32"W, 113.83 feet to a 3 1/4 inch diameter rebar with plastic cap marked 9958LS and the TRUE POINT OF BEGINNING, containing 41.74 acres. Subject to and together with all appurtenant easements of record.

**LEGAL DESCRIPTION: PARCEL B**

A tract of land, southerly from Libby, Montana, Lincoln County, and lying within the SW1/4NE1/4, Section 10, T.28N., R.30W., P.M.MT., and more particularly described as follows: Commencing at the NE1/16 Corner, Section 10, a 3 1/4 inch diameter aluminum cap marked 9958LS and the TRUE POINT OF BEGINNING: Thence S00°18'02"E, 1314.57 feet to the CE1/16 Corner said section, a 3 1/4 inch diameter aluminum cap marked 9958LS; Thence along the east-west mid-section line, Section 10, S89°39'20"W, 275.91 feet to a 5/8 inch diameter rebar with plastic cap marked SANDERSON, 70400LS lying on the easterly right-of-way limit of a 60.00 foot wide National Forest Systems Road #6202; Thence leaving said right-of-way limit S89°39'20"W, 283.81 feet to an unmarked computed point lying on the centerline of said road; Thence along said centerline the following eight courses: Thence through a curve to the right, Delta 39°07'07", Radius 466.54 feet, arc length 318.53 feet to an unmarked computed point; Thence N21°56'28"W, 116.16 feet to an unmarked computed point; Thence N31°25'22"W, 208.71 feet to an unmarked computed point; Thence N32°30'19"W, 99.34 feet to an unmarked computed point; Thence through a curve to the right, Delta 17°47'01", Radius 522.31 feet, arc length 162.12 feet to an unmarked computed point; Thence N18°21'07"W, 159.46 feet to an unmarked computed point; Thence N16°39'23"W, 290.10 feet to an unmarked computed point; Thence through a curve to the right, Delta 21°35'25", Radius 341.00 feet, arc length 128.50 feet to an unmarked computed point; Thence leaving said centerline N89°40'32"E, 30.22 feet to a 5/8 inch diameter rebar with plastic cap marked SANDERSON, 70400LS lying on the easterly right-of-way limit of a 60.00 foot wide National Forest Systems Road #6202; Thence leaving said right-of-way limit N89°40'32"E, 1141.26 feet to a 3 1/4 inch diameter aluminum cap marked 9958LS and the TRUE POINT OF BEGINNING, containing 28.66 acres. Subject to and together with all appurtenant easements of record.

**SURVEYORS NOTE**

The area that is being removed from one tract of record and joined with another tract of record is not a tract of record. Said area shall not be available as a reference legal description in any subsequent real property transfer after the initial transfer associated with this [certificate of survey or amended plat] on which said area is described, unless said area is included with or excluded from adjoining tracts of record.

**GRAPHIC SCALE**

