

# CERTIFICATE OF SURVEY

## "RETRACEMENT"

IRREGULAR PLAT 639

NE1/4 NE1/4, SECTION 8, T.30N., R.31W., P.M., MT.

LINCOLN COUNTY, MT.

FOR: ORSBORN DATE: JUNE, 2021

### VICINITY MAP

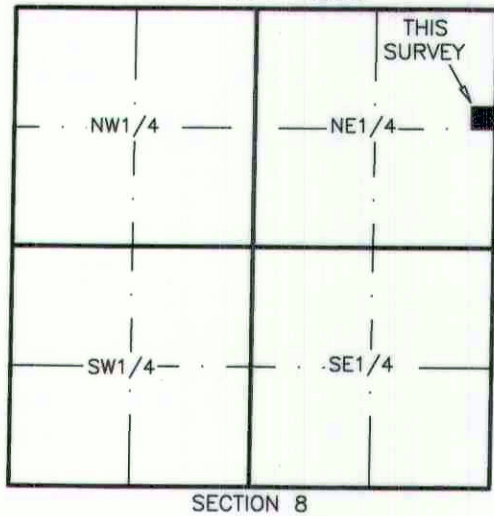

SECTION 8

### LEGEND

	SECTION CORNER, 3 1/4 INCH DIAMETER BLM BRASS CAP
	ONE-QUARTER CORNER, 3 1/4 INCH DIAMETER BLM BRASS CAP
	3 1/4 INCH DIAMETER ALUMINUM CAP MARKED HUGHES, 7322LS
	SET 5/8 INCH DIAMETER REBAR WITH BLUE PLASTIC CAP MARKED SANDERSON, 70400LS
	5/8 INCH DIAMETER REBAR WITH PLASTIC CAP MARKED HUGHES, 7322LS
	1 INCH DIAMETER UNMARKED PIPE
	COMPUTED POINT
	NEW BOUNDARY LINE ( ) PLAT No. 7223, RECORD
	ADJOINING BOUNDARIES [ ] PLAT No. 639, RECORD
	SECTION SUBDIVISION LINE { } PLAT No. 2011, RECORD
	EASEMENT LIMITS
	CENTERLINE ROAD
	EDGE OF ROAD

### PURPOSE OF SURVEY

The purpose of this survey is the retracement of record data and re-establishment of lost or obliterated corners. Therefore no division of land is hereby created and is exempt from review as a subdivision, pursuant to Section 76-3-404 MCA.

### HISTORY OF SURVEY

1960 - PLAT No. 639, Creation of Parcel, Jack Ninneman, 534ES  
1973 - PLAT No. 2011, Creation of Parcel, Jack Ninneman, 534ES  
2020 - COS No. 7223, "White Pine Subdivision", Alvah F. Hughes, 7322LS

### LEGAL DESCRIPTION, PLAT 639

An irregular tract of land lying south from Libby, MT, Lincoln County with the NE1/4 NE1/4, Section 8, Township 30 North, Range 31 West, P.M.M.T. and more particularly described as:  
Commencing at the north one-sixteenth corner, common to Sections 8 and 9, Township 30 North, Range 31 West, P.M.M.T., a 3 1/4 inch diameter aluminum monument marked HUGHES 7322LS and the TRUE POINT OF BEGINNING; Thence along the south line of the NE1/4 NE1/4, said Section 8 S89°35'02"W, 208.71 feet to a 5/8 inch diameter rebar with blue plastic cap marked SANDERSON 70400LS; Thence along a line parallel to the east section line, said Section 8, N00°14'27"E, 208.71 feet to a 5/8 inch diameter rebar with blue plastic cap marked SANDERSON 70400LS; Thence N89°35'02"E, 208.71 feet to a point lying on the east section line, said Section 8, a 5/8 inch diameter rebar with blue plastic cap marked SANDERSON 70400LS; Thence along the east section line, said Section 8, S00°14'27"W, 208.71 feet to a 3 1/4 inch diameter aluminum monument marked HUGHES 7322LS and the TRUE POINT OF BEGINNING, containing 1.00 acre. Subject to and together with all appurtenant easements of record.

### BASIS OF BEARING

The basis of bearing for this survey is N00°14'27"E between the N1/16 corner, Section 8, a 5/8 inch diameter rebar with plastic cap marked HUGHES, 7322LS and the NE Section Corner, Section 8, a found 3 1/4 inch diameter BLM brass cap. This bearing is derived from a survey grade GPS system calibrated to True North. Angular variation between this survey and Irregular Plat No. 639 is 00°14'27".

### METHOD OF SURVEY

A Trimble R10 GNSS GPS system were used with RTK radial procedures to tie the previously set controlling corners and road alignments by Eric Stafford and Brendan Hunter, April, 2021.

### LAND SURVEYOR'S CERTIFICATION

I hereby certify that I am a Registered Land Surveyor in the State of Montana, that the survey shown on this "Certificate of Survey" has been prepared under my supervision and in accordance with the Montana Code Annotated, Sections 76-3-101 through 76-3-625, and the Lincoln County Regulations adopted pursuant thereto.

Byron Sanderson, PLS, 70400LS  
Date: 6-8-21

### EXAMINING LAND SURVEYOR'S CERTIFICATION

Examined this day 9th of June, 2021, A.D.

Steven A. Boyer, PLS, 9750LS, Lincoln County Examining Land Surveyor

### CLERK AND RECORDER'S CERTIFICATION

State of Montana, County of Lincoln, filed this 9th day

of June, 2021, A.D. at 2:33 o'clock

Robin A. Benson by Michelle Byrd  
Lincoln County Clerk and Recorder Deputy

CERTIFICATE OF SURVEY No. 4782

