

CERTIFICATE OF SURVEY

"BOUNDARY LINE ADJUSTMENT"

IN GOV'T. LOTS 2 & 3
SECTION 30, T.31N., R.31W., P.M., MT.
LINCOLN COUNTY, MONTANA
FOR: BENEFIELD DATE: APRIL, 2021

VICINITY DIAGRAM

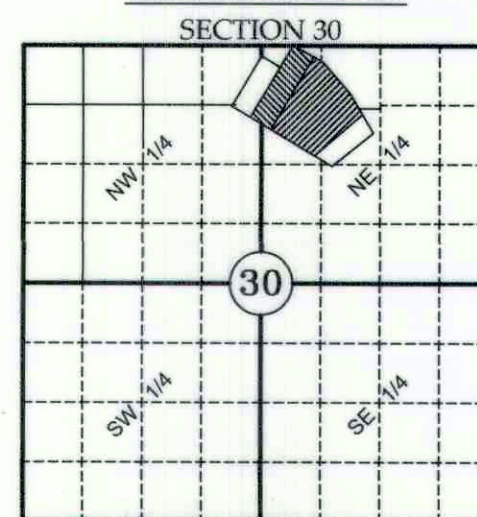

SURVEYORS NOTES

The area that is being removed from one tract of record and joined with another tract of record is not a tract of record. Said area shall not be available as a reference legal description in any subsequent real property transfer after the initial transfer associated with this certificate of survey on which said area is described, unless said area is included with or excluded from adjoining tracts of record.

LEGAL DESCRIPTION - PARCEL "A"

An irregular tract of land, lying northwesterly from Libby, Montana, Lincoln County, lying in Gov't. Lot 2, Section 30, T31N, R31W, P.M., MT., and more particularly described as:
Commencing at the southeasterly corner of Parcel "C", COS No. 4152FC, a 5/8 inch diameter rebar with plastic cap marked MDL, 4232S lying on the northerly Right-Of-Way Limit of the Burlington Northern Santa FE Railroad and The True Point of Beginning; Thence along said right-of-way limit N59°03'53"W, 292.93 feet to a set 5/8 inch diameter rebar with plastic cap marked SANDERSON, 70400LS; Thence N30°58'58"E, 450.14 feet to a set 5/8 inch diameter rebar with plastic cap marked SANDERSON, 70400LS as a witness corner; Thence N30°58'58"E, 254.11 feet to an unmarked computed point; Thence S59°18'02"E 59.22 feet to an unmarked computed point; Thence S49°27'58"E, 57.48 feet to an unmarked computed point; Thence S40°51'54"E, 129.32 feet to an unmarked computed point; Thence S30°30'00"E, 193.42 feet to an unmarked computed point; Thence S49°10'48"W, 60.00 feet to a 5/8 inch diameter rebar with plastic cap marked HUGHES, 7322LS as a witness corner; Thence S49°10'48"W, 470.57 feet to a 5/8 inch diameter rebar with plastic cap marked HUGHES, 7322LS marking a point on the northerly Right-Of-Way Limit of the Burlington Northern Santa FE Railroad; Thence along said limit N58°59'17"W, 127.50 feet to a 5/8 inch diameter rebar with plastic cap marked MDL, 4232S, and the True Point of Beginning, containing 7.51 acres more or less. Subject to a 15.00 foot wide well easement per COS No. 4152FC and together with all appurtenant easements of record.

LEGAL DESCRIPTION - PARCEL "B"

An irregular tract of land, lying northwesterly from Libby, Montana, Lincoln County, lying in Gov't. Lots 2 & 3, Section 30, T31N, R31W, P.M., MT., and more particularly described as:
Commencing at the southwesterly corner of Parcel "A", COS No. 873, a 5/8 inch diameter rebar with plastic cap marked MDL, 4232S lying on the northerly Right-Of-Way Limit of the Burlington Northern Santa FE Railroad and The True Point of Beginning; Thence N30°58'58"E, 444.87 feet to a 5/8 inch diameter rebar with plastic cap marked MDL, 4232S as a witness corner; Thence N30°58'58"E, 250.36 feet to an unmarked computed point; Thence S61°35'40"E 200.20 feet to an unmarked computed point; Thence S30°58'58"W, 254.11 feet to a set 5/8 inch diameter rebar with plastic cap marked SANDERSON, 70400LS as a witness corner; Thence S30°58'58"W, 450.14 feet to a set 5/8 inch diameter rebar with plastic cap marked SANDERSON, 70400LS marking a point on the northerly Right-Of-Way Limit of the Burlington Northern Santa FE Railroad; Thence along said limit N59°00'51"E, 200.00 feet to a 5/8 inch diameter rebar with plastic cap marked MDL, 4232S, and the True Point of Beginning, containing 3.21 acres more or less. Subject to and together with all appurtenant easements of record.

LEGAL DESCRIPTION - PARCEL "C"

An irregular tract of land, lying northwesterly from Libby, Montana, Lincoln County, lying in Gov't. Lot 2, Section 30, T31N, R31W, P.M., MT., and more particularly described as:
Commencing at the southwesterly corner of Parcel "C", COS No. 4152FC, a 5/8 inch diameter rebar with plastic cap marked MDL, 4232S lying on the northerly Right-Of-Way Limit of the Burlington Northern Santa FE Railroad and The True Point of Beginning; Thence N31°00'54"E, 546.29 feet to a 5/8 inch diameter rebar with plastic cap marked MDL, 4232S; Thence N31°00'54"E, 90.30 feet to an unmarked computed point; Thence S40°51'54"E 129.32 feet to an unmarked computed point; Thence S30°30'00"E, 193.42 feet to an unmarked computed point; Thence S49°10'48"W, 60.00 feet to a 5/8 inch diameter rebar with plastic cap marked HUGHES, 7322LS as a witness corner; Thence S49°10'48"W, 470.57 feet to a 5/8 inch diameter rebar with plastic cap marked HUGHES, 7322LS marking a point on the northerly Right-Of-Way Limit of the Burlington Northern Santa FE Railroad; Thence along said limit N58°59'17"W, 127.50 feet to a 5/8 inch diameter rebar with plastic cap marked MDL, 4232S, and the True Point of Beginning, containing 2.93 acres more or less.

LEGEND

- 5/8 inch diameter rebar with plastic cap marked "MDL 4232S"
- 5/8 inch diameter rebar with plastic cap marked "HUGHES 7322LS"
- Set 5/8 inch diameter rebar with plastic cap marked "SANDERSON 70400LS"
- 5/8 inch diameter rebar with plastic cap marked "KED 4975S"
- 1/2 inch diameter pipe with plastic cap marked "W&R 4232S"
- Unmarked computed point
- ** Record - Certificate of Survey No. 4152FC
- < > Record - Certificate of Survey No. 2246
- () Record - Certificate of Survey No. 1702
- [] Record - Certificate of Survey No. 873
- [] Record - Per GLO Notes
- Property boundary - this survey
- Section subdivision line
- Old Boundary - this survey
- Easement limits
- WC Witness Corner

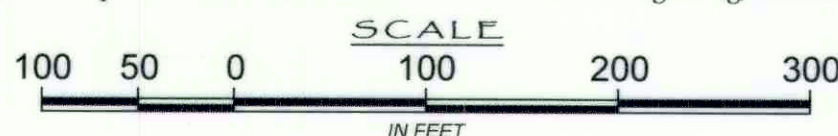

PURPOSE OF SURVEY AND OWNER'S EXEMPTION CERTIFICATIONS

I, **Gayla I. Benefield** owner of record, hereby certify that the purpose of this survey and division of land is the relocation of common boundaries pursuant to MCA 76-3-207(2)(a) "division made outside of platted subdivisions for the purpose of relocating common boundary lines between adjoining properties". Furthermore, Parcel "B" is exempt from review by the Montana Department of Environmental Quality pursuant to 17.36.605(2)(a): "a parcel that has no existing facilities for water supply, wastewater disposal, and solid waste disposal, if no new facilities will be constructed on the parcel." Also, Parcel "A" is exempt from sanitation review by the Montana Department of Environmental Quality pursuant to ARM 17.36.605(2)(c) a parcel that will be affected by a proposed boundary line adjustment, if the parcel has existing facilities for water supply, wastewater disposal, storm drainage, or solid waste disposal that were not subject to review, and have not been reviewed, under Title 76, chapter 4, part 1, MCA, and if: (i) no facilities, other than those in existence prior to the boundary line adjustment, or those that were previously approved as replacements for the existing facilities, will be constructed on the parcel; (ii) existing facilities on the parcel complied with state and local laws and regulations, including permit requirements, which were applicable at the time of installation; and (iii) the local health officer determines that existing facilities are adequate for the existing use. As a condition of the exemption, the local health officer may require evidence that: (A) existing septic tanks have been pumped within the previous three years; (B) the parcel includes acreage or features sufficient to accommodate a replacement drainfield; (C) existing wells are adequate for the proposed uses; and (D) adequate storm drainage and solid waste disposal are provided.

Gayla I. Benefield
Gayla I. Benefield

05-07-21
Date

ACKNOWLEDGMENT

The foregoing Exemptions were subscribed and acknowledged before me, a Notary Public for the State of Montana County of Lincoln, by

Gayla I. Benefield, on this 7 day of May 2021.

In witness whereof, I have hereunto set my hand and affixed my notarial seal.

Chelsea Sanderson
Chelsea Sanderson, Notary Public for the State of Montana
residing in: Libby, MT My Commission expires: 8/5/2024

HISTORY OF SURVEYS

1893 - Original GLO Section Subdivision, by Daniel P. Mumbrue
1980 - Occasional Sale, COS No. 530 by M. Lauteren 4232S.
1981 - Occasional Sale, COS No. 873 by M. Lauteren 4232S.
1991 - Occasional Sale, COS No. 1702 by K. Davis 4975S.
1994 - Family Transfer, COS No. 2246 by K. Davis 4975S.
2012 - Family Transfer, COS No. 4152FC by A. Hughes 7322LS.

METHOD OF SURVEY

A Nikon Total Station with data collector and a Trimble R8 GNSS GPS System were used with RTK radial procedures to tie the previously set controlling corners and road alignments by Eric Stafford and Brendon Hunter April, 2021.

BASIS OF BEARING

The basis of bearing is S59°02'39"E, as shown on COS No. 4152FC between the Southeast corner Parcel "A", COS No. 873 a 5/8 inch diameter rebar capped MDL 4232S and the Southwest corner Parcel "C", COS No. 4152FC a 5/8 inch diameter rebar capped KED 4975S.

LAND SURVEYOR'S CERTIFICATION

I hereby certify that I am a Registered Land Surveyor in the State of Montana, that the survey shown on this Certificate of Survey has been prepared under my supervision and in accordance with the Montana Code Annotated, Sections 76-3-101 through 76-3-625, and the Lincoln County Regulations adopted pursuant thereto.

Byron Sanderson PLS, 70400LS 5-7-2021
Byron Sanderson, PLS, 70400LS Date

EXAMINING LAND SURVEYOR'S CERTIFICATION

Examined this 10th day of May 2021, A.D.

Steven A. Boyer
Steven A. Boyer, PLS 9750LS, Lincoln County Examining Land Surveyor

COUNTY TREASURER'S CERTIFICATION

I hereby certify that all real property taxes and special assessments assessed and levied on the parcel shown hereon are paid pursuant to Section 76-3-207(3), M.C.A.

Michael A. Carlberg May 7, 2021
Lincoln County Treasurer Date

CLERK AND RECORDER'S CERTIFICATION

State of Montana, County of Lincoln, filed this 10th day of May 2021 at 12:55 o'clock PM.

by *Robin Benson* *Clude E. Rm*
Lincoln County Clerk & Recorder Deputy

CERTIFICATE OF SURVEY NO. 4774RB

