

LINCOLN COUNTY MONTANA

CERTIFICATE OF SURVEY

RETRACEMENT

LOT 6 OF FEAQ TRACTS PER C.O.S. 29 (WEST OF STATE HIGHWAY 56)

In Gov't Lot 4, Section 29 Twp. 29 N., R. 33 W., P.M.M.

For: Schoop

Date: August 2020

LEGEND

- | | |
|---|--|
|  | SET A 5/8 INCH DIA. REBAR
WITH A 1 1/4 INCH DIA. PLASTIC
CAP STAMPED K.E.D. 4975-S |
|  | FOUND 5/8 INCH DIA. BARE REBAR W/
TAG STAMPED 534ES |
|  | FOUND 5/8 INCH DIA. REBAR CAPPED
K.E.D. 4975-S |
|  | COMPUTED POINT |
| () | RECORD PER C.O.S. 29 |
| { } | RECORD PER C.O.S. 3374RB |
| WC | WITNESS CORNER |

LOT 7
FEAK TRACTS
C.O.S. 29

**LOT 6
FEAK TRACTS
1.37 ACRES±**

AMENDED LOT 5
C.O.S. 3374RB

LOT 3
FEAK TRACTS
C.O.S. 29

DESCRIPTION OF LOT 6 (WEST OF HIGHWAY)

A tract of land near Troy, in Lincoln County Montana lying in Gov't Lot 4 of Section 29, Twp. 29 N., R. 33 W., P.M.M., being Lot 6 of Peak Tracts per C.O.S. 29 lying west of Montana State Highway No. 56, containing 1.37 acres more or less and more particularly described as follows:

Beginning at a 5/8 inch dia. rebar tagged 534ES which marks the northeast corner of Lot 6 of Peak Tracts lying on the west right-of-way of Montana State Highway No. 56; thence, S81°06'32"W 353.56 feet to a 5/8 inch dia. rebar tagged 534ES; thence, S36°33'57"W 295.65 feet to a 5/8 inch dia. rebar capped K.E.D. 4975-S set a witness corner; thence continuing, S36°33'57"W 25.00 feet to a computed point located below the current waterline of Bull Lake; thence, N87°23'21"E 116.13 feet to a 5/8 inch dia. rebar capped K.E.D. 4975-S; thence, N36°35'48"E 196.80 feet to a 5/8 inch dia. rebar tagged 534ES; thence, N81°08'23"E 377.37 feet to a 5/8 inch dia. rebar tagged 534ES located on the west right-of-way of said Montana State Highway No. 56; thence along said right-of-way, N36°49'32"W 13.13 feet to a computed point; thence on the arc of a curve to the right, a distance of 99.02 feet, turning through a delta angle of 1°56'47", and having a radius of 2914.75', to the point of beginning.

The aforescribed Lot 6 contains 1.37 acres more or less and is subject to and together with all appurtenant easements of record.

LOT 6

LOT 5

LOT 4

PURPOSE OF SURVEY

The purpose of this survey is to retrace the exterior boundaries of an existing tract of record and no new parcels have been created; therefore, this survey is exempt from review as a subdivision being completed pursuant to 76-3-404 M.C.A.

CERTIFICATION OF LINCOLN COUNTY EXAMINING LAND SURVEYOR:

Examined this 1st day of SEPT. 2020 A.D.

Examined this 1 day of Sept. 2020 A.D.
Steven A. Boyer
 Steven A. Boyer Professional Land Surveyor No. 1045

STATE OF MONTANA
COUNTY OF LINCOLN

Filed on this 1st day of September 2020 A.D. at 2:04
O'clock P m.

Robin Bunson
County Clerk and Recorder

by Olyda E. En
Deputy

CERTIFICATE OF SURVEY NO. 4700

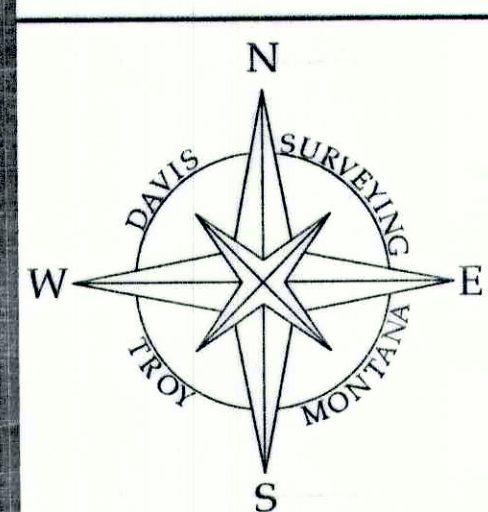
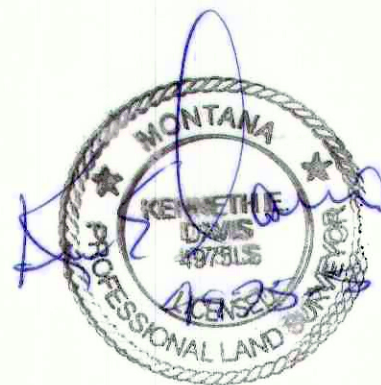

Graphic Scale:

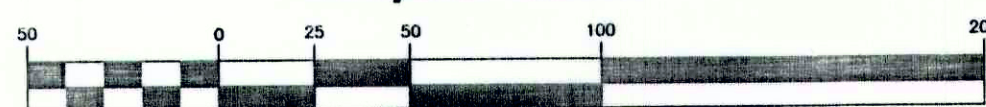

(1 inch = 50 ft.)

DAVIS SURVEYING INC.

TROY, MONTANA

DATE: 8/7/20

DRAWN BY: CJR

Land Projects 2020
FILE: T293329S.dwg

REV:

CERTIFICATE OF SURVEYOR
STATE OF MONTANA
County of Lincoln

I, Kenneth E. Davis, a registered land surveyor do hereby certify that I have performed the survey shown on the attached plat or that such survey was performed under my supervision to my best knowledge and ability; that said survey is true and complete as shown and the monuments found and set occupy the positions shown hereon.

Dated this 15 day of April, 2020 A.D.

Kenneth E. Davis Registered Land Surveyor No. 4975-S

STATE OF MONTANA
COUNTY OF LINCOLN

Filed on this 1st day of September 2020 A.D. at 2:04
O'clock P m.

Robin Bunson
County Clerk and Recorder

by Olyda E. En
Deputy

CERTIFICATE OF SURVEY NO. 4700