

By: SANDS SURVEYING, Inc.
2 Village Loop
Kalispell, MT 59901
(406) 755-6481

JOB NO: 472801
DRAWING DATE: March 4, 2020
COMPLETED DATE: / /
FOR: GARY HARRISON
OWNERS: GARY W. HARRISON
DIANE L. HARRISON
JFLI TRUST

Amended Plat Of
Lot 5 Of Airport Estates East
A Subdivision Located In W1/2NW1/4 SEC. 13 & E1/2NE1/4 SEC. 14,
T.37N., R.27W., P.M.M., LINCOLN COUNTY, MONTANA

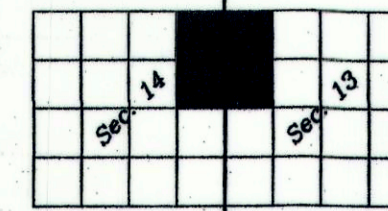

PURPOSE: BOUNDARY LINE ADJUSTMENT

SCALE: 1" = 200'

DESCRIPTION:

A TRACT OF LAND, SITUATED, LYING AND BEING IN THE EAST HALF OF THE NORTHEAST QUARTER OF SECTION 14, TOWNSHIP 37 NORTH, RANGE 27 WEST, P.M.M., LINCOLN COUNTY, MONTANA, AND MORE PARTICULARLY DESCRIBED AS FOLLOWS TO WIT:

LOT 5A:

Commencing at the southeast corner of the Northeast Quarter of Section 14, Township 37 North, Range 27 West, P.M.M., Lincoln County, Montana, which is a brass cap; Thence along the east boundary of said NE1/4 N00°28'45"E 677.32 feet to a found iron pin; Thence S89°56'06"W 292.44 feet to a set iron pin and THE TRUE POINT OF BEGINNING OF THE TRACT OF LAND HEREIN DESCRIBED; Thence continuing S89°56'06"W 738.22 feet to a found iron pin; Thence N17°34'04"E 782.04 feet to a found iron pin; Thence N09°28'56"W 252.32 feet; Thence S89°54'55"E 843.83 feet to a found iron pin on the east boundary of said NE1/4; Thence along said boundary S00°13'41"W 247.40 feet to a found iron pin; Thence N89°55'00"W 292.32 feet to a set iron pin; Thence S00°31'17"W 745.40 feet to the point of beginning and containing 15.351 ACRES; Subject to and together with a 60 foot private road and utility easement known as AJ Lane as shown hereon; Together with a 60 foot private road and utility easement known as Tricking Spring Road as shown hereon; Subject to and together with all appurtenant easements of record.

The above described tract of land shall hereafter be known as:
AMENDED PLAT OF LOT 5 OF AIRPORT ESTATES EAST

DESCRIPTION:

A TRACT OF LAND, SITUATED, LYING AND BEING IN THE WEST HALF OF THE NORTHWEST QUARTER OF SECTION 13 and IN THE EAST HALF OF THE NORTHEAST QUARTER OF SECTION 14, ALL IN TOWNSHIP 37 NORTH, RANGE 27 WEST, P.M.M., LINCOLN COUNTY, MONTANA, AND MORE PARTICULARLY DESCRIBED AS FOLLOWS TO WIT:

TRACT 1: (Includes Parcel 'A')

Commencing at the southeast corner of the Northeast Quarter of Section 14, Township 37 North, Range 27 West, P.M.M., Lincoln County, Montana, which is a brass cap; Thence along the east boundary of said NE1/4 N00°28'45"E 677.32 feet to a found iron pin and THE TRUE POINT OF BEGINNING OF THE TRACT OF LAND HEREIN DESCRIBED; Thence S89°56'06"W 292.44 feet to a set iron pin; Thence N00°31'17"E 745.40 feet to a set iron pin; Thence S89°55'00"E 910.45 feet to a found iron pin; Thence S00°30'46"W 352.97 feet to a found iron pin; Thence N89°48'18"W 618.07 feet to a found iron pin on said east boundary of said NE1/4; Thence along said boundary S00°31'17"W 392.88 feet to the point of beginning and containing 10.001 ACRES; Together with a 40 foot private road easement known as Arena View Road as shown hereon; Subject to and together with all appurtenant easements of record.

PARCEL 'A': (Being added to and made a part of Tract 1)

Commencing at the southeast corner of the Northeast Quarter of Section 14, Township 37 North, Range 27 West, P.M.M., Lincoln County, Montana, which is a brass cap; Thence along the east boundary of said NE1/4 N00°28'45"E 677.32 feet to a found iron pin and THE TRUE POINT OF BEGINNING OF THE TRACT OF LAND HEREIN DESCRIBED; Thence S89°56'06"W 292.44 feet to a set iron pin; Thence N00°31'17"E 745.40 feet to a set iron pin; Thence S89°55'00"E 292.32 feet to a found iron pin on said east boundary; Thence S00°30'12"W 351.77 feet to a found iron pin; Thence S00°31'17"W 392.88 feet to the point of beginning and containing 5.001 ACRES; Together with a 40 foot private road easement known as Arena View Road as shown hereon; Subject to and together with all appurtenant easements of record.

LEGEND:

- ① 1/4 Corner (as noted)
- Set 1/2"x24" Rebar & Cap (19236S)
- Found 5/8" Rebar & Cap (7328S)
- Found 5/8" Rebar & Cap (12211S)
- Found 5/8" Rebar & Cap (2989ES)
- (R1) Rec. Info. Per Airport Estates East
- (R2) Rec. Info. Per C.O.S. 3211 & Arena View
- (F) Found Information
- POB Point of Beginning

STATE OF Montana,
County of Lincoln, SS

On this 13 day of April, 2020, before me, a Notary Public in and for the State of Montana, personally appeared GARY W. HARRISON and DIANE L. HARRISON, known to me to be the persons whose names are subscribed to the foregoing instrument and who duly acknowledged to me that they executed the same.

Notary Public for the State of Montana

STATE OF Montana,
County of Lincoln, SS

On this 13 day of April, 2020, before me, a Notary Public in and for the State of Montana, personally appeared MICHAEL J. LUCIANO, known to me to be the person whose name is subscribed to the foregoing instrument and who duly acknowledged to me that he executed the same.

Notary Public for the State of Montana

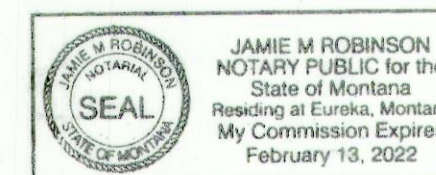
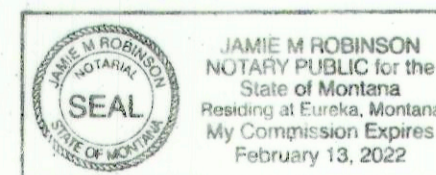

SHEET 1 OF 1

CERTIFICATE OF SURVEY No. 4674RB

OWNERS' CERTIFICATION:

"We hereby certify that the purpose of this division of land is to relocate common boundary lines between adjoining properties, and that no additional parcels are hereby created; therefore, this division of land is exempt from review as a subdivision pursuant to Section 76-3-207(1)(e), M.C.A. divisions made for the purpose of relocating a common boundary line between a single lot within a platted subdivision and adjoining land outside a platted subdivision. A restriction or requirement on the original platted lot or original unplatted parcel continues to apply to those areas."

ALSO

TRACT 1 is excluded from sanitation review by the Department of Environmental Quality pursuant to ARM 17.36.605(2)(b) as a parcel that has a previous approval [EQ #03-2560] issued under Title 76, chapter 4, part 1, MCA if: (i) no facilities other than those previously approved exist or will be constructed on the parcel; and (ii) the division of land will not cause approved facilities to deviate from the conditions of approval, in violation of 76-4-130, MCA.

AND

LOT 5A is excluded from sanitation review by the Department of Environmental Quality pursuant to ARM 17.36.605(2)(a) as a parcel that has no facilities for water supply, wastewater disposal, storm drainage, or solid waste disposal, if no facilities will be constructed on the parcel.

NOTE: The area that is being removed from one tract of record and joined with another tract of record is not itself a tract of record. Said area shall not be available as a reference legal description in any subsequent real property transfer after the initial transfer associated with the amended plat on which said area is described, unless said area is included with or excluded from adjoining tracts of record. Pursuant to ARM 24.183.1104(1)(i)(iii)(C).

Gary W. Harrison
GARY W. HARRISON

Diane L. Harrison
DIANE L. HARRISON

JFLI TRUST
By: Michael J. Luciano
MICHAEL J. LUCIANO, Trustee

By: HH

CERTIFICATE OF SURVEYOR

Joshua Nelson 3-27-2020

JOSHUA NELSON 19236S

EXAMINED: 15 April, 2020
Steve A. Boyer

LINCOLN CO. EXAMINING LAND SURVEYOR
REG. No. 9750S

STATE OF MONTANA } SS
COUNTY OF LINCOLN }

FILED ON THE 16 DAY OF April, 2020
AT 1:34 PM, PAID FEE 26.-

Robin Benson

CLERK & RECORDER

BY Clyde Rm
DEPUTY

INSTRUMENT REC. No. 284945