

# CERTIFICATE OF SURVEY "RETRACEMENT"

PLAT No. 2275A

GOV'T LOT 8, SE1/4 SE1/4, SECTION 24, T.31N., R.32W., and  
GOV'T LOT 6, SW1/4 SW1/4, SECTION 19, T.31N., R.31W., P.M.,MT.

LINCOLN COUNTY, MT

FOR: JACK H. BUNTON

DATE: NOVEMBER, 2019

## PURPOSE OF SURVEY

The purpose of this survey is the Retracement of Plat No. 2275A, the reestablishment of obliterated corners and mark property boundaries. Therefore no division of land is hereby created and is exempt from review as a subdivision, pursuant to Section 76-3-404 MCA.

## HISTORY OF SURVEYS

1919 - Resurvey HES No. 444  
1963 - Plat No. 1267, Resurvey, Jack W. Ninneman, 534ES  
1967 - Plat No. 1349, Resurvey, Jack W. Ninneman, 534ES  
1970 - Plat No. 2275A, Resurvey, Jack W. Ninneman, 534ES

## METHOD OF SURVEY

A Nikon total station with data collector and a Trimble R8 GNSS GPS system were used with RTK radial procedures to tie the previously set controlling corners and road alignments by Levi Powel, October, 2019.

## BASIS OF BEARING

The basis of bearing for this survey is N00°02'35"E derived from Survey Grade GPS system calibrated to local control between the Southwest corner, Section 24, T31N, R32W, a found 3 1/2 inch diameter aluminum cap and a found stone marked 2/444 lying on the East section line, Section 24, being the original stone monument, Corner 2, H.E.S. 444.

## LAND SURVEYOR'S CERTIFICATION

I hereby certify that I am a Professional Land Surveyor in the State of Montana, that the survey shown on this "Certificate of Survey" has been prepared under my supervision and in accordance with the Montana Code Annotated, Sections 76-3-101 through 76-3-625, and the Lincoln County Regulations adopted pursuant thereto.

*Alvah F. Hughes* 7322LS 12-17-19  
Alvah F. Hughes, PLS 7322LS Date

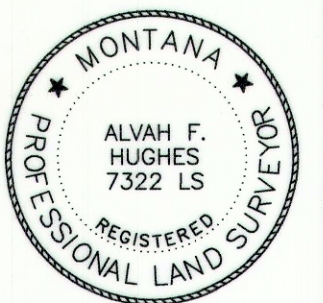

## VICINITY DIAGRAM

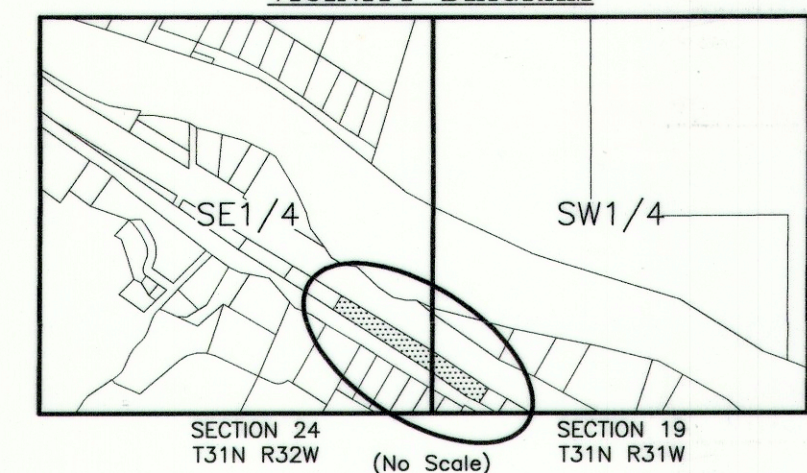

## EXAMINING LAND SURVEYOR'S CERTIFICATION

Examined this 20<sup>th</sup> day of December 2019, A.D.

*Ronald A. Pearson*  
Ronald A. Pearson, PLS 9008LS  
Lincoln County Examining Land Surveyor

## CLERK AND RECORDER'S CERTIFICATION

State of Montana, County of Lincoln, filed this 6<sup>th</sup> day  
of January 2020, A.D. at 3:16 o'clock  
*Robin Bunton* by *Cyril E. Rm*  
Lincoln County Clerk Recorder Deputy

CERTIFICATE OF SURVEY No. #4643

## LEGEND

- ✚ FOUND 3 1/2 INCH DIAMETER ALUMINUM CAP
- ② FOUND A STONE MARKED 2/444
- ⊙ FOUND 2 INCH DIAMETER PIPE
- ① FOUND 5/8 INCH DIAMETER REBAR WITH PLASTIC CAP MARKED HUGHES 7322LS
- SET 5/8 INCH DIAMETER REBAR WITH PLASTIC CAP MARKED HUGHES 7322LS
- COMPUTED POINT
- ( ) RECORD, PLAT No. 2275A
- { } RECORD, PLAT No. 1267
- [ ] RECORD, PLAT No. 1349
- BOUNDARY LINES
- ADJOINING BOUNDARIES
- - - RAILROAD RIGHT-OF-WAY
- - - HIGHWAY RIGHT-OF-WAY
- - - HIGHWAY CENTERLINE
- ||||| RAILROAD CENTERLINE
- - - SECTION LINE

## LEGAL DESCRIPTION: PLAT No. 2275A

A tract of land lying west of Libby, Montana, Lincoln County, within the SE1/4 SE1/4, Section 24, T.31N., R.32W., and SW1/4 SW1/4, Section 19, T.31N., R.31W., P.M.,MT., and more particularly described as follows:

Plat No. 2275A, containing 2.87 acres and subject to and together with all appurtenant easements of record.

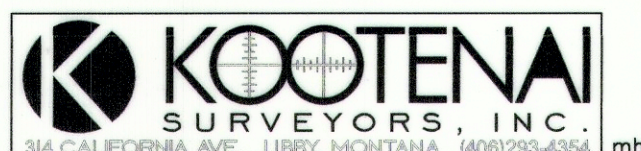

## GRAPHIC SCALE

