

LINCOLN COUNTY MONTANA
CERTIFICATE OF SURVEY
PARTIAL RETRACEMENT

Lot 12 Irregular Plat No. 242

A portion of the Eagle Placer Survey No. 7210 in the SW 1/4 Sec. 22 Twp. 32N., R. 34 W., P.M.M.
For: Odegard Date: May 2017

Graphic Scale:



(1 inch = 40 ft.)

LEGEND

- SET A 5/8 INCH DIA. REBAR
CAPPED K.E.D. 4975-S
- FOUND 5/8 INCH DIA. REBAR
CAPPED J.H.N. 4661-S
- FOUND 1/2 INCH DIA. IRON PIPE
- () RECORD PER IRREGULAR PLAT NO. 940



LOT 11
IRREGULAR PLAT NO. 242
& C.O.S. 3818

LOT 12
IRREGULAR PLAT NO. 242

IRREGULAR PLAT
NO. 935

IRREGULAR PLAT NO. 923
LESS IRREGULAR PLAT NO. 940

LOT 13A
IRREGULAR PLAT NO. 940

DESCRIPTION

A tract of land near Troy, in Lincoln County Montana, located in a portion of the Eagle Placer Survey No. 7210, lying in the SW 1/4 of Section 22, Twp. 32 N., R. 34 W., P.M.M., being Lot 12 as shown on Irregular Plat No. 242 and described in Book 340 Page 825 of Lincoln County Records.

PURPOSE OF SURVEY

The purpose of this survey is to partially retrace the boundary of an existing tract of record and no new parcels have been created; therefore, this survey is exempt from review as a subdivision being completed pursuant to 76-3-404 M.C.A.

CERTIFICATE OF SURVEYOR

STATE OF MONTANA
County of Lincoln

I, Kenneth E. Davis, a registered land surveyor do hereby certify that I have performed the survey shown on the attached plat or that such survey was performed under my supervision to my best knowledge and ability; that said survey is true and complete as shown and the monuments found and set occupy the positions shown hereon.

Dated this 30th day of May, 2017 A.D.

Kenneth E. Davis Registered Land Surveyor No. 4975-S

CERTIFICATION OF LINCOLN COUNTY EXAMINING LAND SURVEYOR:

Examined this 30th day of May, 2017 A.D.

Ronald A. Pearson Professional Land Surveyor No. 9008LS

STATE OF MONTANA
COUNTY OF LINCOLN

Filed on this 31st day of May, 2017 A.D. at 9:49
O'clock A.m.

Robin Benson by
County Clerk and Recorder Deputy

CERTIFICATE OF SURVEY NO. CS 4476

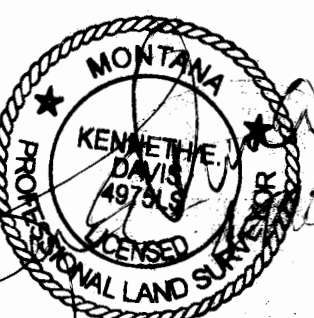

Davis Surveying Inc.
TROY MONTANA, (406)295-5441

DATE: 04-27-17

DRAWN BY: CJR

FILE: t323422o.dwg