

CERTIFICATE OF SURVEY:
RETRACEMENT

Lot 1 of Airbase Flats II per Plat No. 133875
A part of H.E.S. 431 in unsurveyed Section 2 Twp. 35 N., R. 32 W., P.M.M.
For: Yaak River Ventures, L.L.C.
Owners: Duane & Kristy Allen
Date: January 2014

DESCRIPTION OF LOT 1

A tract of land near Yaak, in Lincoln County Montana, being a portion of H.E.S. 431 in unsurveyed Section 2, Twp. 35 N., R. 32 W., P.M.M. and more particularly described as follows:

Beginning at a 5/8 inch dia. rebar capped K.E.D. 4975-S which marks the northeast corner of Lot 1 Airbase Flats II per Plat No. 133875; thence, S36°08'54"E 367.97 feet to a 5/8 inch dia. rebar capped with a 2 inch dia. alum. F.H.A. right-of-way monument located on the north right-of-way line of Montana State Highway No. 508; thence along said right-of-way; S54°03'44"W 198.15 feet to a 5/8 inch dia. rebar capped K.E.D. 4975-S; thence, S42°47'05"W 50.99 feet to a 5/8 inch dia. rebar capped K.E.D. 4975-S; thence, S54°02'09"W 65.51 feet to a bare 5/8 inch dia. rebar; thence leaving said north right-of-way, N36°13'17"W 193.45 feet to a 5/8 inch dia. rebar capped M.D.L. 4232-S; thence, S53°50'12"W 208.71 feet to a bare 5/8 inch dia. rebar; thence, S36°19'42"E 108.78 feet to a bare 5/8 inch dia. rebar; thence, S53°45'58"W 200.43 feet to a 5/8 inch dia. rebar capped K.E.D. 4975-S; thence, S36°14'02"E 80.24 feet to a 5/8 inch dia. rebar capped K.E.D. 4975-S located on the north right-of-way of said Montana State Highway No. 508; thence along said north right-of-way, on the arc of a curve to the right, a distance of 171.27 feet, turning through a delta angle of 8°47'37", and having a radius of 1115.92 feet to a bare 5/8 inch dia. rebar; thence, S66°55'29"W 190.82 feet to a 5/8 inch dia. rebar capped K.E.D. 4975-S; thence leaving said north right-of-way, on the arc of a curve to the left, a distance of 201.54 feet, turning through a delta angle of 22°45'21", and having a radius of 507.46 feet, to a 3 1/4 inch dia. alum. U.S.F.S. monument stamped AP-7; thence, N87°18'00"E 84.95 feet to a 3 1/4 inch dia. alum. U.S.F.S. monument stamped AP-6; thence, N44°27'43"E 175.12 feet to a 5/8 inch dia. rebar capped K.E.D. 4975-S; thence, N01°36'45"E 259.92 feet to a 3 1/4 inch dia. alum. U.S.F.S. monument stamped AP-4; thence, N53°04'55"E 507.38 feet to the point of beginning.

The aforescribed Lot 1 of Airbase Flats II contains 5.00 acres more or less and is subject to and together with all appurtenant easements of record.

Legend

- SET 5/8 INCH DIA. REBAR WITH A 1 1/4 INCH DIA. PLASTIC CAP STAMPED K.E.D. 4975-S
- FOUND 5/8 INCH DIA. REBAR CAPPED K.E.D. 4975-S
- FOUND 3 1/4 INCH DIA. ALUM. U.S.D.A. MONUMENTS AS NOTED
- FOUND 5/8 INCH DIA. REBAR CAPPED M.D.L. 4232-S
- FOUND 5/8 INCH DIA. REBAR WITH A 2 INCH DIA. ALUM. F.H.A. RIGHT OF WAY MONUMENTS
- BARE 5/8 INCH DIA. REBAR
- COMPUTED POINTS
- () RECORD PER PLAT NO. 133875

LINCOLN COUNTY
C.O.S. 1511

LOT 1
FLAMINGO SUBDIVISION
PLAT NO. 6366

E.I.D., LLC
HARLEM, MT 59526
DATE: 1/6/14
DRAWN BY: GJR
Land Projects 2013
FILE: airbase 2.dwg

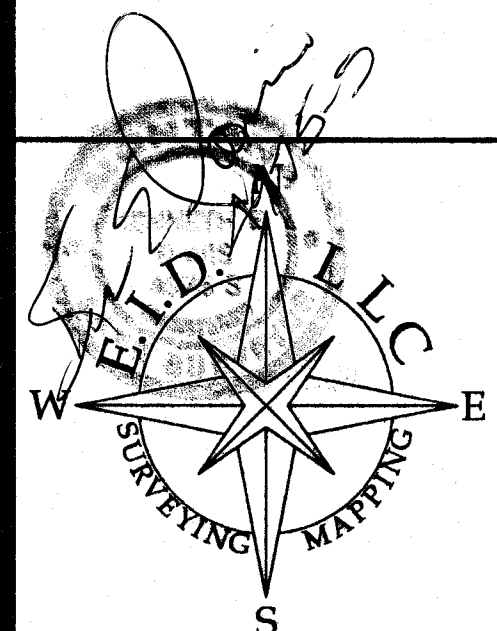

Δ = 22°45'21"
R = 507.46'
L = 201.54'

Δ = 8°47'37"
R = 1115.92'
L = 171.27'

PURPOSE OF SURVEY

The purpose of this survey is to retrace the exterior boundaries of an existing tract of record and that no new parcels have been created; therefore, this survey is exempt from review as a subdivision being completed pursuant to 76-3-404 M.C.A.

Graphic Scale



1 inch = 60 ft.

LOT 1
5.00 ACRES±

CERTIFICATE OF SURVEYOR
STATE OF MONTANA
County of Lincoln

I, Kenneth E. Davis, a registered land surveyor do hereby certify that I have performed the survey shown on the attached plat or that such a survey was performed under my direct supervision to my best knowledge and ability; that said survey is true and complete as shown and the monuments found and set occupy the position shown hereon.

Dated this 11th day of February, 2014 A.D.

Kenneth E. Davis Registered Land Surveyor No. 4975-S

CERTIFICATION OF LINCOLN COUNTY EXAMINING LAND SURVEYOR:

Examined this 13th day of Feb 2014 A.D.

Ronald A. Pearson Registration No. 9008LS

STATE OF MONTANA
County of Lincoln

Filed on this 11th day of March, 2014 A.D. at 11:00 O'clock A.M.

Tammy D. Lewis by Joanne Annun Deputy
County Clerk and Recorder

CERTIFICATE OF SURVEY NO. 4266

Doc 250368