

**CERTIFICATE OF SURVEY**  
E1/2 SE1/4 SW1/4 SECTION 25, T. 36 N. R. 26 W. P.M., M.  
Lincoln County, Montana  
COURT ORDER NO. DR-09-242B  
MONTANA ELEVENTH JUDICIAL DISTRICT COURT  
FLATHEAD COUNTY

FOR: STEVE & CHERYL GEIBEL  
OWNER: STEVE GEIBEL  
PURPOSE: COURT ORDERED DIVISION  
DATE: MAY 2009

PURPOSE OF SURVEY AND OWNERS EXEMPTION

I, STEVEN GEIBEL, OWNER OF RECORD, HEREBY CERTIFY THAT THE PURPOSE OF THIS SURVEY AND DIVISION OF LAND IS BY ORDER OF A COURT, THEREFORE PARCEL A AND PARCEL B ARE EXEMPT FROM REVIEW AS A SUBDIVISION PURSUANT TO SECTION 76-3-201(1)(a), M.C.A. DIVISION IS CREATED BY ORDER OF ANY COURT OF RECORD IN THIS STATE OR BY OPERATION OF LAW OR THAT, IN THE ABSENCE OF AGREEMENT BETWEEN THE PARTIES TO THE SALE, COULD BE CREATED BY AN ORDER OF ANY COURT IN THIS STATE PURSUANT TO THE LAW OF EMINENT DOMAIN, TITLE 70, CHAPTER 30; AND FURTHERMORE IS EXEMPT FROM DEPARTMENT OF ENVIRONMENTAL QUALITY REVIEW PURSUANT TO ARM 17.36.605(1)(a), DIVISIONS CREATED BY ORDER OF ANY COURT OF RECORD IN THIS STATE OR BY OPERATION OF LAW, OR DIVISIONS WHICH, IN THE ABSENCE OF AGREEMENT BETWEEN THE PARTIES TO THE SALE, COULD BE CREATED BY AN ORDER OF ANY COURT IN THIS STATE PURSUANT TO THE LAW OF EMINENT DOMAIN, TITLE 70, CHAPTER 30, PARTS 1, 2 AND 3, M.C.A.

*Steven Geibel* 7/3/09  
STEVEN GEIBEL DATE

State of Montana :ss  
County of Lincoln  
This instrument was acknowledged before me on July 3, 2009  
by Steven Geibel.  
*Carla J. Mikita*  
Notary Public for the State of Montana  
Residing at Eureka  
My Commission expires March 22, 2013

CARLA J. MIKITA  
NOTARY PUBLIC - MONTANA  
Residing at  
Eureka, Montana  
My Commission Expires  
March 22, 2013

CERTIFICATE OF SURVEYOR

I hereby certify that I am a Registered Land Surveyor in the State of Montana and that the survey shown on this Certificate of Survey has been prepared by me and in accordance with the Montana Code Annotated, Sections 76-3-101 through 76-3-625, and the Lincoln County regulations adopted pursuant thereto.

*Jay J. Squire*  
Jay J. Squire, PLS  
Registration No. 17282 LS Montana  
Date: June 16, 2009  
Examined JUNE 18, 2009

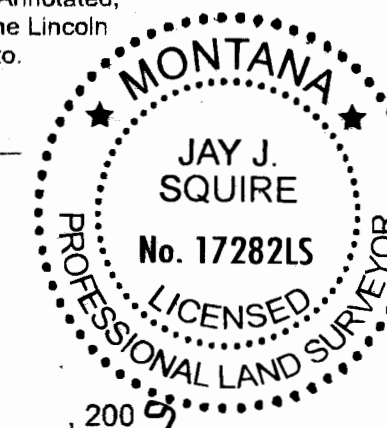

*Ronald A. Pearson*  
Ronald A. Pearson, 9008LS  
Lincoln County Examining Land Surveyor  
Registration No. 9008 LS, Montana

STATE OF MONTANA  
County of Lincoln  
Filed on the 8th day of July, 2009, A.D.  
at 3:58 o'clock P.M.  
*Tommy O. Lane*  
County Clerk and Recorder  
By: *Ron A. Pearson*  
Deputy  
Instrument No. 220163

CERTIFICATE OF SURVEY NO. 3939CO

Legal Description: PARCEL A

THAT PORTION OF THE EAST 1/2 OF THE SOUTHEAST 1/4 OF THE SOUTHWEST 1/4 OF SECTION 25, TOWNSHIP 36 NORTH, RANGE 26 WEST, P.M., M., LINCOLN COUNTY, MONTANA, DESCRIBED AS FOLLOWS:

BEGINNING AT THE NORTHEAST CORNER OF THE AFORESAID EAST 1/2 OF THE SOUTHEAST 1/4 OF THE SOUTHWEST 1/4 OF SECTION 25, THE TRUE POINT OF BEGINNING BEING A FOUND 5/8" REBAR MARKED 7328S;

THENCE NORTH 89° 38' 58" WEST, ALONG THE NORTH LINE OF SAID EAST 1/2, 665.92 FEET TO THE NORTHWEST CORNER OF SAID EAST 1/2;

THENCE SOUTH 00° 08' 04" WEST, ALONG THE WEST LINE OF SAID EAST 1/2, 880.56 FEET TO A POINT IN THE CENTERLINE OF SHERMAN CREEK;

THENCE NORTHEASTERLY ALONG THE CENTERLINE OF SHERMAN CREEK, ABOUT 1011 FEET TO A POINT IN THE EASTERLY LINE OF THE AFORESAID EAST 1/2 OF THE SOUTHEAST 1/4 OF THE SOUTHWEST 1/4;

THENCE NORTH 00° 10' 10" EAST, ALONG SAID EASTERLY LINE, 240.06 FEET TO THE TRUE POINT OF BEGINNING, CONTAINING 8.653 ACRES OF LAND, MORE OR LESS, AND SUBJECT TO AND TOGETHER WITH ALL EASEMENTS OF RECORD. SUBJECT TO A DRIVEWAY EASEMENT TO PARCEL B AS SHOWN.

Legal Description: PARCEL B

THAT PORTION OF THE EAST 1/2 OF THE SOUTHEAST 1/4 OF THE SOUTHWEST 1/4 OF SECTION 25, TOWNSHIP 36 NORTH, RANGE 26 WEST, P.M., M., LINCOLN COUNTY, MONTANA, DESCRIBED AS FOLLOWS:

BEGINNING AT THE SOUTHEAST CORNER OF THE AFORESAID EAST 1/2 OF THE SOUTHEAST 1/4 OF THE SOUTHWEST 1/4 OF SECTION 25, THE TRUE POINT OF BEGINNING BEING A FOUND FOREST SERVICE ALUMINUM MONUMENT MARKED 5612S;

THENCE NORTH 89° 38' 27" WEST, ALONG THE SOUTH LINE OF SAID EAST 1/2, 665.11 FEET TO THE SOUTHWEST CORNER OF SAID EAST 1/2;

THENCE NORTH 00° 08' 04" EAST, ALONG THE WEST LINE OF SAID EAST 1/2, 439.56 FEET TO A POINT IN THE CENTERLINE OF SHERMAN CREEK;

THENCE NORTHEASTERLY ALONG THE CENTERLINE OF SHERMAN CREEK, ABOUT 1011 FEET TO A POINT IN THE EASTERLY LINE OF THE AFORESAID EAST 1/2 OF THE SOUTHEAST 1/4 OF THE SOUTHWEST 1/4;

THENCE SOUTH 00° 10' 10" WEST, ALONG SAID EASTERLY LINE, 1080.16 FEET TO THE TRUE POINT OF BEGINNING, CONTAINING 11.517 ACRES OF LAND, MORE OR LESS, AND SUBJECT TO AND TOGETHER WITH ALL EASEMENTS OF RECORD.

LEGEND

- FOUND 5/8" REBAR W/CAP 7328S
- SET 5/8" X 24" REBAR W/CAP 17282LS
- ⊕ FOUND FS AL CAP 5612S AT 1/4 CORNER
- ⊕ FOUND 2" BRASS CAP AT SECTION CORNER
- ⊕ FOUND BLM BRASS CAP AT 1/4 CORNER

JAY J. SQUIRE, PLS  
PO BOX 1537  
EUREKA, MT. 59917  
406-889-5861

Final Plat Approval 2010.02.02 PF 102110

