

# CERTIFICATE OF SURVEY "RETRACEMENT"

E<sup>1</sup>/<sub>2</sub> SE<sup>1</sup>/<sub>4</sub>, NE<sup>1</sup>/<sub>4</sub>, SECTION 4, T.30N., R.31W., P.M., MT.  
PLAT No. 216  
LINCOLN COUNTY, MONTANA  
FOR: KELLY O'BRIEN DATE: MARCH 2008

### LEGAL DESCRIPTION - TRACT 1A C1

An irregular tract of land in Libby, Montana, Lincoln County and lying in the E<sup>1</sup>/<sub>2</sub> SE<sup>1</sup>/<sub>4</sub>, NE<sup>1</sup>/<sub>4</sub>, Section 4, T.30N., R.31W., P.M., MT., and more particularly described as:  
Commencing at the East Quarter corner, section 4, T.30N., R.31W., a 3 1/4 inch diameter aluminum cap marked Smith 4740LS; Thence N00°06'09"W, 20.00 feet along the East section line, said section 4 to an unmarked point lying on the Northerly Right-of-Way limits of Sixth Street, a 40 foot wide city street and the TRUE POINT OF BEGINNING; Thence along said Northerly Right-of-Way limits S89°28'38"W, 92.20 feet to a set 5/8 inch diameter rebar with a plastic cap marked Hughes, 7322LS; Thence leaving said Right-of-Way limits N16°51'43"E, 315.98 feet to a set 5/8 inch diameter rebar with a plastic cap marked Hughes, 7322LS; Thence S00°06'09"E, 301.56 feet along said East section line to an unmarked point and the TRUE POINT OF BEGINNING, containing 0.319 acres. Subject to and together with all appurtenant easements of record.

### PURPOSE OF SURVEY

The purpose of this survey is the retracement of record parcels of land; establishment of obliterated corners, and mark property boundaries. Therefore, no division of land is hereby created and is exempt from review as a subdivision pursuant to Section 76-3-404 MCA.

### METHOD OF SURVEY

A GPS survey grade RTK system was used to tie previously set controlling corners by Kelly Rooney and Levi Powell, March 2008.

### BASIS OF BEARING

The basis of bearing for this survey is N00°06'09"W, between a 3 1/4 inch diameter Aluminum cap marked "Smith 4740LS", marking the East quarter corner and a 3 1/4 inch diameter BLM Brass cap, marking the NE corner Section 4 T.30 N., R. 31 W.

### HISTORY OF SURVEY

- 1953 - Plat No. 216, Parcel Creation, Ira.C. Miller, 402S
- 1966 - Plat No. 1477, "Montway Site", J. Ninneman, 534ES
- 1979 - COS No. 573, Retracement, J.H. Ninneman, 4661S
- 1979 - Plat No. 3205, "Westland Subdivision", M.D. Lautern, 4232S
- 1979 - Plat No. 2317, Amended Lot 1, GlenWood Homes, A.R. Spurway, 4664S
- 1990 - COS No. 1807, Boundary Line Adjustment, D. McAlister, 7328S
- 2004 - COS No. 3270, Retracement, S.R. Smith, 4740LS

### LAND SURVEYOR'S CERTIFICATION

I hereby certify that I am a Registered Land Surveyor in the State of Montana, that the survey shown on this Certificate of Survey has been prepared under my supervision and in accordance with the Montana Code Annotated, Sections 76-3-101 through 76-3-625, and the Lincoln County Regulations adopted pursuant thereto.

*Alvah F. Hughes* 7322LS 03/12/08  
Alvah F. Hughes, PLS, 7322LS Date

### EXAMINING LAND SURVEYOR'S CERTIFICATION

Examined this 12 day of MAY, 2008, A.D.  
*Ronald A. Pearson*  
Ronald A. Pearson, PLS, 9008LS - Examining Land Surveyor

### CLERK AND RECORDER'S CERTIFICATION

State of Montana, County of Lincoln, filed this 15 day  
of May, 2008, A.D. at 3:10 o'clock  
*Jammy D. Hauer* by *Bill Blomdall*  
Lincoln County Clerk & Recorder Deputy

CERTIFICATE OF SURVEY NO. 3826  
doc # 211413

### BASIS OF BEARING

TOTAL: NE SEC. COR TO E 1/4 COR  
/N 00°06'09" E 2392.01'  
N 00°06'09" W 2391.91'

(NORTH 301.57)  
N 00°06'09" W 301.56

PARCEL A  
C.O.S. 1807

### DETAIL "C" (NO SCALE)

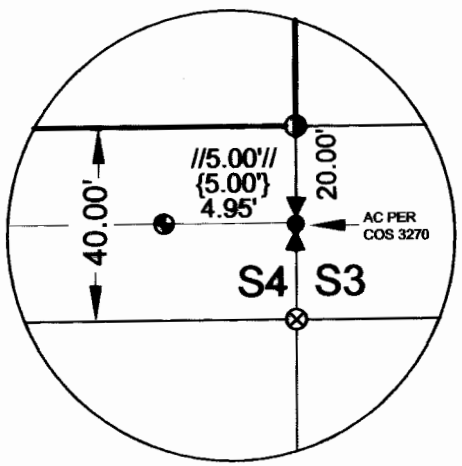

### DETAIL "B" (NO SCALE)

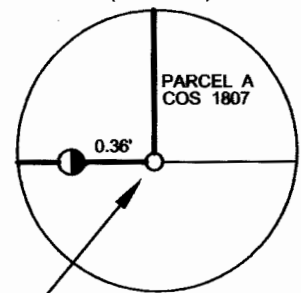

### LEGEND

- 3 1/4 INCH DIAMETER BRASS OR ALUMINUM CAP AS NOTED
- SET 5/8 INCH DIAMETER REBAR WITH A PLASTIC CAP MARKED HUGHES 7322LS
- 5/8 INCH DIAMETER REBAR WITH A PLASTIC CAP MARKED McAlister 7328S
- 5/8 INCH DIAMETER UNCAPPED REBAR
- 5/8 INCH DIAMETER REBAR WITH PLASTIC CAP MARKED JHN 4661S
- UNMARKED COMPUTED POINT
- RECORD - PLAT No. 216 // // RECORD - COS No. 3270
- RECORD - C.O.S. No. 573 < > RECORD - PLAT No. 2317
- RECORD - C.O.S. No. 1807 / / RECORD - PLAT No. 1477
- BOUNDARY LINES THIS SURVEY
- SECTION LINES

### GRAPHIC SCALE

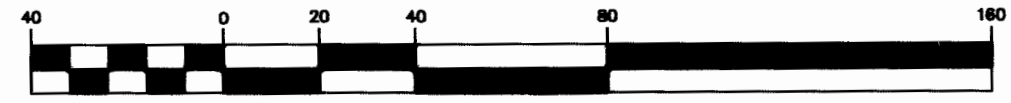

( IN FEET )  
1 inch = 40 ft.

