

# CERTIFICATE OF SURVEY

**S1/2 SECTION 2 T35N R26W P.M., M.**

# Lincoln County, Montana

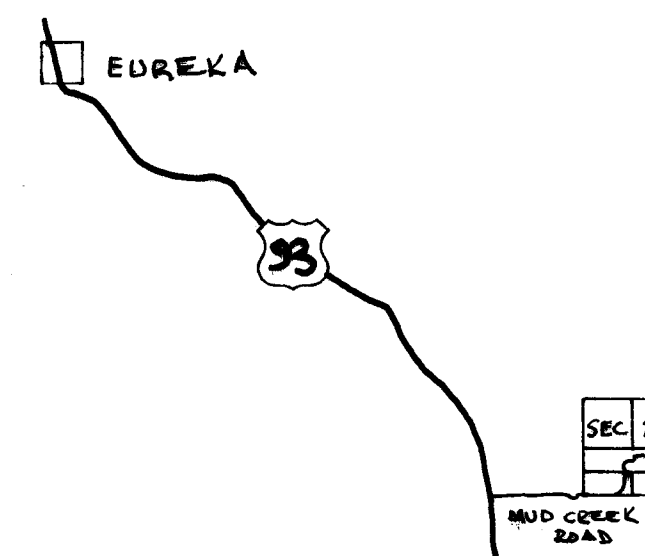

VICINITY MAP 1" = 2 MILES

FOR: KAREN WHITNEY NESBITT  
OWNER: KAREN WHITNEY NESBITT  
PURPOSE: PARCEL 1: FAMILY TRANSFER  
PARCEL 2: REMAINDER  
DATE: JUNE 2007



SCALE : 1" = 100'



LEGEND	
●	FOUND 5/8" REBAR W/CAP "2989ES"
○	SET 5/8" X 24" REBAR W/CAP "SQUIRE 17282-LS"
[ ]	RECORD PER C.O.S. 1416

**SHEET 1 of 2**

CERTIFICATE OF SURVEY NO. **#3822 FC**

Doc# 210966

JAY J. SQUIRE, PLS  
PO BOX 1537  
EUREKA, MT 59917  
406-889-5861

Drainfield Ease 341/494  
Doc # 233752

Charity Restrictions Removed p. 5# 9405 Doc 2096

# CERTIFICATE OF SURVEY

S1/2 SECTION 2 T35N R26W P.M., M.

Lincoln County, Montana

FOR: KAREN WHITNEY NESBITT  
OWNER: KAREN WHITNEY NESBITT  
PURPOSE: PARCEL 1: FAMILY TRANSFER  
PARCEL 2: REMAINDER  
DATE: JUNE 2007

## LEGAL DESCRIPTIONS

### PARCEL 1

THAT PORTION OF THE NORTHWEST 1/4 OF THE SOUTHEAST 1/4 OF SECTION 2, TOWNSHIP 35 NORTH RANGE 26 WEST P.M., M., LINCOLN COUNTY, MONTANA DESCRIBED AS FOLLOWS:

BEGINNING AT THE SOUTHEAST CORNER OF PARCEL A OF CERTIFICATE OF SURVEY NUMBER 1416; THENCE SOUTH 88° 52' 14" WEST, ALONG THE SOUTH LINE OF SAID PARCEL A, FOR 233.38 FEET; THENCE NORTH 07° 33' 47" WEST FOR 242.75 FEET; THENCE NORTH 06° 48' 55" EAST FOR 228.70 FEET; THENCE NORTH 89° 08' 52" EAST FOR 233.26 FEET TO A POINT IN THE EAST LINE OF AFORESAID PARCEL A OF COS 1416; THENCE SOUTH 00° 36' 11" EAST FOR 466.62 FEET, TO THE POINT OF BEGINNING, CONTAINING 2.661 ACRES OF LAND, MORE OR LESS, SUBJECT TO AND TOGETHER WITH 30 FOOT AND 40 FOOT EASEMENTS AS SHOWN ON CERTIFICATE OF SURVEY NO. 3822 FC, AND ALL EASEMENTS OF RECORD.

KNOWN AS BEING PARCEL 1 OF CERTIFICATE OF SURVEY NO. 3822 FC.

### PARCEL 2

THAT PORTION OF THE NORTHEAST 1/4 OF THE SOUTHWEST 1/4 AND THE NORTHWEST 1/4 OF THE SOUTHEAST 1/4 OF SECTION 2, TOWNSHIP 35 NORTH RANGE 26 WEST P.M., M., LINCOLN COUNTY, MONTANA DESCRIBED AS FOLLOWS:

BEGINNING AT THE SOUTHWEST CORNER OF THE NORTHWEST 1/4 OF THE SOUTHEAST 1/4 OF SAID SECTION 2; THENCE ALONG THE SOUTH LINE OF THE NORTHWEST 1/4 OF THE SOUTHEAST 1/4 OF SAID SECTION 2 NORTH 88° 52' 14" EAST FOR 488.33 FEET; THENCE NORTH 07° 33' 47" WEST FOR 242.75 FEET; THENCE NORTH 06° 48' 55" EAST FOR 228.70 FEET; THENCE NORTH 89° 08' 52" EAST FOR 233.26 FEET TO A POINT IN THE EAST LINE OF PARCEL A OF CERTIFICATE OF SURVEY NO. 1416; THENCE ALONG SAID EAST LINE NORTH 00° 36' 11" WEST FOR 466.93 FEET TO THE NORTHEAST CORNER OF SAID PARCEL A; THENCE ALONG THE NORTH LINE OF SAID PARCEL A SOUTH 89° 24' 32" WEST FOR 579.08 FEET MORE OR LESS TO THE CENTERLINE OF MUD CREEK; THENCE SOUTHERLY AND SOUTHWESTERLY ALONG THE CENTERLINE OF THE CREEK 1560 FEET MORE OR LESS TO THE SOUTH LINE OF THE NORTHEAST 1/4 OF THE SOUTHWEST 1/4 OF SAID SECTION 2; THENCE ALONG SAID SOUTH LINE NORTH 89° 48' 20" EAST FOR 353.23 FEET, TO THE POINT OF BEGINNING, CONTAINING 17.333 ACRES OF LAND, MORE OR LESS, SUBJECT TO AND TOGETHER WITH ALL EASEMENTS OF RECORD.

KNOWN AS BEING PARCEL 2 OF CERTIFICATE OF SURVEY NO. 3822 FC.

## PURPOSE OF SURVEY AND OWNERS EXEMPTION

I, KAREN WHITNEY NESBITT, OWNER OF RECORD, HEREBY CERTIFY THAT THE PURPOSE OF THIS SURVEY AND DIVISION OF LAND IS TO TRANSFER PARCEL 1, 2.661 ACRES, AS SHOWN HEREON, TO MY DAUGHTER, HANNAH WHITNEY; THAT THIS IS THE FIRST AND SINGLE GIFT OR SALE IN THIS COUNTY TO THIS MEMBER OF MY IMMEDIATE FAMILY AND THE OWNER OF RECORD CERTIFICATION OF COMPLIANCE THAT THE PARCEL WILL NOT BE TRANSFERRED BACK TO THE GRANTOR WITHIN 24 MONTHS OF FILING WITHOUT WRITTEN CONSENT OF THE GOVERNING BODY. THEREFORE THIS PARCEL IS EXEMPT FROM REVIEW AS A SUBDIVISION PURSUANT TO SECTION 76-3-207(1)(b), M.C.A.

Karen Whitney Nesbitt March 28, 2008  
KAREN WHITNEY NESBITT DATE

State of Montana  
County of Lincoln :ss

On this 28 day of March, 2008, before me, the undersigned, a Notary Public for the State aforesaid, personally appeared Karen Whitney Nesbitt, known to me to be the person whose name is subscribed to the foregoing instrument and acknowledged to me that she executed the same. IN WITNESS WHEREOF, I have hereunto set my hand and affixed my Notarial Seal the day and year first above written.

Christine L. Stevens  
Notary Public for the State of Montana  
Residing at Eureka  
My Commission expires May 12, 2011



Certificate of Surveyor  
Jay J. Squire  
JAY J. SQUIRE, PLS  
Registration No. 17282 LS  
Date: August 27, 2007

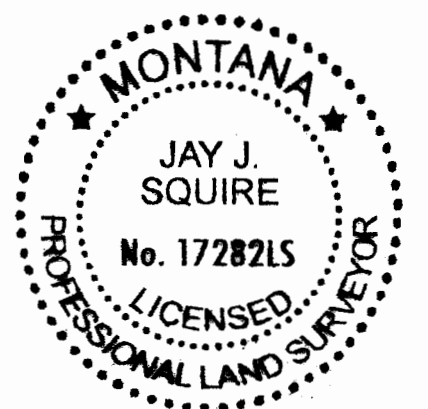

Approved: 11 Sept, 2007

Andrew Belski

Andrew Belski, Examining Land Surveyor

Registration No. 14731 PLS

I hereby certify that all real property taxes and special assessments assessed and levied on the land to be divided have been paid.

dated the 29th day of April, 2008

Marcy Batten Sutton  
Treasurer, Lincoln County, Montana



STATE OF MONTANA

County of Lincoln

Filed on the 29th day of April, 2008, A.D.,

at 12:30 o'clock P.M.

Sammy D. Lauer

County Clerk and Recorder

By: Grannie Lauer  
Deputy

Instrument No. 210966

SHEET 2 of 2

CERTIFICATE OF SURVEY NO. 3822 FC

Doc 210966

JOB NO. 6027

JAY J. SQUIRE, PLS  
PO BOX 1537  
EUREKA, MT. 59917  
406-889-5861

Traverse PC

Drainfield Eas 341/494  
Doc #232752

Sanitary Restriction Removed p.F. # 9485 Doc 210967