

# CERTIFICATE OF SURVEY

"FAMILY TRANSFER"

N 1/2 SE1/4 SE1/4, SECTION 11, T.36N., R.27W., P.M., MT.  
LINCOLN COUNTY, MONTANA

FOR: RALPH MITCHELL      DATE: MAY 2006

### LEGAL DESCRIPTION, REMAINDER

An irregular tract of land, lying northeasterly from Eureka, Montana, Lincoln County and in the N1/2 SE1/4 SE 1/4, Section 11, T. 36N., R. 27W., P.M., MT., containing 12.903 acres and more particularly described as follows:  
Commencing at the east one-quarter corner, Section 11, T. 36N., R. 27W., P.M., MT., a 2 1/4 inch diameter iron pipe;  
Thence S00°13'22"W, 1323.44 feet to the south one-sixteenth corner, a 5/8 inch diameter rebar with plastic cap marked 7322LS;  
Thence S89°41'10"W, 688.38 feet to a 5/8 inch diameter uncapped rebar and the TRUE POINT OF BEGINNING, REMAINDER;  
Thence continuing S89°41'10"W, 392.57 feet to a 5/8 inch diameter rebar with plastic cap marked 7322LS and the northeast corner, Parcel "A";  
Thence S00°10'55"W, 189.59 feet to a 5/8 inch diameter rebar with plastic cap marked 7322LS and the southeast corner, Parcel "A";  
Thence S89°41'10"W, 229.77 feet to a 5/8 inch diameter rebar with plastic cap marked 7322LS and the southwest corner, Parcel "A";  
Thence S00°10'55"W, 471.10 feet to the CSSE 1/64th corner, a 5/8 inch diameter rebar with plastic cap marked 2989ES;  
Thence N89°44'31"E, 655.08 feet to the SESE 1/64th corner, a 5/8 inch diameter rebar with plastic cap marked 2989ES;  
Thence N89°43'18"E, 625.35 feet to a 5/8 inch diameter rebar with plastic cap marked 2989ES lying along the westerly right-of-way limits of a 60 foot wide county road known as "Mill Springs Road";  
Thence along said right-of-way limits N00°09'07"E, 81.68 feet to a 5/8 inch diameter rebar with plastic cap marked 4975S;  
Thence leaving said right-of-way limits N80°59'34"W, 170.36 feet to a 5/8 inch diameter uncapped rebar;  
Thence N48°47'19"W, 190.38 feet to a 5/8 inch diameter uncapped rebar;  
Thence N40°54'37"W, 191.27 feet to a 5/8 inch diameter uncapped rebar;  
Thence N38°06'40"W, 355.58 feet to a 5/8 inch diameter uncapped rebar and the TRUE POINT OF BEGINNING, REMAINDER, containing 12.903 acres.  
Subject To and together with all appurtenant easements of record.

### LEGAL DESCRIPTION, PARCEL "A"

An irregular tract of land, lying northeasterly from Eureka, Montana, Lincoln County and in the N1/2 SE1/4 SE 1/4, Section 11, T. 36N., R. 27W., P.M., MT., containing 1.000 acres and more particularly described as follows:  
Commencing at the southeast one-sixteenth corner, Section 11, T. 36N., R. 27W., P.M., MT., a 2 1/4 inch diameter iron pipe and the TRUE POINT OF BEGINNING, Parcel "A";  
Thence S00°10'55"W, 189.59 feet to a 5/8 inch diameter rebar with plastic cap marked 7322LS;  
Thence N89°41'10"E, 229.77 feet to a 5/8 inch diameter rebar with plastic cap marked 7322LS;  
Thence N00°10'55"E, 189.59 feet to a 5/8 inch diameter rebar with plastic cap marked 7322LS;  
Thence S89°41'10"W, 229.77 feet to a 2 1/4 inch diameter iron pipe and the TRUE POINT OF BEGINNING, PARCEL "A", containing 1.000 acres.

Subject To and together with all appurtenant easements of record.

### PURPOSE OF SURVEY AND OWNER'S EXEMPTION

I, Ralph W. Mitchell, owner of record, hereby certify that the purpose of this survey and division of land is to transfer Parcel "A", 1.000 acres as shown hereon, to my son, Robby Mitchell; that this is the first and single gift or sale in this county to this member of our immediate family and the owner of record certification of compliance that the parcel will not be transferred back to the grantor within 24 months of filing without written consent of the governing body. Therefore this parcel is exempt from review as a subdivision pursuant to Section 76-3-207(1)(b), M.C.A.

Ralph W. Mitchell      4-11-07  
Ralph W. Mitchell      Date

### ACKNOWLEDGMENT

The foregoing Exemption was subscribed and acknowledged before me a Notary Public for the State of Montana

County of Lincoln, by the above named person(s), on this 11 day of April, 2007. In witness whereof, I have hereunto set my hand and affixed my notarial seal.

Carol Schreiber, Notary Public for the State of Montana  
residing in: Lincoln      My Commission expires: 08/14/10

### HISTORY OF SURVEY

1973 - Plat No. 2030, Section Subdivision, R. S. Custer, 3325S  
1975 - COS No. 113, Occasional Sale, R. A. Davis, 4122S  
1980 - COS No. 821, Occasional Sale, D. K. Marquardt, 2989ES  
1980 - COS No. 802, Retracement Survey, D. K. Marquardt, 2989ES  
1990 - COS No. 1795, Boundary line adjustment, K. E. Davis, 4975S

### METHOD OF SURVEY

A total station and data collector was used with closed traverse procedures to tie the previously set controlling corners by Mike Tester, February 2006.

### BASIS OF BEARING

The Basis of Bearing for this survey is N00°13'22"E between the southeast corner, Section 11, a found 2 1/2 inch diameter iron pipe and the East one-quarter corner, Section 11, a found railroad spike in the pavement set by Ninneman 534ES, as shown on Plat No. 2030

### LAND SURVEYOR'S CERTIFICATION

I hereby certify that I am a Registered Land Surveyor in the State of Montana, that the survey shown on this Certificate of Survey has been prepared under my supervision and in accordance with the Montana Code Annotated, Sections 76-3-101 through 76-3-625, and the Lincoln County regulations adopted pursuant thereto.

Alvah F. Hughes, PLS, 7322LS, 05-19-2006  
Alvah F. Hughes, PLS, 7322LS      Date

### EXAMINING LAND SURVEYOR'S CERTIFICATION

Approved this 26 day of July, 2006, A.D.

14731 PLS  
Examining Land Surveyor

### COUNTY TREASURER'S CERTIFICATION

I hereby certify, pursuant to Section 76-3-207(3), MCA, that all real property taxes and special assessments assessed and levied on the parcel shown hereon are paid.

Nancy Trotter Sutton      5/16/07  
Lincoln County Treasurer, Lincoln County, Montana      Date

### CLERK AND RECORDER'S CERTIFICATION

State of Montana, County of Lincoln, filed this 16<sup>th</sup> day

of July, 2007, A.D. at 11:05 o'clock A.M.  
Tommy D. Sam by Janice Sam  
Lincoln County Clerk & Recorder      Deputy

CERTIFICATE OF SURVEY NO. 3674 FC

PLAT NO. 2030

COS NO. 2030

COS NO. 802

DETAIL "A"

N88°24'29"E

N39°23'20"W

No Scale

PLAT NO. 2030  
COS NO. 802  
COS NO. 821

(S00°39'01"W - 661.32')  
S00°10'55"W - 660.69' Total

TRUE POINT OF BEGINNING, PARCEL "A"

PARCEL "A"  
1.000 Acres

N 1/2 SE1/4 SE1/4  
REMAINDER  
12.903 Acres

TRUE POINT OF BEGINNING, REMAINDER

PLAT NO. 2030  
COS NO. 802

COS NO. 113

COS NO. 1795

### LEGEND

- FOUND SECTION CORNER, ACCEPTED RAILROAD SPIKE IN PAVEMENT
- FOUND ONE-QUARTER CORNER, A 2 1/4 INCH DIAMETER IRON PIPE
- SET 5/8 INCH DIAMETER REBAR WITH PLASTIC CAP MARKED 7322LS
- FOUND 5/8 INCH DIAMETER REBAR WITH A PLASTIC CAP MARKED KED 4975S
- FOUND 5/8 INCH DIAMETER REBAR WITH A PLASTIC CAP MARKED DAVIS 4122S
- FOUND 2 1/4 INCH DIAMETER IRON PIPE
- FOUND 5/8 INCH DIAMETER REBAR WITH PLASTIC CAP MARKED 2989ES
- FOUND 5/8 INCH DIAMETER UNCAPPED REBAR
- UNMARKED COMPUTED POINT

- COS NO. 821
- COS NO. 802
- (( )) RECORD PLAT NO. 2030
- [ ] RECORD COS NO. 1795
- ( ) RECORD COS NO. 113
- { } RECORD COS NO. 802

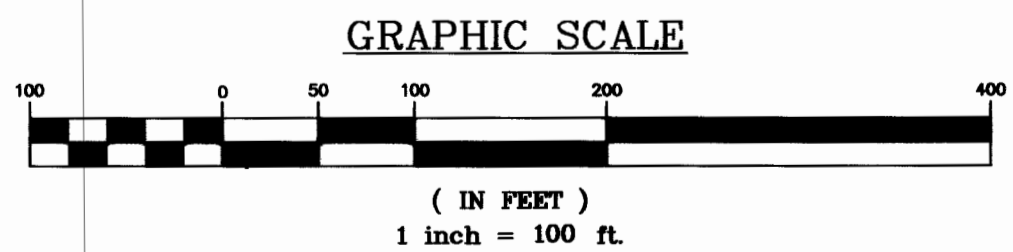

### VICINITY MAP

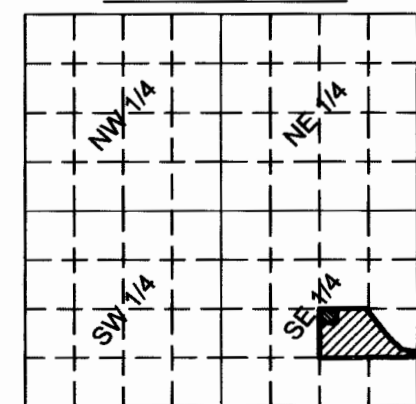

SECTION 11



*Sanitary Restrictions Removed P.F. # 9003 Doc # 202962  
Land owner Statement P.F. # 9004 Doc # 202962*

Doc # 202969

