

CERTIFICATE OF SURVEY

" RETRACEMENT "

SECTION 31, T.33 N., R.31 W., P.M., MT.

LINCOLN COUNTY, MONTANA

FOR: PLUM CREEK TIMBER Co.

DATE: OCTOBER 2006

PURPOSE OF SURVEY

The purpose is the retracement of a record parcel of land; remonumentation of original corners, and mark and post property boundaries. Therefore, no division of land is hereby created and is exempt from review as a subdivision.

HISTORY OF SURVEY

1904, GLO Survey of Township Boundary, G. Fessenden and R. Lyman

1904, GLO Township Subdivisions, G. Fessenden and R. Lyman

1976, BLM Remonumentation, J. French

METHOD OF SURVEY

A total station and data collector was used with closed traverse procedures to tie the previously set controlling corners by Mike Tester, September, 2006.

BASIS OF BEARING

The basis of bearing for this survey is N00°05'00"W, between the Southeast Section corner and the East one-quarter corner, Section 31, a 3 1/4 inch diameter BLM brass capped monument and a found original stone monument.

SURVEYORS NOTE

Refer to Certified Corner Recordations filed with the Lincoln County Clerk and Recorder's office for specific corner remonumentation information. All corners have been maintained and/or remonumented with aluminum capped monuments.

LAND SURVEYOR'S CERTIFICATION

I hereby certify that I am a Registered Land Surveyor in the State of Montana, that the survey shown on this Certificate of Survey has been prepared under my supervision and in accordance with the Montana Code Annotated, Sections 76-3-101 through 76-3-625, and the Lincoln County Regulations adopted pursuant thereto.

Alvah F. Hughes, PLS, 7322LS

March 31, 2007

Date

EXAMINING LAND SURVEYOR'S CERTIFICATION

Approved this 22 day of March 2007 A.D.

Examining Land Surveyor 14751 PLS

CLERK AND RECORDER'S CERTIFICATION

State of Montana, County of Lincoln, filed this 5th day

of April 2007 A.D. at 9:20 o'clock

County Clerk Recorder by Deputy

CERTIFICATE OF SURVEY No. 3653 Doc. 202025

NATIONAL FOREST SYSTEM LANDS

(N 89° 48' W - 40.00 Chs./2640.00')

(N 89° 48' W - 40.30 chs./2659.80')

S 89° 29' 45" E - 2670.42'

S 89° 48' 22" W - 2645.51'

NW 1/4

NE 1/4

S31

PLUM CREEK TIMBER COMPANY

LEGEND

- SECTION CORNER, FOUND IRON PIPE WITH 3 1/4 INCH DIAMETER BLM BRASS CAP
- ONE QUARTER/SECTION CORNER, FOUND ORIGINAL GLO STONE MONUMENT, SET 2 1/2 INCH DIAMETER ALUMINUM PIPE WITH 3 1/4 INCH DIAMETER, ALUMINUM CAP MARKED HUGHES 7322LS

() RECORD PER 1904 GENERAL LAND OFFICE SURVEY

----- PROJECTED SECTION SUBDIVISION LINE

----- PROPERTY LINE MARKED AND POSTED THIS SURVEY

----- EXTERIOR SECTION LINE

NFSL NATIONAL FOREST SYSTEM LANDS

SE 1/4

VICINITY DIAGRAM

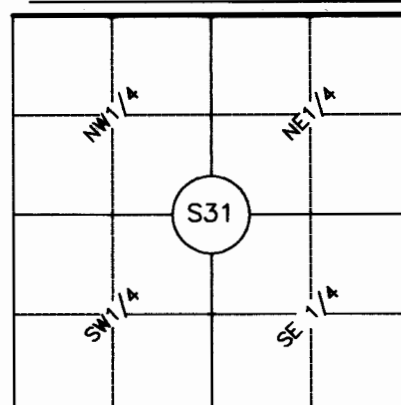

GRAPHIC SCALE



(IN FEET)
1 inch = 400 ft.

