

# CERTIFICATE OF SURVEY

DEPENDENT RESURVEY

N1/2, SECTION 25, T.29 N., R.30 W., P.M., MT.

LINCOLN COUNTY, MONTANA

FOR: PLUM CREEK TIMBER Co.

DATE: AUGUST 2006

NATIONAL FOREST SYSTEM LANDS

S23  
S24  
S25  
S26

(S89° 53' W)  
S89°49'30"W  
(40.00 chs.=2640.00')  
2660.42'

S24  
S25

BASIS OF BEARING  
(S 89°53'W) (40.00 Chs.=2640.00')  
S89°53'00"W 2629.60'

S24  
S25  
S19  
S30

T.29N. R.30W.  
T.29N. R.29W.

S25

PLUM CREEK TIMBER COMPANY

## LEGEND



SECTION CORNER, FOUND IRON PIPE WITH 3 1/4 INCH DIAMETER BLM BRASS CAP



1/4 CORNER, FOUND IRON PIPE WITH 3 1/4 INCH DIAMETER BLM BRASS CAP



SET 2 1/4 INCH DIAMETER ALUMINUM PIPE WITH 3 1/4 INCH DIAMETER, ALUMINUM CAP MARKED HUGHES 7322LS

( )

RECORD PER 1898 GENERAL LAND OFFICE

-----

SECTION SUBDIVISION LINE

=====

PROPERTY LINE MARKED AND POSTED THIS SURVEY

=====

EXTERIOR SECTION LINE

NFSL

NATIONAL FOREST SYSTEM LANDS

## VICINITY DIAGRAM

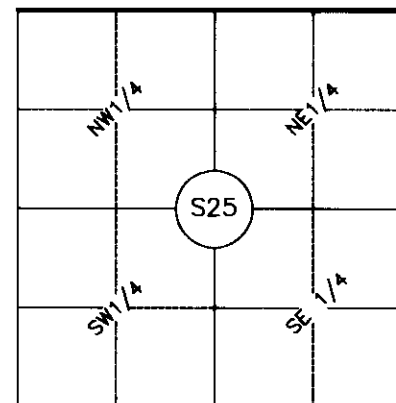

## GRAPHIC SCALE



( IN FEET )  
1 inch = 400 ft.

## PURPOSE OF SURVEY

The purpose is the resurvey of record parcels of land; establish corners, and mark property boundaries. Therefore no division of land is hereby created and is exempt from review as a subdivision.

## HISTORY OF SURVEY

1894, GLO Survey of Township Boundary, Daniel Mumbrue

1903, GLO Survey of Township Subdivision, Paul S. A. Bickel

1964, BLM Remonumentation of Corners, Gerald F. Pittman et al

1966, BLM Remonumentation of Corners, Woodrow E. Damm et al

## METHOD OF SURVEY

A total station and data collector was used with closed traverse procedures to tie the previously set controlling corners by Mike Tester, June, 2006.

## BASIS OF BEARING

The basis of bearing for this survey is S89°53'00"W, as shown in the 1903 General Land Office Notes; between the NE 1/4, found original Bearing Tree evidence and NE corner of Section 25, remonumented by a B.L.M. brass cap on iron pipe.

## LAND SURVEYOR'S CERTIFICATION

I hereby certify that I am a Registered Land Surveyor in the State of Montana, that the survey shown on this Certificate of Survey has been prepared under my supervision and in accordance with the Montana Code Annotated, Sections 76-3-101 through 76-3-625, and the Lincoln County Regulations adopted pursuant thereto.

Alvan F. Hughes, PLS, 7322LS

Date

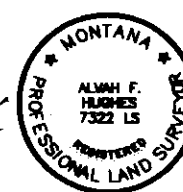

## EXAMINING LAND SURVEYOR'S CERTIFICATION

Approved this 28 day of August, 2006, A.D.

Examining Land Surveyor

14731 AS

## CLERK AND RECORDER'S CERTIFICATION

State of Montana, County of Lincoln, filed this 8<sup>th</sup> day

of September, 2006, A.D. at 2:25 o'clock pm.

Carol A. Cummings by Jeanne Dennis  
County Clerk Recorder Deputy

CERTIFICATE OF SURVEY No. 3587 Dec. 1974

