

# CERTIFICATE OF SURVEY

## RETRACEMENT

LOTS 1-5 OF BLOCK 8 IN SOUTH LIBBY  
IN THE NE1/4 NW1/4 SECTION 10, T. 30N., R. 31W., P.M., MT.  
LINCOLN COUNTY, MONTANA  
FOR: JIM BEASLY DATE: MAY 2005

### LEGAL DESCRIPTION OF LOTS 1-5

A regular townsite within Libby in Lincoln County, Montana, being Lots 1-5 in Block 8 of South Libby, lying wholly within the NW1/4 of Section 10, Twp. 30N., R. 31W., P.M., MT. containing ± 0.74 acres, subject to and together with all appurtenant easements of record.

### PURPOSE OF SURVEY

The purpose of this survey is the resurvey of a record parcel of land, Lots 1-5, Block 8 of the Original Townsite of Libby; the reestablishment of obliterated corners and marking property boundaries. Therefore no division of land is hereby created and is exempt from review as a subdivision, 76-3-404, MCA.

### METHOD OF SURVEY

A four second Nikon total station and HP data collector was used with closed traverse procedures to tie previously set controlling monuments.

### HISTORY OF SURVEY

1896 - Plot No. 7, "South Libby", A.L. Jacqueth

### BASIS OF BEARING

The Basis of Bearing for this survey is N65°02'40"W, along the centerline of Fifth Street, between found monuments as noted at the intersections of Main Avenue and Utah Avenue.

### LAND SURVEYOR'S CERTIFICATION

I hereby certify that I am a Registered Land Surveyor in the State of Montana, that the survey shown on this Certificate of Survey has been prepared under my supervision and in accordance with Montana Code Annotated, Sections 76-3-101 through 76-3-625 and the Lincoln County regulations adopted pursuant thereto.

*Alvah F. Hughes* 7322LS 05/30/05  
Alvah F. Hughes, Montana Reg. No. 7322LS Date

### EXAMINING LAND SURVEYOR'S CERTIFICATION

Approved this 26<sup>th</sup> day of May 2005

*Wendell W. Winters*  
Examining Land Surveyor

### CLERK AND RECORDER'S CERTIFICATION

State of Montana, County of Lincoln, filed this 10<sup>th</sup> day of June 2005, at 9:15 o'clock A.M.

*Coral M. Cummings* *Jeannie Dennis*  
County Clerk Recorder Deputy

CERTIFICATE OF SURVEY NO. 3418

Doc# 184796



### LEGEND

- FOUND 5/8 INCH DIAMETER REBAR
- UNMARKED COMPUTED POINT
- SET 5/8 INCH DIAMETER REBAR WITH A PLASTIC CAP STAMPED HUGHES 7322-LS
- FOUND PK NAIL
- ( ) RECORD PER SOUTH LIBBY PLAT NO. 7

### VICINITY DIAGRAM

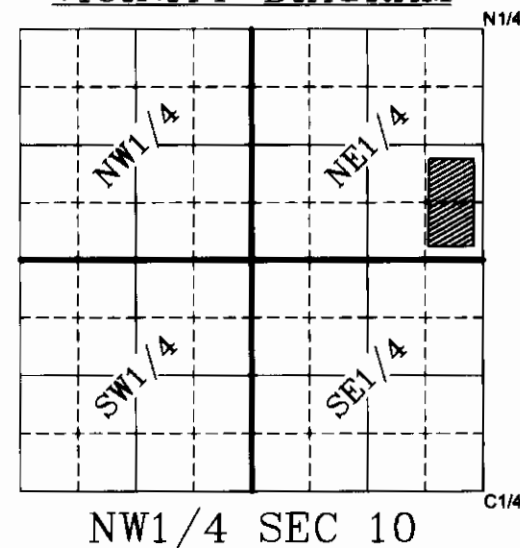

**KSI**  
KOOTENAI SURVEYORS INC.  
P.O. BOX 393  
LIBBY, MT 59923  
(406)293-4354

