

CERTIFICATE OF SURVEY

"BOUNDARY LINE ADJUSTMENT" NE 1/4 NW 1/4, SECTION 23, T.30N., R.31W., P.M., MT. LINCOLN COUNTY, MONTANA FOR: LARRY W. GRIMES DATE: APRIL 2005

LEGEND

- FOUND 5/8 INCH DIAMETER REBAR WITH A PLASTIC CAP MARKED HUGHES 7322LS
- FOUND 4X4 INCH SQUARE CONCRETE MDOT RIGHT-OF-WAY MONUMENT
- FOUND 3/4 INCH DIAMETER UNCAPPED IRON PIPE
- FOUND 5/8 INCH DIAMETER REBAR WITH A PLASTIC CAP MARKED MDL
- FOUND 1/2 INCH DIAMETER REBAR WITH A PLASTIC CAP MARKED JN
- FOUND 1/4 CORNER MONUMENT A 2 1/2 INCH IRON PIPE WITH A 3 1/4 INCH BLM BRASS CAP
- UNMARKED COMPUTED POINT
- { } RECORD PER FEDERAL AID PROJECT NO. F330(5) SHT. 4
- < > RECORD PER FEDERAL AID PROJECT NO. NRH 330-A
- () RECORD PER COS. NO. 231
- [] RECORD PER COS. NO. 1592
- BOUNDARY LINES THIS SURVEY
- OLD BOUNDARY LINE
- ADJOINING BOUNDARY LINES
- CURVE RADIAL OR TIE LINE
- CENTERLINE U.S. HIGHWAY NO. 2

LEGAL DESCRIPTION PARCEL "A"

An irregular tract of land, lying southeasterly from Libby, Montana, Lincoln County, in the NE 1/4 NW 1/4, Section 23, T.30N., R.31W., P.M., MT., containing ±5.683 acres, and more particularly described as follows:
Commencing at the North 1/4 corner, said Section 23, T.30N., R.31W., P.M., MT., a 2 1/2 inch iron pipe monument with a 3 1/4 inch BLM brass cap; Thence along the northerly section line said Section 23, S89°43'07"W, 124.96 feet to a 5/8 inch diameter rebar marked MDL and the True Point of Beginning;
Thence S00°36'42"W, 447.80 feet, a 5/8 inch diameter rebar marked MDL; Thence continuing S00°36'42"W, 63.66 feet to a 5/8 inch diameter rebar with a plastic cap marked Hughes 7322LS; Thence along a line perpendicular to said highway centerline, S38°51'01"W, 160.01 feet intersecting a 90 foot offset line from MDOT Project F330(5) highway centerline, a 5/8 inch diameter rebar with plastic cap marked Hughes 7322LS; Thence along said line, N51°08'59"W, 450.89 feet to a 5/8 inch diameter rebar with plastic cap marked MDL; Thence along said line, N51°18'31"W, 73.62 feet to a 4 by 4 inch concrete right-of-way monument; Thence along said line through a curve to the right, having a radius of 2775.00 feet, through a delta angle of 2°55'54", an arc of length of 141.98 feet to a 1/2 inch diameter rebar marked JN; Thence N54°22'04"E, 366.90 feet to a 3/4 inch diameter iron pipe, lying on the northerly section line, said Section 23; Thence along said section line, N89°44'38"E, 324.36 feet to the True Point of Beginning, containing ±5.683 acres.
Subject to and together with all appurtenant easements of record.

LEGAL DESCRIPTION PARCEL "B"

An irregular tract of land, lying southeasterly from Libby, Montana, Lincoln County, in the NE 1/4 NW 1/4, Section 23, T.30N., R.31W., P.M., MT., containing ±0.180 acres, and more particularly described as follows:
Commencing at the North 1/4 corner, said Section 23, T.30N., R.31W., P.M., MT., a 2 1/2 inch iron pipe monument with a 3 1/4 inch BLM brass cap; Thence along the northerly section line, said Section 23, S89°43'07"W, 124.96 feet to a 5/8 inch diameter rebar marked MDL; Thence S00°36'42"W, 447.80 feet to a 5/8 inch diameter rebar marked MDL, and the True Point of Beginning;
Thence S00°36'42"W, 63.66 feet to a 5/8 inch diameter rebar with a plastic cap marked Hughes 7322LS; Thence S51°08'59"E, 159.08 feet to a 5/8 inch diameter rebar with a plastic cap marked Hughes 7322LS; Thence N00°36'42"E, 63.66 feet to a 5/8 inch diameter rebar with a plastic cap marked Hughes 7322LS; Thence N00°36'42"E, 548.21 feet to a 2 1/2 inch iron pipe monument with a 3 1/4 inch BLM brass cap, said North 1/4 corner, Section 23, T.30N., R.31W., P.M., MT.; Thence along said northerly section line, said Section 23, S89°43'07"W, 124.96 feet to a 5/8 inch diameter rebar marked MDL and the True Point of Beginning, containing ±0.180 acres.
Subject to and together with all appurtenant easements of record.

LEGAL DESCRIPTION PARCEL "B-1"

An irregular tract of land, lying southeasterly from Libby, Montana, Lincoln County, in the NE 1/4 NW 1/4, Section 23, T.30N., R.31W., P.M., MT., containing ±1.610 acres, and more particularly described as follows:
Commencing at the North 1/4 corner, Section 23, T.30N., R.31W., P.M., MT., a 2 1/2 inch iron pipe monument with a 3 1/4 inch BLM brass cap; Thence along the northerly section line, said Section 23, S89°43'07"W, 124.96 feet to a 5/8 inch diameter rebar marked MDL and the True Point of Beginning;
Thence S00°36'42"W, 447.80 feet to a 5/8 inch diameter rebar marked MDL; Thence S00°36'42"W, 63.66 feet to a 5/8 inch diameter rebar with a plastic cap marked Hughes 7322LS; Thence S51°08'59"E, 159.08 feet to a 5/8 inch diameter rebar with a plastic cap marked Hughes 7322LS; Thence N00°36'42"E, 63.66 feet to a 5/8 inch diameter rebar with a plastic cap marked Hughes 7322LS; Thence N00°36'42"E, 548.21 feet to a 2 1/2 inch iron pipe monument with a 3 1/4 inch BLM brass cap, said North 1/4 corner, Section 23, T.30N., R.31W., P.M., MT.; Thence along said northerly section line, said Section 23, S89°43'07"W, 124.96 feet to a 5/8 inch diameter rebar marked MDL and the True Point of Beginning, containing ±1.610 acres.
Subject to and together with all appurtenant easements of record.

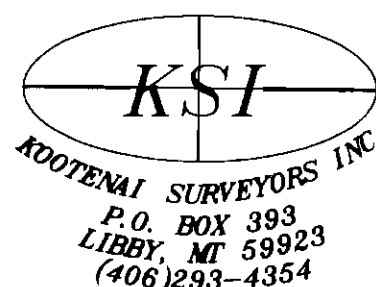

VICINITY DIAGRAM

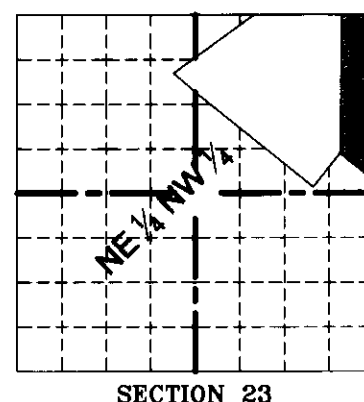

SECTION 23

GRAPHIC SCALE

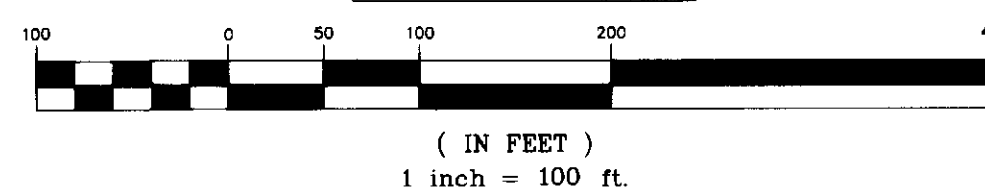

PURPOSE OF SURVEY AND OWNER'S EXEMPTION CERTIFICATION

We, Larry W. Grimes, Diane J. Grimes, and Robert F. Gruber record owners, hereby certify that the purpose of this survey and division of land is a relocation of common boundaries and therefore is exempt from subdivision review pursuant to MCA 73-3-207(1)(a): "divisions made outside of a platted subdivision for the purpose of relocating common boundary lines between adjoining properties". We further certify that Parcel "B" is exempt from review by the Department of Environmental Quality pursuant to ARM 17.36.605, Exclusions 2(a): "a parcel that has no existing facilities for water supply, wastewater disposal, and solid waste disposal, if no new facilities will be constructed on the parcel."

Larry W. Grimes 4-26-05
Diane J. Grimes 4-26-05
Robert F. Gruber 4-26-05

ACKNOWLEDGMENT

The foregoing Certifications were subscribed and acknowledged before me, a Notary Public for the State of Montana, County of Lincoln, by the above named person(s), on this 26th day of April, 2005. In witness whereof, I have hereunto set my hand and affixed my notarial seal.
Jenni Annis Notary Public for the State of Montana
residing in: Libby My Commission expires: 6-8-08

HISTORY OF SURVEY

1934 - Federal Aid Project No. NRH 330-A Sheet 1&2, Montana State Highway Commission
1971 - Federal Aid Project No. F330(5), Sheet 4 of 6, Montana State Highway Commission
1976 - COS No. 231, creates an irregular tract of land, southern boundary being the Highway R/W limits, Jack W. Ninneman, 534ES
1987 - COS No. 1592, divides tract into two parcels, a portion of southern boundary offset 50 feet north creating a gap of land, Melvin D. Louteren, 4232S
2004 - COS No. 3344RB, creates a boundary line adjustment, southern boundary being the Highway R/W limits, Alvah Hughes, 7322LS

METHOD OF SURVEY

A total station and data collector was used with closed traverse procedures to tie the previously set controlling corners, by Ken Kern, May 2004

BASIS OF BEARING

The basis of bearing for this survey is S89°43'07"W, as shown on COS No. 1592 between the N 1/4 corner, Section 23, a 2 1/2 inch diameter iron pipe with a 3 1/4 inch BLM brass cap and the Northeast corner of Parcel B, COS No. 1592, a 5/8 inch rebar with plastic cap marked MDL.

LINCOLN COUNTY TREASURER'S CERTIFICATION

I hereby certify, pursuant to Section 76-3-207(3), M.C.A., that all real property taxes and special assessments assessed and levied on the parcel shown herein are paid.
Dale A. Miller May 27 2005
Lincoln County Treasurer Date

LAND SURVEYOR'S CERTIFICATION

I hereby certify that I am a Registered Land Surveyor in the State of Montana, that the survey shown on this Certificate of Survey has been prepared under my supervision and in accordance with the Montana Code Annotated, Sections 76-3-101 through 76-3-625 and the Lincoln County regulations adopted pursuant thereto.
Alvah F. Hughes 04/25/05
Alvah F. Hughes Date

EXAMINING LAND SURVEYOR'S CERTIFICATION

Approved this 29th day of April, 2005, A.D.
Examining Land Surveyor

CLERK AND RECORDERS CERTIFICATION

State of Montana, County of Lincoln, filed this 27th day of May, 2005, A.D. at 3:30 o'clock P.M.
County Clerk Recorder Deputy

CERTIFICATE OF SURVEY NO. 3416 RB Dec 18748