

- ◆ SET 5/8 INCH DIA. REBAR WITH A PLASTIC CAP STAMPED K.E.D. 4975-S
- FOUND 5/8 INCH DIA. REBAR STAMPED JHN 4661-S
- FOUND 5/8 INCH DIA. REBAR STAMPED JRS 9958-LS
- △ FOUND 3 1/4 INCH DIA. ALUM. CAP STAMPED JRS 9958-LS AS NOTED
- COMPUTED POINTS
- ✦ FOUND MONUMENTS AS NOTED
- ✦ FOUND MONUMENTS AS NOTED
- () RECORD PER PLAT NO. 648
- [] RECORD PER PLAT NO. 697
- () RECORD PER BLM
- < > RECORD PER PLAT NO. 6091

There are deed restrictions pertaining to the original restrictive covenants on this property, the restricted zone, CMZ zone, and 200 foot set back from any stream, all of which have not been delineated on the ground or on this plat. It is the property owner's responsibility to hire qualified personal to establish these boundaries.

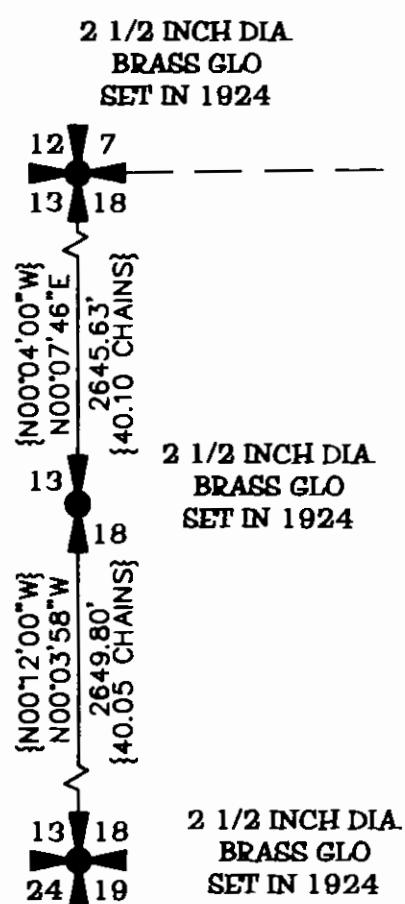
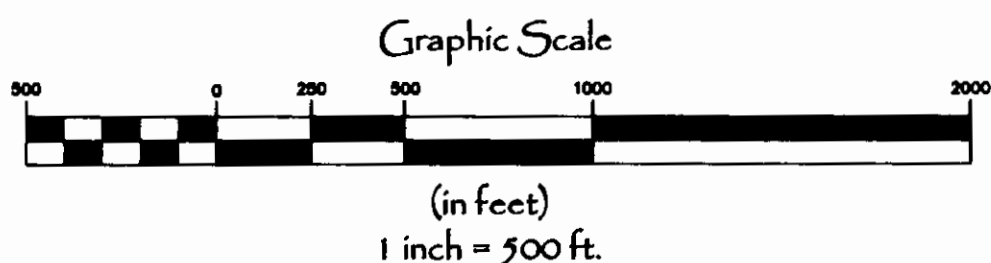

U.S.F.S.

2 1/2 INCH DIA
BRASS GLO
SET IN 1924

3 1/4 INCH DIA.
ALUM. U.S.F.S.

PARCEL A
450.67 ACRES±

CERTIFICATE OF SURVEY

PARCEL A
In Sections 6, 7, 8, 17, and 18 all of Twp. 29 N., R. 33 W., P.M.M.
For: Montana Mountain Valley L.L.C. Date: February 2004

DESCRIPTION OF PARCEL A

A tract of land near Troy in Lincoln County Montana, lying in the SE 1/4 of Section 6, the E 1/2 of Section 7, W 1/2 of Section 8, the NE 1/4 of Section 18, and the NW 1/4 NW 1/4 of Section 17, all of Twp. 29 N. R. 33 W., P.M.M., containing 450.67 acres more or less and more particularly described as follows:

Beginning at a 3 1/4 inch dia. alum. U.S.F.S. monument which marks the S 1/4 of Section 7 Twp. 29 N., R. 33 W., P.M.M.; thence, N00°12'17"W 2886.32 feet along the north south centerline of said Section 7, to a 5/8 inch dia. rebar capped K.E.D. 4975-S located on the south right of way line of the Asarco Haul Road, a 200 foot private easement; thence leaving said north south centerline, N50°58'03"E 988.99 feet along said south right of way line, to a 5/8 inch dia. rebar capped J.H.N. 4661-S; thence, continuing along said south right of way on the arc of a curve to the left a distance of 1173.23 feet, turning through a delta angle of 35°22'46", and having a radius of 1900.00 feet, to a 5/8 inch dia. rebar capped J.H.N. 4661-S; thence continuing along said south right of way, N15°35'17"E 652.78 feet to a 5/8 inch dia. rebar capped J.H.N. 4661-S; thence continuing along said south right of way, from said Section 7 to Section 6, on the arc of a curve to the left, a distance of 475.10 feet, turning through a delta angle of 34°01'35", and having a radius of 800.00 feet, to a 5/8 inch dia. rebar capped J.H.N. 4661-S; thence continuing along said south right of way, N18°26'18"W 342.07 feet to a 5/8 inch dia. rebar capped J.H.N. 4661-S; thence continuing along said south right of way, on the arc of a curve to the right, a distance of 46.95 feet, turning through a delta angle of 02°51'24", and having a radius of 941.74 feet, to a 5/8 inch dia. rebar capped K.E.D. 4975-S having a radial bearing of N74°25'06"E; thence leaving said south right of way, N37°31'33"E 154.44 feet to a 5/8 inch dia. rebar capped K.E.D. 4975-S; thence, N54°30'32"E 113.60 feet to a 5/8 inch dia. rebar capped K.E.D. 4975-S; thence, N54°40'22"E 127.79 feet to a 5/8 inch dia. rebar capped K.E.D. 4975-S; thence, N77°18'35"E 98.36 feet to a 5/8 inch dia. rebar capped K.E.D. 4975-S; thence, N86°33'02"E 131.16 feet to a 5/8 inch dia. rebar capped K.E.D. 4975-S; thence, S84°58'43"E 123.29 feet to a 5/8 inch dia. rebar capped K.E.D. 4975-S; thence, S86°10'06"E 134.74 feet to a 5/8 inch dia. rebar capped K.E.D. 4975-S; thence, N67°38'17"E 101.60 feet to a 5/8 inch dia. rebar capped K.E.D. 4975-S; thence, N59°38'34"E 144.41 feet to a 5/8 inch dia. rebar capped K.E.D. 4975-S; thence, N65°59'09"E 221.19 feet to a 5/8 inch dia. rebar capped K.E.D. 4975-S located on the east line of said Section 6; thence, S00°09'49"W 1097.06 feet along said east section line, to a 3 1/4 inch dia. brass BLM monument marking the southeast corner of said Section 6; thence leaving said Section 6, S00°12'17"E 1319.33 feet along the east line of said Section 7, to a 5/8 inch dia. rebar capped 9958-LS; thence leaving said east section line, N89°57'21"W 103.78 feet to a computed point located on the centerline of Lake Creek; thence, the following fifteen (15) courses through said Section 7 along said centerline of Lake Creek: S23°07'11"W 139.26 feet to a computed point; thence, S69°12'51"W 95.39 feet to a computed point; thence, S31°36'35"W 76.57 feet to a computed point; thence, S06°25'21"W 98.44 feet to a computed point; thence, S64°38'36"E 96.58 feet to a computed point; thence, S79°14'10"E 130.71 feet to a computed point; thence, S32°29'23"E 128.26 feet to a computed point; thence, S00°29'30"W 241.01 feet to a computed point; thence, S14°15'42"W 113.84 feet to a computed point; thence, S62°58'41"W 184.85 feet to a computed point; thence, S27°34'29"W 88.27 feet to a computed point; thence, S05°47'18"E 148.52 feet to a computed point; thence, S45°25'04"E 61.97 feet to a computed point; thence, S76°50'34"E 89.15 feet to a computed point; thence, N81°15'14"E 112.09 feet to a computed point located on the east line of said Section 7; thence continuing along said centerline of Lake Creek, the following twenty (20) courses through Section 8 Twp. 29 N., R. 33 W., P.M.M.: N81°15'14"E 248.45 feet to a computed point; thence, S38°24'50"E 118.38 feet to a computed point; thence, S17°55'13"E 92.57 feet to a computed point; thence, S64°49'15"W 130.34 feet to a computed point; thence, S44°01'50"W 98.43 feet to a computed point; thence, S09°41'01"W 106.17 feet to a computed point; thence, S35°21'04"E 121.91 feet to a computed point; thence, S75°42'58"E 109.55 feet to a computed point; thence, N84°13'26"E 220.40 feet to a computed point; thence, S67°22'04"E 156.79 feet to a computed point; thence, S31°05'28"E 416.50 feet to a computed point; thence, S23°40'10"E 180.23 feet to a computed point; thence, S32°23'28"E 184.95 feet to a computed point; thence, S25°18'00"E 194.47 feet to a computed point; thence, S05°28'57"E 40.90 feet to a computed point; thence, S05°28'57"E 178.68 feet to a computed point; thence, S07°12'55"W 252.49 feet to a computed point; thence, S21°16'34"E 186.96 feet to a computed point; thence, S09°57'36"W 109.03 feet to a computed point; thence, S55°03'47"W 154.83 feet to a computed point located at the mouth of Bull Lake; thence along approximate high waterline of the west bank of Bull Lake, the following sixteen (16) courses through Sections 8, 17, and 18 all of Twp. 29 N., R. 33 W.,; thence, N39°06'30"W 81.90 feet to a computed point; thence, S69°18'03"W 145.60 feet to a computed point; thence, S83°21'29"W 95.56 feet to a computed point; thence, S55°31'43"W 124.59 feet to a computed point; thence, S28°54'09"W 251.07 feet to a computed point; thence, S56°35'00"W 119.63 feet to a computed point; thence, S44°09'18"W 231.54 feet to a computed point; thence, S36°31'21"W 51.07 feet to a computed point; thence, S44°33'29"W 446.32 feet to a computed point; thence, S12°07'48"W 212.82 feet to a computed point; thence, S13°11'37"E 114.34 feet to a computed point; thence, S11°44'40"E 410.06 feet to a computed point; thence, S20°25'17"W 154.44 feet to a computed point; thence, S44°36'32"W 83.27 feet to a computed point; thence, S75°57'12"W 99.74 feet to a computed point; thence, S39°48'47"W 14.63 feet to a computed point; thence leaving said approximate high waterline, in said Section 18, S89°08'10"W 1120.39 feet to a 5/8 inch dia. rebar capped K.E.D. 4975-S; thence, S00°39'59"W 1320.95 feet to a 5/8 inch dia. rebar capped K.E.D. 4975-S located on the east west centerline of said Section 18; thence, S89°15'03"W 1320.00 feet to a 5/8 inch dia. rebar capped K.E.D. 4975-S marking the center 1/4 of said Section 18; thence, N00°23'51"E 2636.32 feet along the north south centerline of said Section 18 to the point of beginning.

The aforescribed Parcel A contains 450.67 acres more or less and is subject to and together with all appurtenant easements of record.

TREASURER CERTIFICATION

I hereby certify that all real property taxes and special assessments assessed and levied on the land to be divided have been paid. Dated this 17 day of March 2004 A.D.

Aeri A. Miller by Janice R. Liburke
Treasurer Lincoln County Deputy Montana

Davis Surveying Inc.
TROY MONTANA, (406)295-5441

DATE: 01/16/04
DRAWN BY: epr FILE: petar1.DWG

LINE TABLE		
LINE	LENGTH	BEARING
L1	154.44	N37°31'33"E
L2	113.60	N54°30'32"E
L3	127.79	N54°40'22"E
L4	98.36	N77°18'35"E
L5	131.16	N86°33'02"E
L6	123.29	S84°58'43"E
L7	134.74	S86°10'06"E
L8	101.60	N67°38'17"E
L9	144.41	N59°38'34"E
L10	221.19	N65°59'09"E
L11	103.78	N89°57'21"W
L12	139.26	S23°07'11"W
L13	95.39	S69°12'51"W
L14	76.57	S31°36'35"W
L15	98.44	S06°25'21"W
L16	96.58	S64°38'36"E
L17	130.71	S79°14'10"E
L18	128.26	S32°29'23"E
L19	241.01	S00°29'30"W
L20	113.84	S14°15'42"W
L21	184.85	S62°58'41"W
L22	88.27	S27°34'29"W
L23	148.52	S05°47'18"E
L24	61.97	S45°25'04"E
L25	89.15	S76°50'34"E
L26	112.09	N81°15'14"E
L27	248.45	N81°15'14"E
L28	118.38	S38°24'50"E
L29	92.57	S17°55'13"E
L30	130.34	S64°49'15"W
L31	98.43	S44°01'50"W
L32	106.17	S09°41'01"W
L33	121.91	S35°21'04"E
L34	109.55	S75°42'58"E
L35	220.40	N84°13'26"E
L36	156.79	S67°22'04"E
L37	416.50	S31°05'28"E
L38	180.23	S23°40'10"E
L39	184.95	S32°23'28"E
L40	194.47	S25°18'00"E
L41	40.90	S05°28'57"E
L42	178.68	S05°28'57"E
L43	252.49	S07°12'55"W
L44	186.96	S21°16'34"E
L45	109.03	S09°57'36"W
L46	154.83	S55°03'47"W
L47	81.90	N39°06'30"W
L48	145.60	S69°18'03"W
L49	95.56	S83°21'29"W
L50	124.59	S55°31'43"W
L51	251.07	S28°54'09"W
L52	119.63	S56°35'00"W
L53	231.54	S44°09'18"W
L54	51.07	S36°31'21"W
L55	446.32	S44°33'29"W
L56	212.82	S12°07'48"W
L57	114.34	S13°11'37"E
L58	410.06	S11°44'40"E
L59	154.44	S20°25'17"W
L60	83.27	S44°36'32"W
L61	99.74	S75°57'12"W
L62	14.63	S39°48'47"W

PURPOSE OF SURVEY/EXEMPTION

The purpose of this survey is to create a parcel of land larger than 160 acres, therefore this survey is exempt from review as a subdivision being completed pursuant to Section 76-3-103(15) & 76-3-401 M.C.A

CERTIFICATE OF SURVEYOR

STATE OF MONTANA
County of Lincoln

I, Kenneth E. Davis, a registered land surveyor do hereby certify that I have performed the survey shown on the attached C.O.S. or that such a survey was performed under my supervision to my best knowledge and ability; that said survey is true and complete as shown and the monuments found and set occupy the position shown hereon.

Dated this 17 day of February, 2004 A.D.
Kenneth E. Davis Registered Land Surveyor No. 4975-S

CERTIFICATION OF EXAMINING SURVEYOR:

Approved this 18 day of Feb. 2004 A.D.

Montana Examining Land Surveyor Registration No. 41305

STATE OF MONTANA
County of Lincoln

Filed on this 17 day of March 2004 A.D. at 1:45 O'clock p.m.

County Clerk and Recorder Deputy