

CERTIFICATE OF SURVEY: RETRACEMENT

OF THE EAST LINE OF SECTION 16

Twp. 30N., R. 33W., P.M.M.

For: State of Montana

Date: May 2001

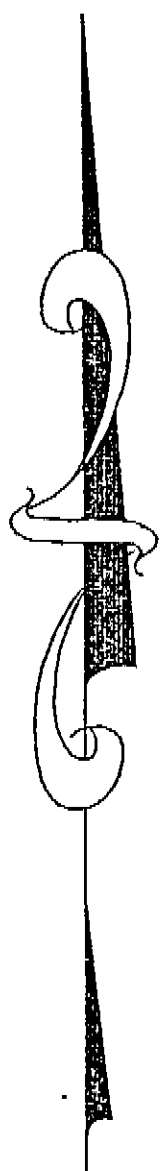

PURPOSE OF SURVEY/EXEMPTION

I/we hereby certify that the purpose of this survey is to retrace the east section line of Section 16 Twp. 30N., R. 33W., P.M.M. and that no new or additional parcels have been created. Therefore, this survey is exempt from review being completed pursuant to the Montana Subdivisions Act and Platting Act and the Montana Sanitation in Subdivisions Act.

William D. Caldwell
signature

Sec. 15
U.S.F.S. Land

Sec. 16
State Land

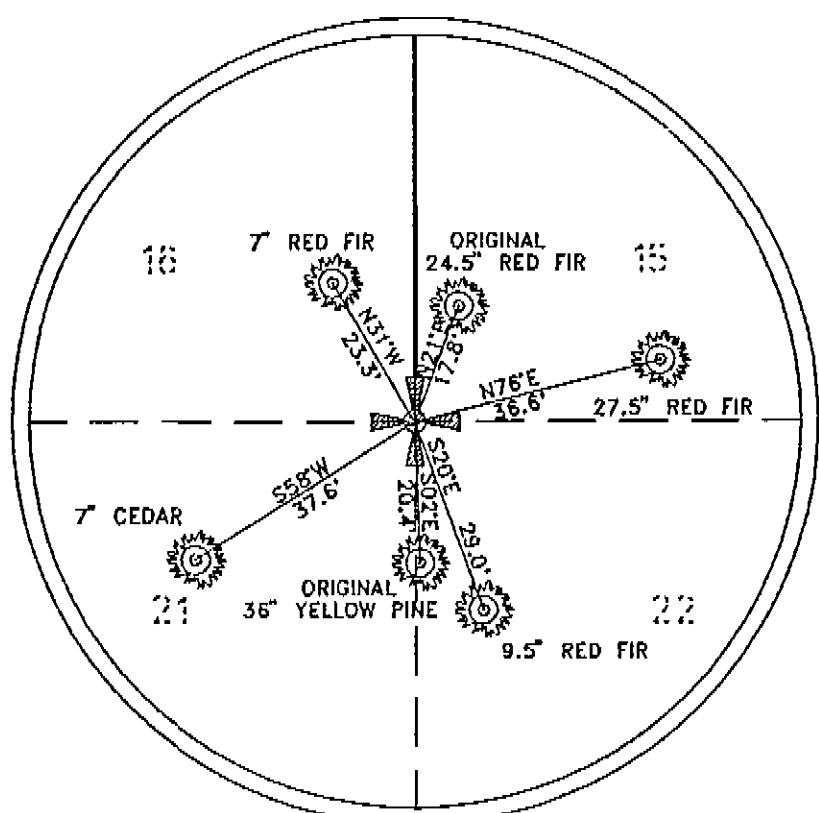
DETAIL A
NOT TO SCALE

LEGEND

SET 3 1/4 INCH DIAMETER ALUM.
MONUMENT STAMPED K.E.D. 4975-S

SET 3 1/4 INCH DIAMETER ALUM.
MONUMENT STAMPED K.E.D. 4975-S

FOUND 3 1/4 INCH DIAMETER ALUM.
MONUMENT STAMPED K.E.D. 4975-S

() BEARINGS AND DISTANCES PER
GLO RECORDS

POSTED AND MARKED LINE

STEEL POST

BEARING TREES AS NOTED

GRAPHIC SCALE



(IN FEET)
1 inch = 100 feet

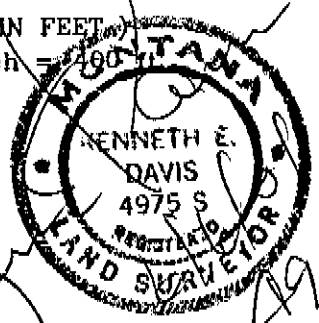

SEE DETAIL B FOR STEEL
POST LOCATIONS

5266.32'

BASIS OF BEARING
(N00°03'00"W)

N00°03'00"W
2633.16'

SEE DETAIL A FOR BEARING
TREE LOCATIONS

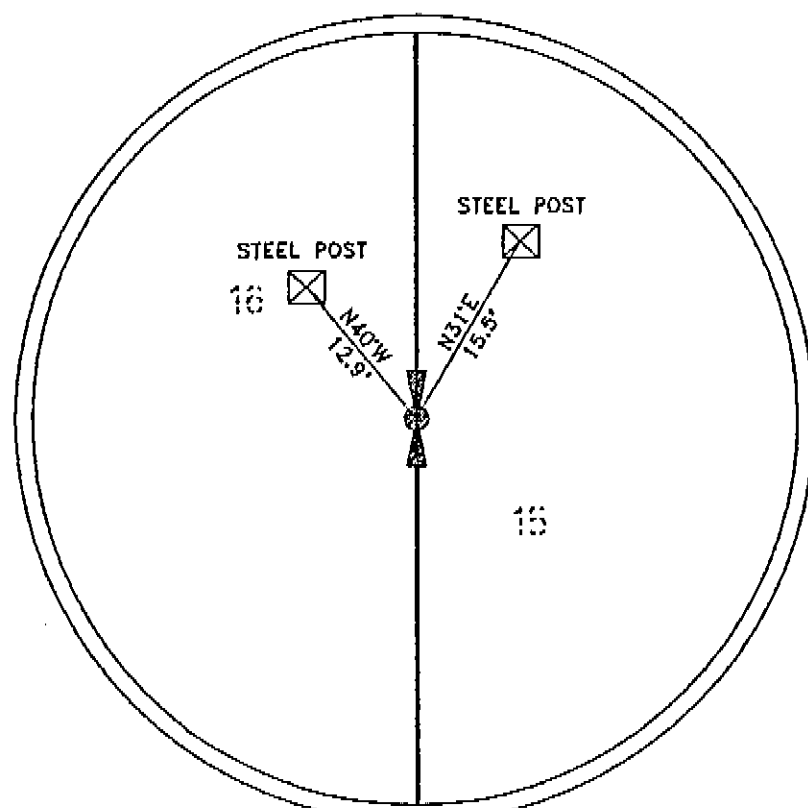
DETAIL B
NOT TO SCALE

CERTIFICATE OF SURVEYOR

STATE OF MONTANA
County of Lincoln

I Kenneth E. Davis, a registered land surveyor do hereby certify that I have performed the survey shown on the attached plat or that such a survey was performed under my supervision to my best knowledge and ability; that said survey is true and complete and the monuments set and found occupy the position as shown hereon.

Dated this 13th day of June, 2001 A.D.

Kenneth E. Davis and *4975-S*
Kenneth E. Davis Registered Land Surveyor No. 4975-S

EXAMINED AND APPROVED FOR LINCOLN COUNTY BY:

DATE: 6-13-01

STATE OF MONTANA
COUNTY OF LINCOLN

Filed on this 13th day of June, 2001 A.D. at 8:30
O'clock A.m.

Carol A. Cummings
County Clerk and Recorder

by *Francine Allen*
Deputy

CERTIFICATE OF SURVEY NO. 3027

Doc# 153266

DAVIS SURVEYING
(406)295-5441

DRAWN BY: CJR DATE: 05-18-01
File: george-taylorpeak.dwg