

FOR: SILVA
OWNER: "
PURPOSE: MORTGAGE
DATE: APRIL, 1998

Certificate of Survey

S 1/2, SEC. 32, T. 32N., R. 31 W., P.M., M., LINCOLN CO.

SCALE: 1" = 200'

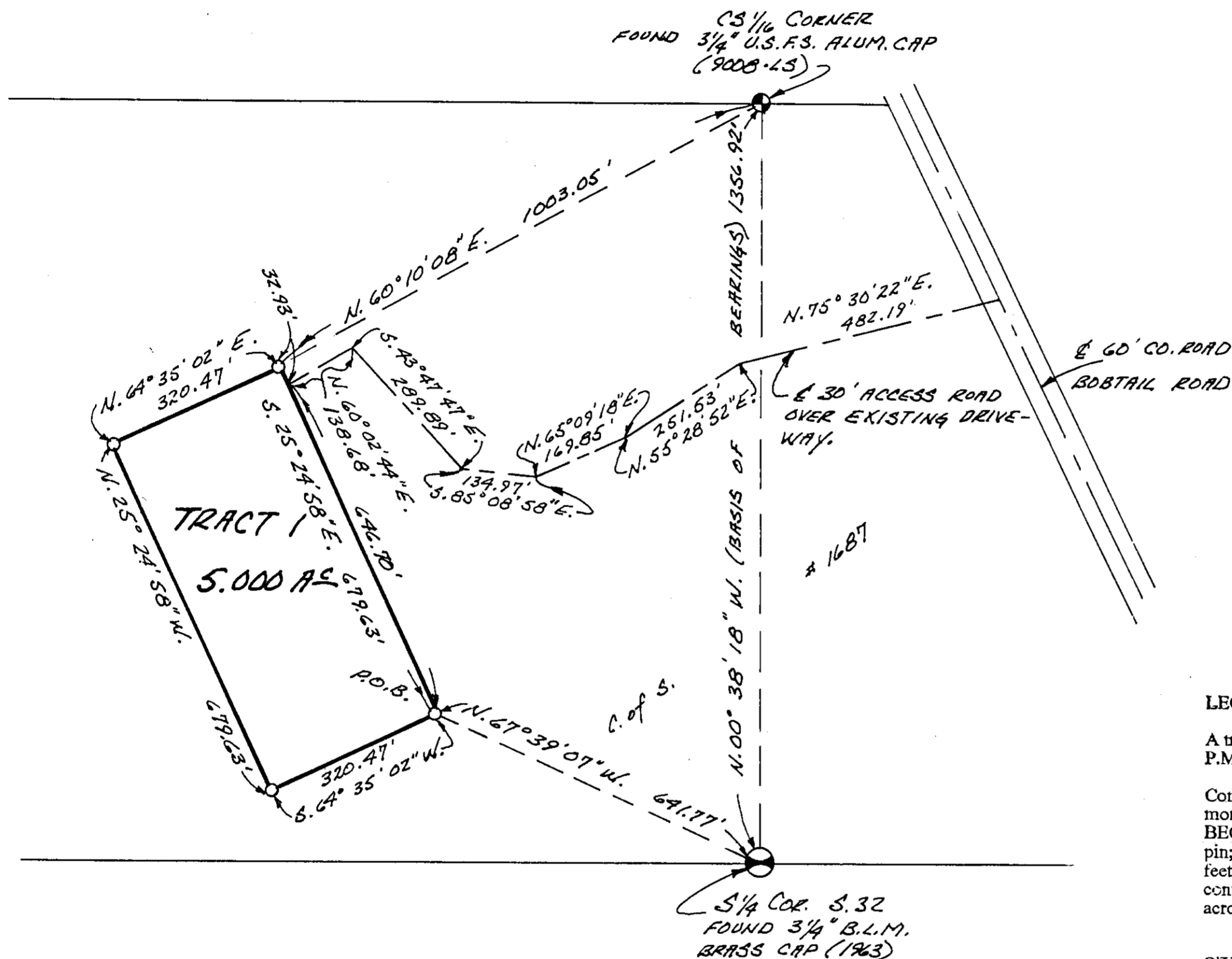
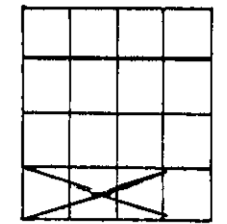

LEGAL DESCRIPTION

A tract of land in the South Half (S^{1/2}), Section 32, Township 32 North, Range 31 West P.M., M., Lincoln County, Montana, described as follows:

Commencing at the South One-Quarter corner of said Section 32, which is a found brass capped monument; thence, N. 67° 39' 07" West 641.77 feet to a set iron pin and the POINT OF BEGINNING of the tract herein described; thence, S. 64° 35' 02" W. 320.47 feet to a set iron pin; thence, N. 25° 24' 58" W. 679.63 feet to a set iron pin; thence, N. 64° 35' 02" E. 320.47 feet to a set iron pin; thence, S. 25° 24' 58" E. 679.63 feet to the POINT OF BEGINNING and containing 5.000 acres, more or less. Together with an 30 foot wide access easement over and across an existing driveway as shown hereon.

OWNER'S CERTIFICATION

We hereby certify that the purpose of this survey is a division to provide security for a mortgage and is exempt from review as a subdivision pursuant to Section 76-3-201 (2), MCA and is therefore also exempt from review by the Montana Dept. of Environmental Quality pursuant to Section 76-4-125 (2)(a), MCA.

Brandon C. Labelle Gilbert E. Mustard Jeannie J. Mustard
Brandon C. Labelle Gilbert E. Mustard Jeannie J. Mustard
Beverly M. Labelle Stanley Silva
Beverly M. Labelle Stanley Silva
Marty Silva

STATE OF MONTANA)
COUNTY OF LINCOLN) SS.

On this April day of 1998, before me a Notary Public for the State of Montana, personally appeared Brandon C. Labelle, Jeannie J. and Gilbert E. Mustard and Stanley and Marty Silva, and known by me to be the persons whose names are subscribed to the within instrument and acknowledged to me that they executed the same.
IN WITNESS WHEREOF, I have hereunto set my hand and affixed my official seal the day and year in this certificate first above written.

Notary Public Residing at Libby, Montana
My Commission expires 3-24-99

LEGEND

- ⊗ SEC. COR. (AS NOTED)
- ⊙ 1/4 COR. (AS NOTED)
- ⊙ CENTER SEC. COR. (A.N.)
- ⊙ 1/16 CORNER (A.N.)
- FOUND (AS NOTED)
- SET - 5/8" x 24" REBAR & CAP - "GOACHER - 7318-S"

Certificate of Surveyor

Richard G. Goacher
RICHARD G. GOACHER
MT. REGISTRATION No. 7318-S
X.G. 04/29/98

APPROVED _____, 19__

EXAMINING LAND SURVEYOR REG. No. _____
STATE OF MONTANA SS
COUNTY OF LINCOLN

FILED ON THE 29th DAY OF April 1998
AT 2:00 O'CLOCK P.M., PAID FEE _____

Cliff A. Pummig
CLERK & RECORDER

BY Jeannie J. Mustard
DEPUTY

INSTRUMENT REC. No. _____

SHEET 1 OF 1 SHEETS

Certificate of Survey No. 2659

STATE OF MONTANA)
County of Lincoln) SS.

On this 29th day of April, 1998, before me, a Notary Public for the State of Montana, personally appeared BEVERLY M. LABELLE, known to me to be the person whose name is subscribed to the within instrument as Guardian of BRANDON C. LABELLE and acknowledged to me that she subscribed the name of BRANDON C. LABELLE thereto and her own name as Guardian.

IN WITNESS WHEREOF, I have hereunto set my hand and affixed my Notarial Seal the day and year first above written.

(SEAL)

Joanna R. Libby
Notary Public for State of Montana
Residing at Libby, Montana
My commission expires 3-24-99

PREPARED BY:

GOACHER & ASSOCIATES
46-2ND AVENUE EAST
KALISPELL, MT. 59901-4567
Ph. (406) 752-5700
Fax (406) 752-5699