

KOOTENAI NATIONAL FOREST
LINCOLN COUNTY, MONTANA

PRIVATE LANDS

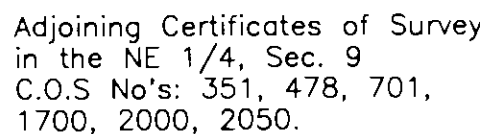

The purpose of this survey is to transfer a parcel of land in Lincoln County, Montana from the United States Forest Service to Lincoln County as per instructions of Senate Bill No. 528, P.L. 103-198 (108 Stat. 4162) dated October 22, 1994.

1893 Original Township subdivision by Daniel P. Mumbrue.
1962 B.L.M. Remonumentation of original corners by Gerald F. Pittman et al.
1974 B.L.M. Dependent Resurvey and Survey of Township by Shirley B. Hjellum and James S. Pritchard.

Control was accomplished using survey grade Global Positioning System receivers, and Least Squares adjusted around a first order control. Property lines were surveyed with total station theodolite – EDM traverse.

Global Positioning System



I hereby certify that I am a registered land surveyor in the State of Montana, that the survey shown on this Certificate of Survey has been prepared in accordance with Montana Code Annotated (Sections 76-3-101 through 76-3-614) and the Lincoln County regulations adopted pursuant thereto.

State of Montana, County of Lincoln, filed this 30th day
of November 1995, A.D. at 9:05 o'clock
Coral D. Cummings by Joanna Morris
County Clerk Recorder Deputy

CERTIFICATE OF SURVEY NO. 2398 SHEET 1 OF 2

- Corner monument set this survey. A 3/4" x 30" aluminum rod with 3 1/4" aluminum cap marked U.S.F.S. 7322LS, 1995.
- Corner monument found, a 2 1/2" dia. iron pipe with 3 1/4" brass cap maked B.L.M., 1974.
- ⊕ Section corner monument found, a 2 1/2" dia. iron pipe with 3 1/4" brass cap maked B.L.M., 1962.
- ⊙ 1/4 section corner monument found, a 2 1/2" dia. iron pipe with 3 1/4" brass cap maked B.L.M., 1962.

Section lines

Property boundary posted to U.S.F.S.
Region One, standards.

Minor subdivision lines

1893 G.L.O. record

1974 B.L.M. record

CERTIFICATE OF SURVEY
DEPENDENT RESURVEY AND SECTION SUBDIVISION
NW 1/4 OF SECTION 9, T.30N., R.31W., P.M.MT.
KOOTENAI NATIONAL FOREST
LINCOLN COUNTY, MONTANA

AUGUST 1995

LEGAL DESCRIPTION LINCOLN COUNTY LANDS

A tract of land lying in the Northwest 1/4 of Section 9, Township 30 North, Range 31 West, Principal Meridian, Montana, in the county of Lincoln, in the State of Montana, and more particularly described as: N1/2 NE1/4 NW1/4 & NE1/4 NW1/4 NW1/4, containing 30.28 acres.

REMAINDER:

LEGAL DESCRIPTION OF NATIONAL FOREST SYSTEM LANDS

A tract of land lying in the Northwest 1/4 of Section 9, Township 30 North, Range 31 West, Principal Meridian, Montana, in the county of Lincoln, in the State of Montana, and more particularly described as: NW1/4 NW1/4 NW1/4, SW1/4 NW1/4 NW1/4, SE1/4 NW1/4 NW1/4, S1/2 NE1/4 NW1/4, SW1/4 NW1/4 & SE1/4 NW1/4, containing 131.70 acres.

CERTIFICATES

I hereby certify that the purpose of this division of land is to create an aliquot tract from United States Forest Service land, located in Lincoln County, Montana and transfer to Lincoln County, State of Montana, as per instructions of Senate Bill No. 528, P.L. 103-398 (108 Stat. 4162) dated October 22, 1994, an act of the United States Congress. This Certificate of Survey is exempt from the State of Montana, Subdivision and Health Review Act, No. 76-4-1224.

Stephen J. Solem

Stephen J. Solem
Acting Forest Supervisor
Kootenai National Forest

9/5/95
Date

State of: Montana)
County of: Lincoln) ss.

On the 5th day of September, 1995 A.D., before me, a Notary Public in and for the State of Montana, personally appeared Stephen J. Solem, known to me to be the person whose name is subscribed to the within instrument and acknowledged to me that he executed the same.

In witness thereof, I have hereunto set my hand and affixed my official seal the day and year first above written.

Therese A. Luck

Notary Public for the State of Montana

Residing in Libby, Montana.
(Seal)

My Commission expires June 16, 1997

CERTIFICATES

I hereby certify that the purpose of this division of land is to create an aliquot tract from United States Forest Service land, located in Lincoln County, Montana and transfer to Lincoln County, State of Montana, as per instructions of Senate Bill No. 528, P.L. 103-398 (108 Stat. 4162) dated October 22, 1994, an act of the United States Congress. This Certificate of Survey is exempt from the State of Montana, Subdivision and Health Review Act, No. 76-4-1224.

Gerald R. Criner 11-27-95

Gerald R. Criner, Chairman
Lincoln County Commissioners

State of: Montana)
County of: Lincoln) ss.

On the 30th day of November, 1995 A.D., before me, a Notary Public in and for the State of Montana, personally appeared Gerald R. Criner, known to me to be the person whose name is subscribed to the within instrument and acknowledged to me that he executed the same.

In witness thereof, I have hereunto set my hand and affixed my official seal the day and year first above written.

Gianni Dennis

Notary Public for the State of Montana

Residing in Libby, Montana.
(Seal)

My Commission expires 4-25-1996