

CERTIFICATE OF SURVEY

DEPENDENT RESURVEY AND SECTION SUBDIVISION

SECTION 14 T.29N., R.31W., P.M.MT.

KOOTENAI NATIONAL FOREST

LINCOLN COUNTY, MONTANA

MAY 1993

FOREST SUPERVISOR'S CERTIFICATE

THIS SURVEY WAS MADE AT MY REQUEST FOR NATIONAL FOREST MANAGEMENT PURPOSES.

Robert L. Schrenk
ROBERT L. SCHRENK, FOREST SUPERVISOR

PURPOSE OF SURVEY:

THE PURPOSE OF THIS SURVEY IS TO LOCATE, UPON THE GROUND, THE TITLE LINES OF RECORD BETWEEN NATIONAL FOREST SYSTEM LANDS AND PRIVATE LANDS AND NO DIVISION OF LAND IS HEREBY CREATED.

HISTORY:

ORIGINAL, 1893 G.L.O. RECORD BY D. P. MUMBRUE
SURVEY NORTH LINE OF SEC., 1960 CHAMPION INTERNATIONAL CORP. RECORD BY R. BURDICK.
REMONUMENTATION, 1963 B.L.M. RECORD BY PITMAN ET AL.
CORNER RECORDATION, 1966 RECORD BY J. W. NINNEMAN, REG. #534ES.
C.O.S. No. 1367, 1984 RECORD BY T. C. HILL, REG. #5612S
C.O.S. No. 1375, 1985 RECORD BY T. C. HILL, REG. #5612S

LEGAL DESCRIPTION:

PRIVATE LANDS DEFINED HEREON - W1/2 NW1/4 NE1/4, SW1/4 NE1/4, W1/2 W1/2 E1/2 NW1/4 NE1/4, W1/2 W1/2 SE1/4 NE1/4, N1/2 NW1/4 SE1/4, W1/2 NW1/4 NE1/4 SE1/4, E1/2 W1/2 NE1/4 NW1/4, E1/2 NE1/4 NW1/4, E1/2 W1/2 SE1/4 NW1/4, E1/2 SE1/4 NW1/4. TOTAL ACREAGE: 158.1 ±

NATIONAL FOREST SYSTEM LANDS DEFINED HEREON - NE1/4 NE1/4, E1/2 W1/2 E1/2 NW1/4 NE1/4, E1/2 E1/2 NW1/4 NE1/4, E1/2 SE1/4 NE1/4, E1/2 W1/2 SE1/4 NE1/4, E1/2 NW1/4 NE1/4 SE1/4, NE1/4 NE1/4 SE1/4, S1/2 NE1/4 SE1/4, S1/2 NW1/4 SE1/4, SE1/4 SE1/4, SW1/4 SE1/4, SW1/4, W1/2 W1/2 NE1/4 NW1/4, W1/2 W1/2 SE1/4 NW1/4, SW1/4 NW1/4. TOTAL ACREAGE: 316.4 ±

SURVEY METHOD:

THEODOLITE - EDM TRAVERSE

BASIS OF BEARING:

RECORD BEARINGS OF C.O.S. No. 1367.

SURVEYOR'S CERTIFICATE:

I HEREBY CERTIFY THAT I AM A REGISTERED LAND SURVEYOR IN THE STATE OF MONTANA THAT THE SURVEY SHOWN ON THIS PLAT HAS BEEN PREPARED IN ACCORDANCE WITH THE MONTANA CODE ANNOTATED (SECTIONS 76-3-101 THROUGH 76-6-613) AND THE LINCOLN COUNTY REGULATIONS ADOPTED PURSUANT THERETO.

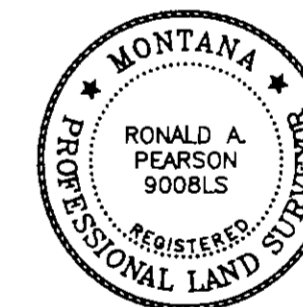

Ronald A. Pearson
RONALD A. PEARSON MONTANA REGISTRATION No. 9008LS

CERTIFICATE OF EXAMINING OFFICIAL:

APPROVED THIS 23rd DAY OF June 1993, A.D.

Dr. Williams
EXAMINING OFFICIAL

APPROVED _____
CHAIRMAN, LINCOLN COUNTY COMMISSIONERS

CERTIFICATE OF CLERK AND RECORDER:

STATE OF MONTANA, COUNTY OF LINCOLN, FILED THIS 25th DAY OF June 1993, A.D. AT 11:25 O'CLOCK
Carol D. Cumming BY *Jeanie Benson*
COUNTY CLERK RECORDER

CERTIFICATE OF SURVEY NO. 2085

